

FIRST SHEET
SHEET 1 OF 6 SHEETS

STRATA PLAN PGS 237 -

DEPOSITED AND REGISTERED IN THE LAND TITLE
OFFICE AT PRINCE GEORGE, B.C., THIS 17
DAY OF - April - 1997

REGISTRAR
Brien Bigras/OK
PL23206



SCALE = 1 : 500
ALL DISTANCES ARE IN METRES.
DIMENSIONS ARE TO WALL CENTRELINES

THIS PLAN SHOWS GROUND-LEVEL MEASURED DISTANCES.
PRIOR TO COMPUTATION OF UTM COORDINATES, MULTIPLY
BY COMBINED FACTOR 0.99951435.

GRID BEARINGS ARE DERIVED FROM OBSERVATIONS
BETWEEN CONTROL MONUMENTS 86H1577 AND 86H1596,
INTERFERED SURVEY AREA NUMBER 39, PRINCE GEORGE.

- LEGEND**
- STANDARD IRON POST FOUND
 - ⊙ CONTROL MONUMENT
 - ⊙ L.C.P. DENOTES LIMITED COMMON PROPERTY
 - ⊙ C.P. DENOTES COMMON PROPERTY
 - ⊙ S.L. DENOTES STRATA LOT
 - m² DENOTES SQUARE METRES

C.M.C. ADDRESS:
1301 & 1323 KELLIHER ROAD
PRINCE GEORGE, B.C.

THE ADDRESS FOR THE SERVICE OF DOCUMENTS
FOR THE STRATA CORPORATION IS:
EMERYO HOLDINGS LTD.
P.O. BOX 398
PRINCE GEORGE, B.C.
V2L 4S2

10
PLAN 25047
D.L. 18

KELLIHER ROAD

FOLEY CRESCENT

1511

L.C.P. FOR S.L. 1

S.L. 1

S.L. 2

L.C.P. FOR S.L. 2

S.L. 2

C.P.

PARCEL PLAN

PGP39666

FOLEY CRESCENT

THIS PLAN LIES WITHIN THE FRASER-
FORT GEORGE REGIONAL DISTRICT.

R. L. JOHNS LAND SURVEYING LTD.
LEGAL AND ENGINEERING SURVEYS
240 VICTORIA STREET
PRINCE GEORGE, B. C. V2L 2J4
PHONE: (604)562-5759
FAX: (604)562-5703

97-004 V4-B
W10-6

LTO 010906

STRATA PLAN OF
PARCEL 1, PLAN PGP39666
DISTRICT LOT 1511
CARIBOO DISTRICT.
B.C.G.S. 93G.097

STRATA PLAN PGS 237

STRATA LOT No.	SHEET No.	FORM 1 SCHEDULE OF UNIT ENTITLEMENT	FORM 2 SCHEDULE OF INTEREST UPON DESTRUCTION	FORM 3 VOTING RIGHTS
1	4 & 5	1035	543	543
2	4 & 5	775	407	407
AGGREGATE		1810	950	950

ACCEPTED AS FORMS 1, 2 & 3
THIS 14 DAY OF April 1997.

R. L. Johns
SUPERINTENDENT OF REAL ESTATE

STATUTORY DECLARATION
I, THE UNDERSIGNED, DO SO SOLEMNLY DECLARE THAT
(1) I, THE UNDERSIGNED AM THE OWNER DEVELOPER.
(2) THE STRATA PLAN IS ENTIRELY FOR COMMERCIAL USE.
I MAKE THIS SOLEMN DECLARATION CONSCIENTIOUSLY BELIEVING
IT TO BE TRUE AND KNOWING THAT IT IS THE SAME FORCE AND
EFFECT AS IF MADE UNDER OATH.

R. L. Johns
AUTHORIZED SIGNATORY (EMBRYO HOLDINGS LTD.)
F. Wolman
AUTHORIZED SIGNATORY (EMBRYO HOLDINGS LTD.)

FORM 13
NEW DEVELOPMENT CERTIFICATE
I, RONALD L. JOHNS, A BRITISH COLUMBIA LAND SURVEYOR,
HEREBY CERTIFY THAT THE BUILDING SHOWN IN
THIS STRATA PLAN CONSTITUTES A NEW DEVELOPMENT AND
PREVIOUSLY OCCUPIED.
DATED THIS 26TH DAY OF FEBRUARY, 1997.

R. L. Johns
R.L. JOHNS, B.C.L.S., C.L.S.

DECLARED BEFORE ME AT PRINCE GEORGE IN THE
PROVINCE OF BRITISH COLUMBIA
THIS 17 DAY OF March 1997.
A COMMISSIONER FOR TAKING AFFIDAVITS WITHIN THE
PROVINCE OF BRITISH COLUMBIA.

OWNER & DEVELOPER:
EMBRYO HOLDINGS LTD.
INC. NO. 520791

MORTGAGEE:
PRINCE GEORGE SAVINGS CREDIT UNION

MORTGAGEE:
PSCUB HOLDINGS LTD.

Allan M.D. Todd
AUTHORIZED SIGNATORY
Allan M.D. Todd
PRINT NAME

Ray Williams
AUTHORIZED SIGNATORY
RAY WILLIAMS
PRINT NAME

Frank J. Wolfinger
AUTHORIZED SIGNATORY
Frank J. Wolfinger
PRINT NAME

Otto Ruff
AUTHORIZED SIGNATORY
OTTO RUFF
PRINT NAME

Gene Cabel
AUTHORIZED SIGNATORY
Gene Cabel
PRINT NAME

Frank J. Wolfinger
AUTHORIZED SIGNATORY
Frank J. Wolfinger
PRINT NAME

Patrick J. Cotter
WITNESS (AS TO BOTH SIGNATURES)
PATRICK J. COTTER
PRINT NAME

John Irving
WITNESS (AS TO BOTH SIGNATURES)
JOHN IRVING
PRINT NAME

Ronald W. Marill
WITNESS (AS TO BOTH SIGNATURES)
RONALD W. MARILL
PRINT NAME

1033 - 3rd AVE
ADDRESS
PRINCE GEORGE, B.C.
PRINCE GEORGE
OCCUPATION

8987 W. Nechako Rd.
ADDRESS
Prince George
OCCUPATION

1033 - 3rd AVE
ADDRESS
PRINCE GEORGE, B.C.
PRINCE GEORGE
OCCUPATION

THIS 21ST DAY OF FEBRUARY, 1997.

R. L. Johns
R.L. JOHNS, B.C.L.S., C.L.S.

STRATA PLAN OF
PARCEL 1, PLAN PGP39666
DISTRICT LOT 1511
CARIBOO DISTRICT.

B.C.G.S. 93G-097



SCALE = 1 : 250 (METRES)

SHEET 3 OF 6 SHEETS

STRATA PLAN PGS 237 -

WEST ELEVATION
LOOKING EAST

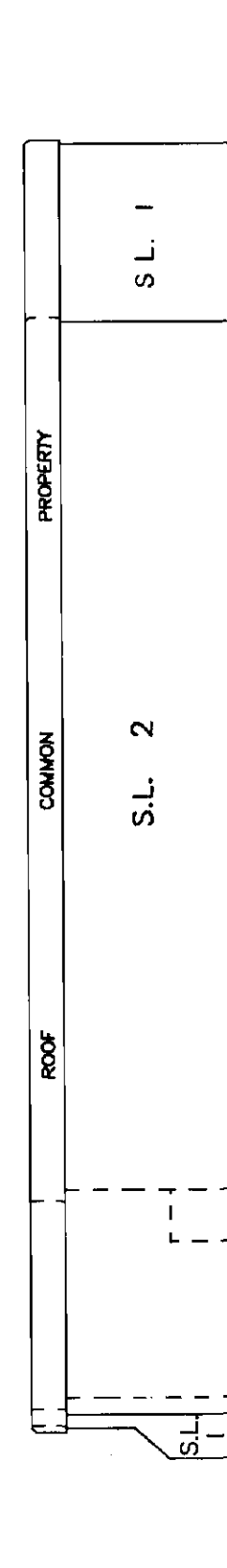

SOUTH ELEVATION
LOOKING NORTH

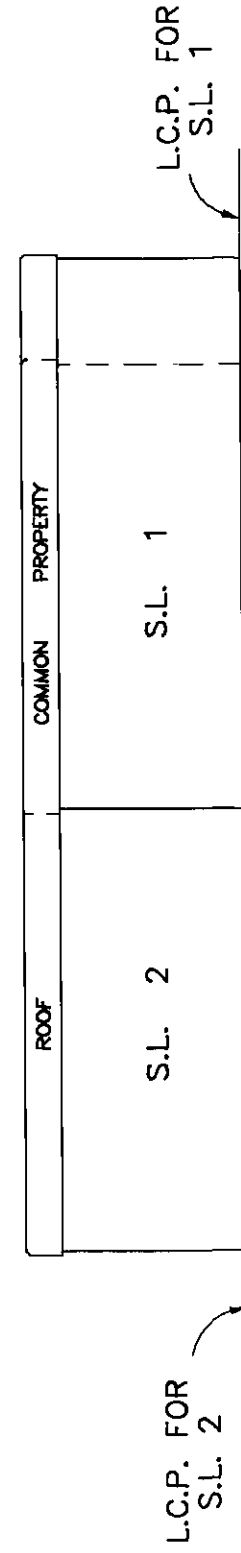

THIS 21ST DAY OF FEBRUARY, 1997.

R. John
R.L. JOHN, B.C.L.S., C.L.S.

97-004 V4-8
WTO-6

LTO 010906

STRATA PLAN OF
PARCEL 1, PLAN PGP39666
DISTRICT LOT 1511
CARIBOO DISTRICT.

B.C.G.S. 93G.097

SHEET 4 OF 6 SHEETS
STRATA PLAN PGS 237 -



SCALE = 1 : 500
ALL DISTANCES ARE IN METRES.
DIMENSIONS ARE TO WALL CENTRELINES

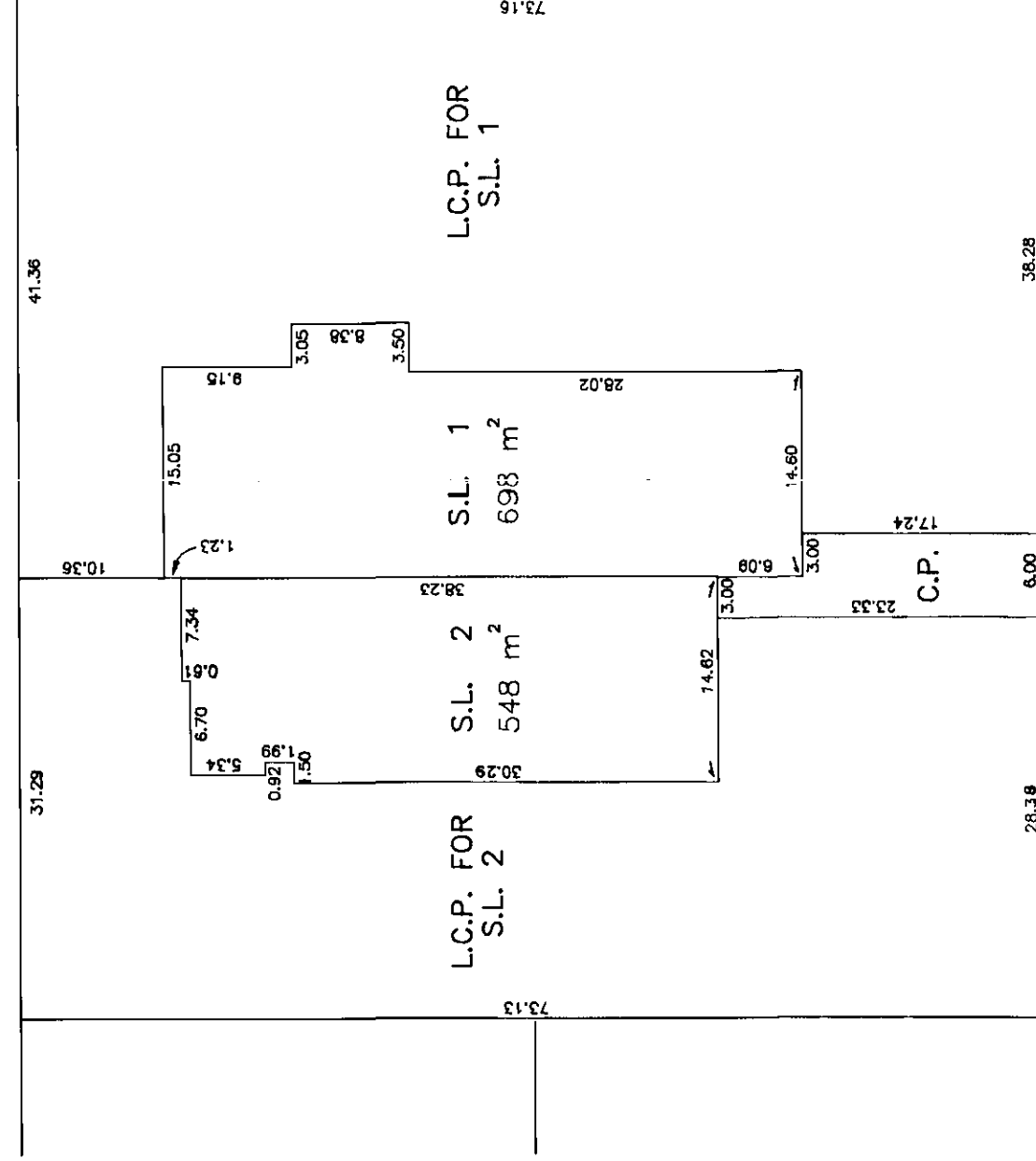
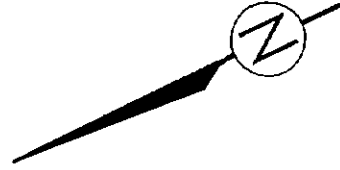

MAIN FLOOR

THIS 21ST DAY OF FEBRUARY, 1997.

R. L. Johns
R.L. JOHNS, B.C.L.S., C.L.S.

97-004 V4-8
W10-6

LTO 010906

STRATA PLAN OF
PARCEL 1, PLAN PGP39666
DISTRICT LOT 1511
CARIBOO DISTRICT.

B.C.G.S. 93G.097

SHEET 5 OF 6 SHEETS
STRATA PLAN PGS 237 -



SCALE = 1 : 500
ALL DISTANCES ARE IN METRES.
DIMENSIONS ARE TO WALL CENTRELINES

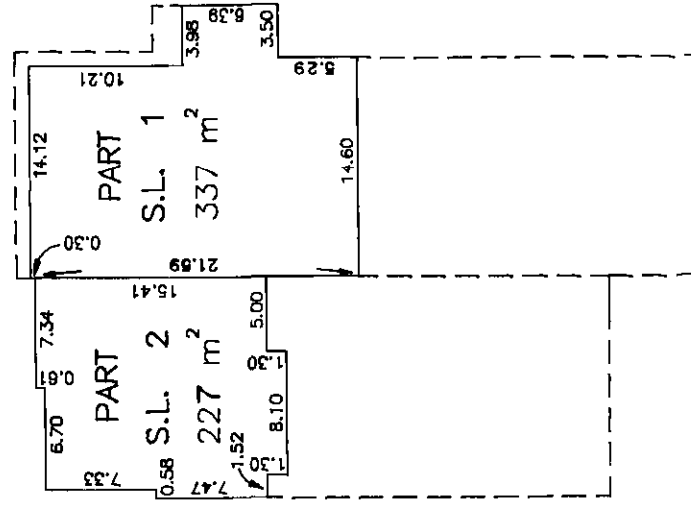

SECOND FLOOR

THIS 21ST DAY OF FEBRUARY, 1997.

R. Johns
RL JOHN, B.C.L.S., C.L.S.

97-004

V4-B
W10-B

LTO 018905

