

First Sheet, Sheet 1 of 9
STRATA PLAN PG5 203

Deposited and registered in the Land Title Office at Prince George this 24th day of April 1995

**STRATA PLAN OF LOT 7,
 PLAN 9947, DISTRICT LOT 1433,
 CARIBOO DISTRICT.**
 B.C.G.S. 93G.087

Brian Sigurdson
 REGISTRAR
 P 5 12 8 9 5
 P 5 12 8 9 9

Scale: 1 : 1000 (Distances are in metres)

Note: This plan shows ground level measured distances. Prior to computation of U.T.M. co-ordinates multiply by the combined factor 0.999951031

Grid bearings are derived from observations between control monuments 85H1222 and 85H1231, integrated survey area number 39, City of Prince George, B.C.

- LEGEND**
- Standard Iron Post Found
 - Control Monument
 - Wt Witness Post
 - C Common Property
 - S.L. Denotes Strata Lot
 - pt Denotes part

Civic Address
 3341 Westwood Drive
 Prince George, B.C.
 V2N 1S4

The address for service of documents of the Strata Corporation is:
 614-1488 Fourth Avenue
 Prince George, B.C.
 V2L 4Y2

I, Gordon Kilbride, of Prince George, a British Columbia Land Surveyor, hereby certify that the buildings erected on the parcel are wholly within the external boundaries of that parcel.
 Dated at Prince George, B.C.
 this 8th day of February, 1995.

Gordon Kilbride
 Gordon Kilbride, B.C.L.S.

This plan lies within the Fraser-Fort George Regional District.

KILBRIDE LAND SURVEYING LTD.
 British Columbia Land Surveyors
 Prince George, B.C.
 Ph: (604) 562-1196 Fax: 562-3656
 F.B.-UR 44 D.L.-1433 REF. NO.-940957S1

STRATA PLAN OF LOT 7,
PLAN 9947, DISTRICT
LOT 1433, CARIBOO DISTRICT.

STRATA LOT NO.	SHEET NO.	FORM 1	FORM 2
		SCHEDULE OF UNIT ENTITLEMENT Unit Entitlement	SCHEDULE OF INTEREST UPON DESTRUCTION Interest Upon Destruction
1	4,5 & 6	213	1
2	4,5 & 6	213	1
3	4,5 & 7	182	1
4	4,5 & 7	183	1
5	4,5 & 7	182	1
Aggregate		973	5

STATUTORY DECLARATION

I, the undersigned, do solemnly declare that
(1) I, the undersigned am the owner developer.
(2) The strata plan is entirely for residential use.

Accepted as to Forms 1 & 2
this 18th day of April, 1995.

I make the solemn declaration conscientiously believing it to be true and knowing that it is the same force and effect as if made under oath.

for: Duboy
Superintendent of Real Estate

N. Robert Nose

Authorized Signatory Devinder Pal Singh Parmar

Owner: N. Robert Nose

Devinder Pal Singh Parmar

Declared before me at Prince George in the Province of British Columbia.
This 12th day of April, 1995.

A Commissioner of Oaths,
N. Robert Nose

NEW DEVELOPMENT CERTIFICATE
I, Gordon Kilbride, of Prince George, a British Columbia Land Surveyor, hereby certify that the strata lot represented on Strata Plan of Lot 7, Plan 9947, District Lot 1433, Cariboo District constitute a new development and have not, to the best of my knowledge and belief, been previously occupied.

Dated at Prince George, B.C.
This 8th day of February, 1995.

Gordon Kilbride
Gordon Kilbride, B.C.L.S.

Owner: Mortgage P/J3005
Investors Group Trust Co. Ltd. Reg.# A33060

Authorized Signatory
SAVI E. WILLIAMS

Print Name
S. E. Williams

Authorized Signatory
L. Laing

Print Name
Robert McKinnon

Witness to both signatures
Robert McKinnon

Print Name
901070-666 Burnaby

Address
Vancouver B.C. V6C 2P8

Postal Code
Moetgaag Administratie

Occupation

Owner:

Kewal Singh Raju

Kewal Singh Raju

Witness
Robert McKinnon

Print Name
901070-666 Burnaby St,

Address
Vancouver B.C. V6C 2P8

Postal Code
Moetgaag

Occupation
N. Robert Nose

Witness to both signatures
Robert McKinnon

Print Name
901070-666 Burnaby

Address
Vancouver B.C. V6C 2P8

Postal Code
Moetgaag Administratie

Occupation

STRATA PLAN OF LOT 7
 PLAN 9947, DISTRICT LOT 1433,
 CARIBOO DISTRICT.

B.C.S. 936.087

Not to Scale

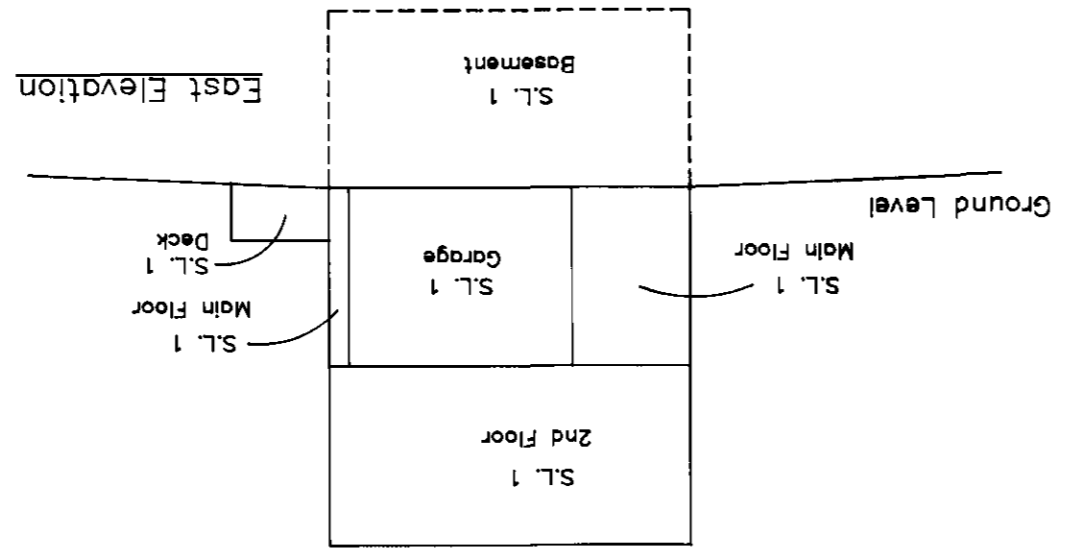
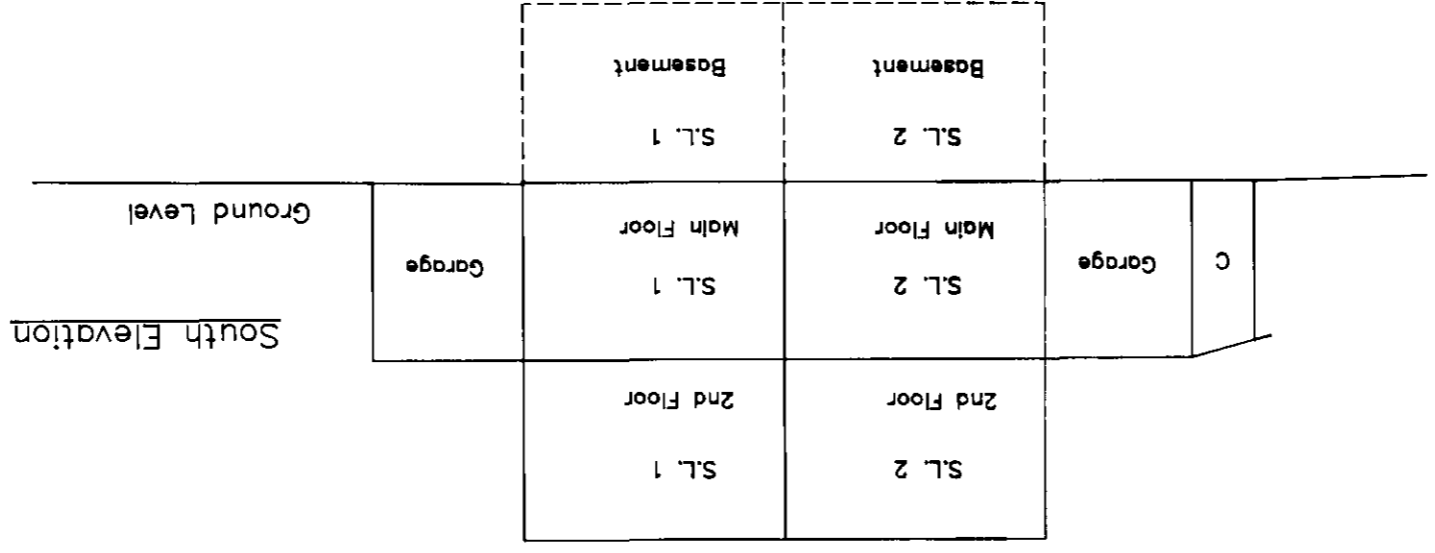
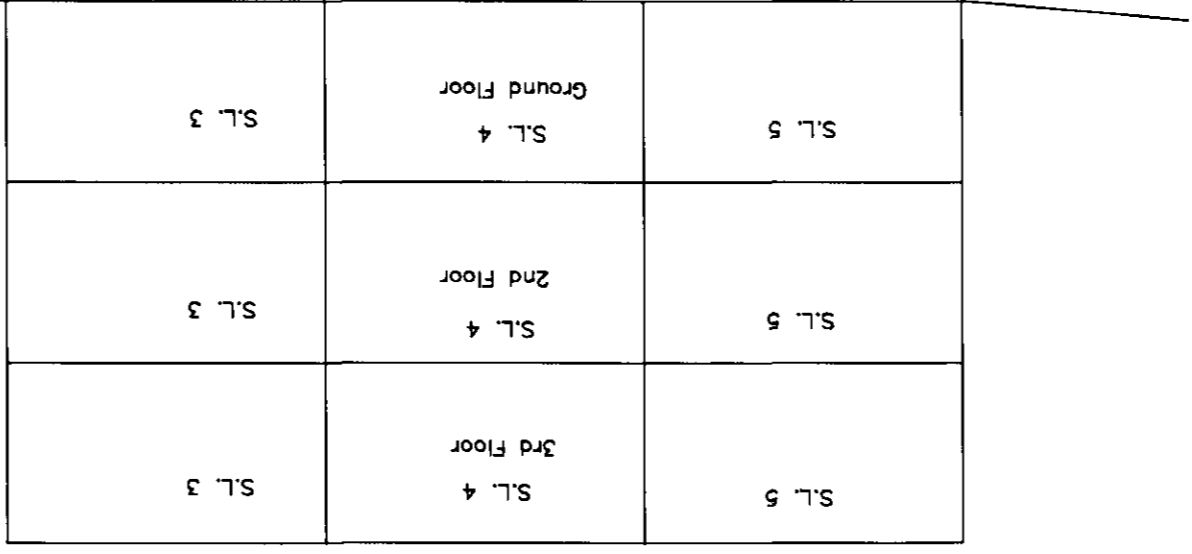
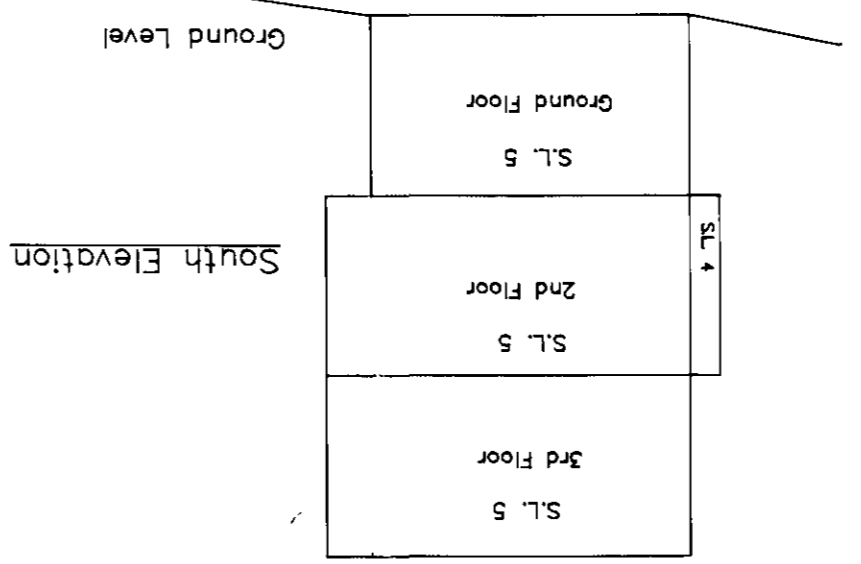

This 8th day of February, 1995.

Gordon Kilbride
 Gordon Kilbride, B.C.L.S.

Ref No. 9409754

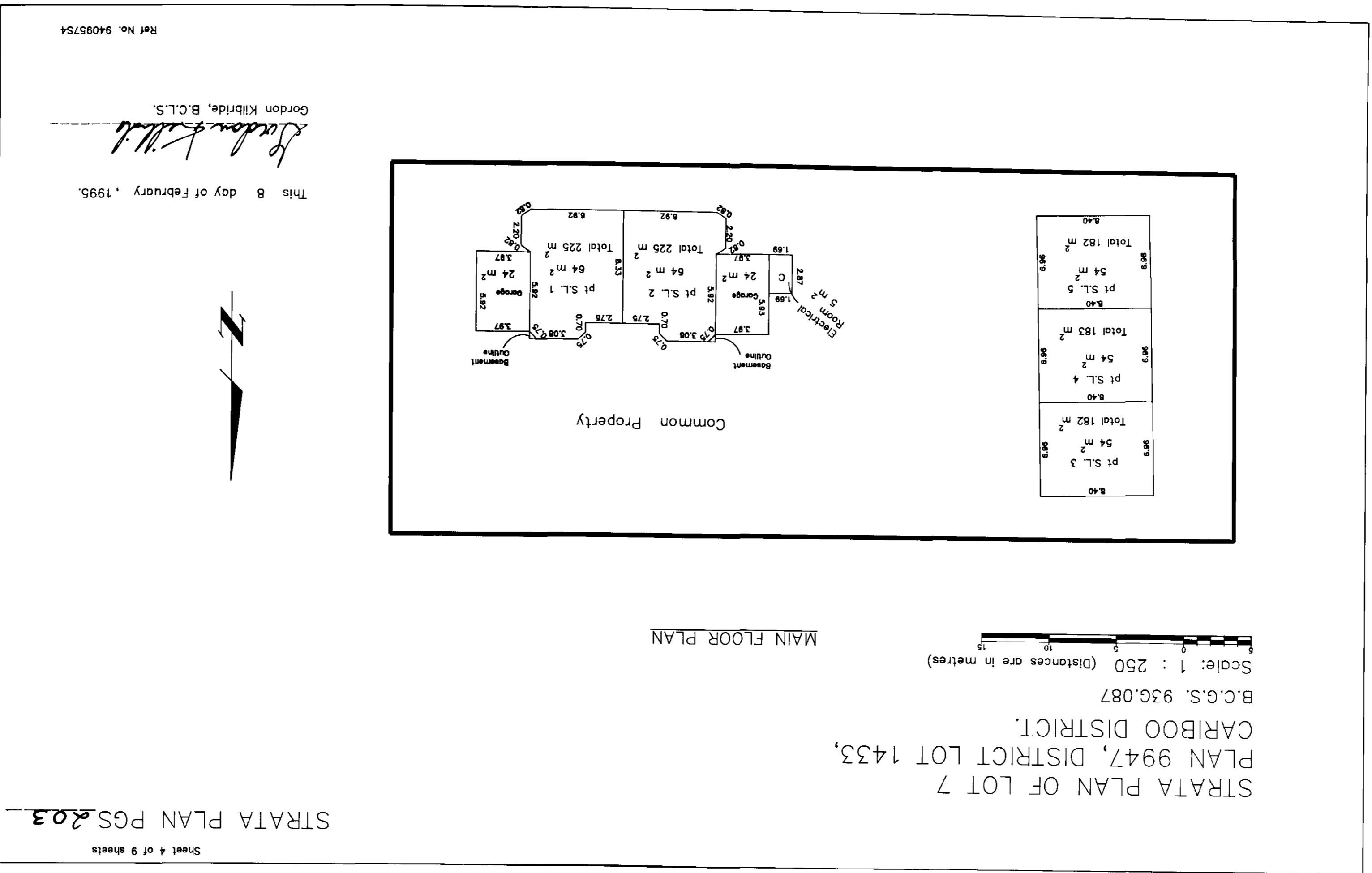

Ref No. 9495754

Gordon Kilbride
 Gordon Kilbride, B.C.L.S.

This 8 day of February, 1995.

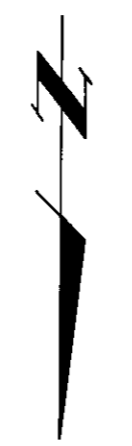

STRATA PLAN OF LOT 7,
PLAN 9947, DISTRICT LOT 1433,
CARIBOO DISTRICT.

B.C.G.S. 93G.087

Scale: 1 : 250 (Distances are in metres)



SECOND FLOOR PLAN

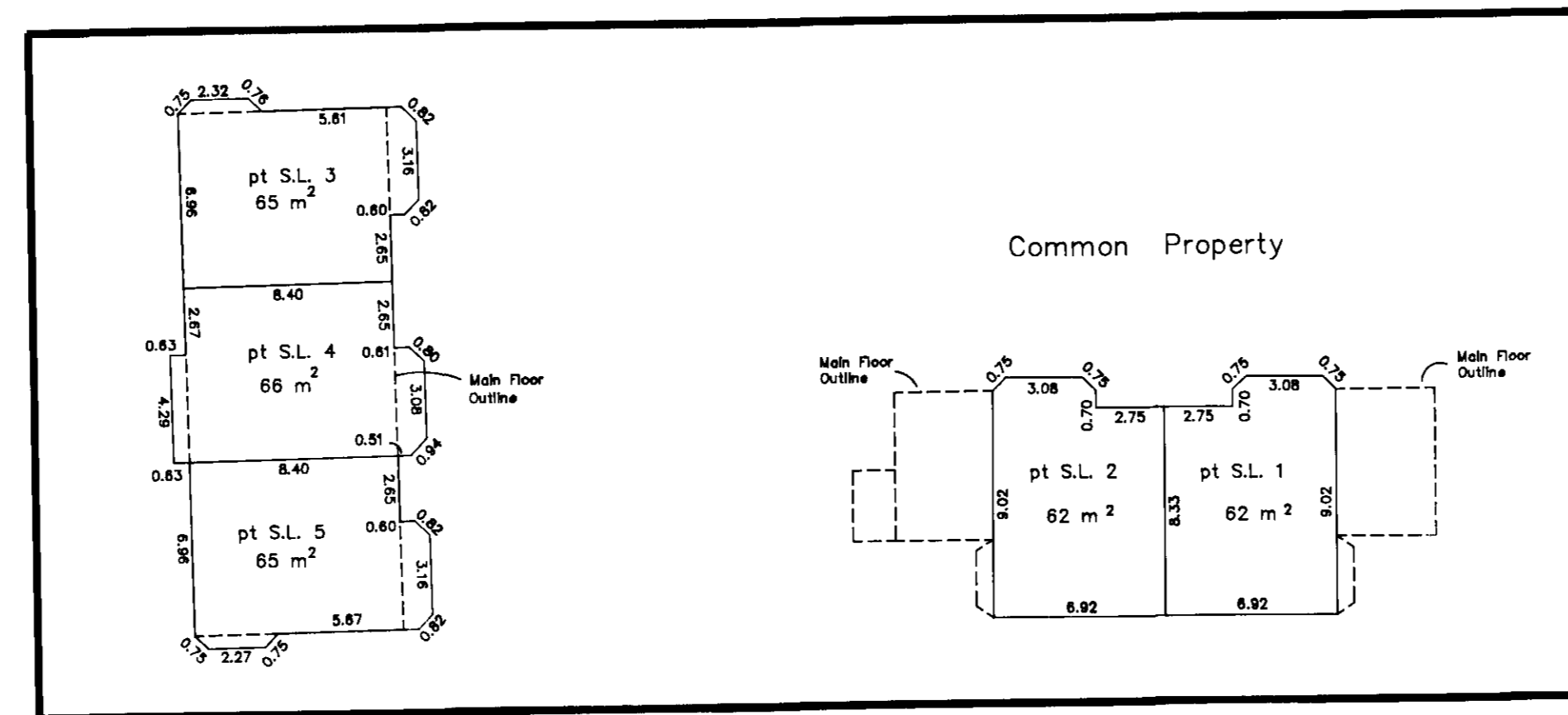

This 8 day of February, 1995.

Gordon Kilbride
Gordon Kilbride, B.C.L.S.

STRATA PLAN OF LOT 7,
PLAN 9947, DISTRICT LOT 1433,
CARIBOO DISTRICT.

B.C.G.S. 93G.087

Scale: 1 : 250 (Distances are in metres)

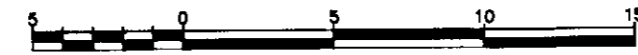

BASEMENT FLOOR PLAN

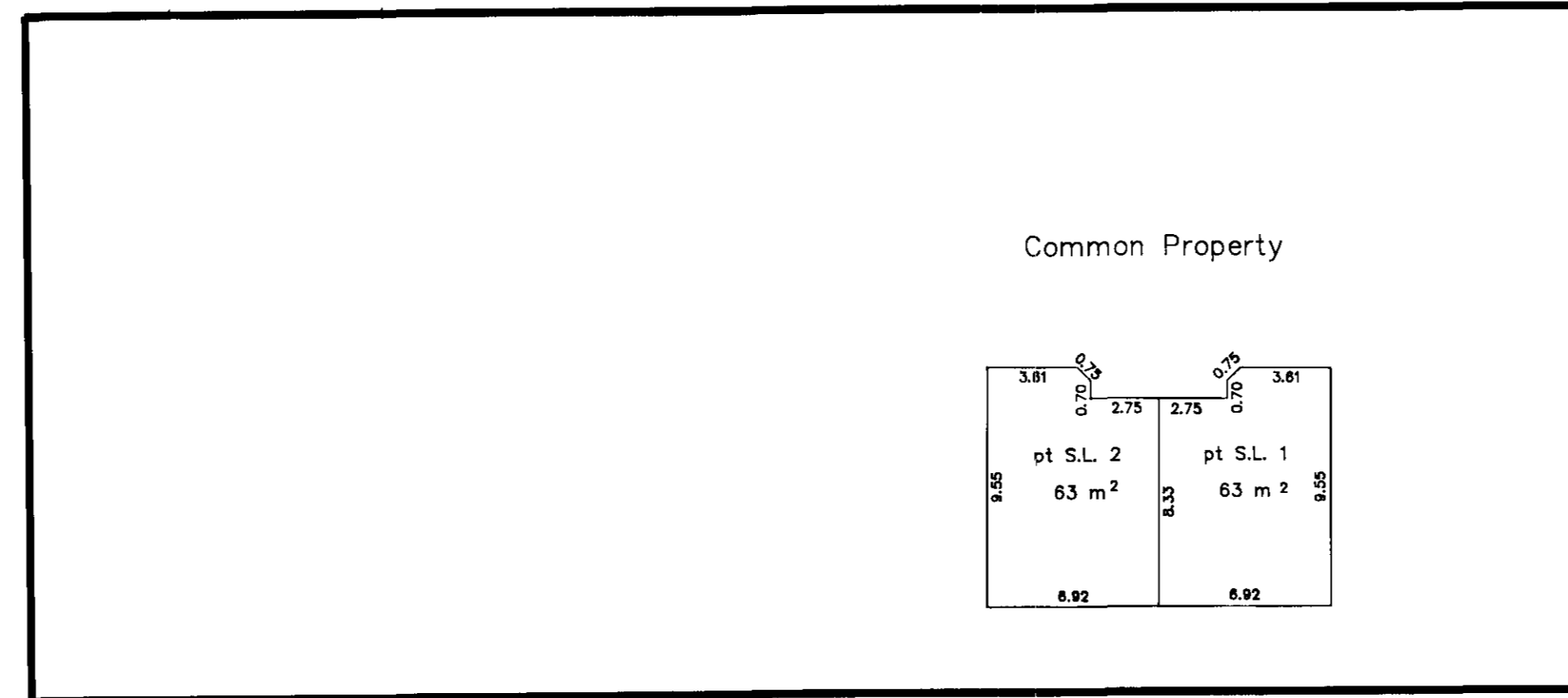

This 8 day of February , 1995.

Gordon Kilbride
Gordon Kilbride, B.C.L.S.

STRATA PLAN OF LOT 7
PLAN 9947, DISTRICT LOT 1433,
CARIBOO DISTRICT.

B.C.G.S. 93G.087

Scale: 1 : 250 (Distances are in metres)

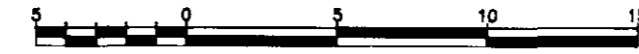

THIRD FLOOR PLAN

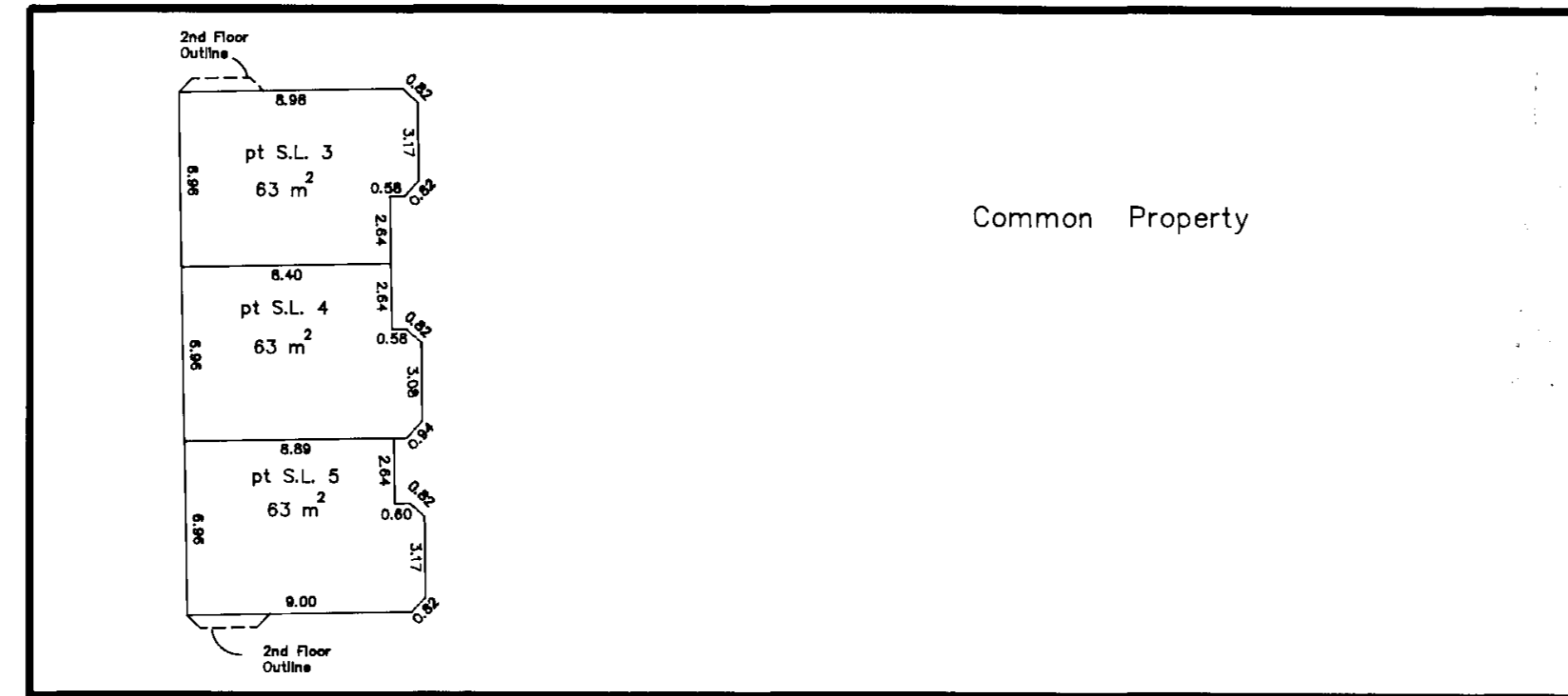

This 8 day of February , 1995.

Gordon Kilbride
Gordon Kilbride, B.C.L.S.

STRATA PLAN OF LOT 7,
 PLAN 9947, DISTRICT LOT 1433,
 CARIBOO DISTRICT.
 STRATA PLAN PGS **203**

RECORD OF BY-LAWS AND ORDERS, etc.

NUMBER	FILING		DOCUMENT
	DATE	DATE	
P512900	24-04-95	14:58	

SEARCHED INDEXED SERIALIZED FILED
 DISTRICT CLERK
 CARIBOO DISTRICT BC
 FEB 1 1995
 VANCOUVER

This 8 day of February, 1995.



Gordon Kilbride, B.C.L.S.

Sheet 9 of 9 Sheets
 STRATA PLAN OF LOT 7,
 PLAN 9947, DISTRICT LOT 1433,
 CARIBOO DISTRICT.
 STRATA PLAN PGS **203**

DEALINGS AFFECTING THE COMMON PROPERTY

NUMBER	DATE	REGISTRATION DATE	DOCUMENT	NATURE and PARTICULARS

Common Property Sheet Linked
 Section 248(3) of the Land Act
 Current Information BC Reg. 76/95

This 8 day of February , 1995.
Gordon Kibridge
 Gordon Kibridge, B.C.L.S.