

PLAN OF SUBDIVISION OF
LOT 13, PLAN 11006
DISTRICT LOT 4039
CARIBOO DISTRICT.

B.C.G.S. 93G.097

PLAN No. PGP 40483

DEPOSITED IN THE LAND TITLE OFFICE
AT PRINCE GEORGE, B.C., THIS 02
DAY OF Oct 1996



SCALE = 1 : 500
ALL DISTANCES ARE IN METRES.

THIS PLAN SHOWS GROUND-LEVEL MEASURED DISTANCES.
PRIOR TO COMPUTATION OF U.T.M. COORDINATES, MULTIPLY
BY COMBINED FACTOR 0.99949663.

GRID BEARINGS ARE DERIVED FROM OBSERVATIONS
BETWEEN CONTROL MONUMENTS 86H1619, AND 86H1576,
INTEGRATED SURVEY AREA NUMBER 39, PRINCE GEORGE.

LEGEND

- STANDARD IRON POST FOUND
- STANDARD IRON POST PLACED
- ⊙ CONTROL MONUMENT

B.B.
REGISTRAR

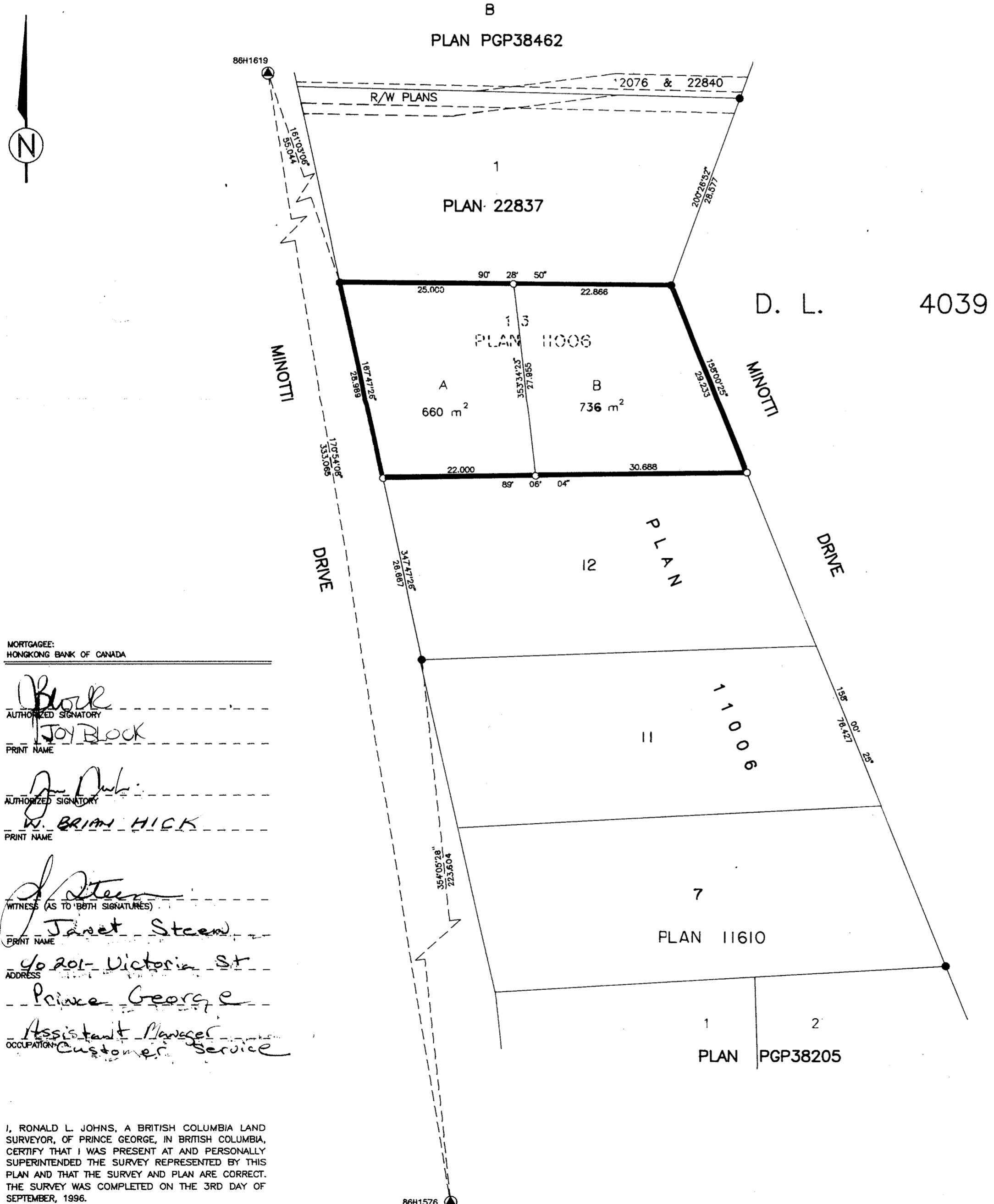

MORTGAGEE:
HONGKONG BANK OF CANADA

Joy Block
AUTHORIZED SIGNATORY
JOY BLOCK
PRINT NAME

W. Brian Hick
AUTHORIZED SIGNATORY
W. BRIAN HICK
PRINT NAME

J. Steen
WITNESS (AS TO BOTH SIGNATURES)
Janet Steen
PRINT NAME

40201 Victoria St
Address
Prince George
Assistant Manager
Occupation Customer Service

Alexander
OWNER: ARON RICHARD ALEXANDER
WITNESS:
John Edward Charles Brentree
PRINT NAME
3820 Brentwood Pl
Address
Prince George BC
PRES. NATIONAL SKI EXPERTS LTD
OCCUPATION

APPROVED UNDER THE LAND TITLE ACT
THIS 26th DAY OF September 1996
E. J. Charter
APPROVING OFFICER, CITY OF PRINCE GEORGE.

I, RONALD L. JOHNS, A BRITISH COLUMBIA LAND SURVEYOR, OF PRINCE GEORGE, IN BRITISH COLUMBIA, CERTIFY THAT I WAS PRESENT AT AND PERSONALLY SUPERINTENDED THE SURVEY REPRESENTED BY THIS PLAN AND THAT THE SURVEY AND PLAN ARE CORRECT. THE SURVEY WAS COMPLETED ON THE 3RD DAY OF SEPTEMBER, 1996.

R.L. Johns
R.L. JOHNS, B.C.L.S., C.L.S.

THIS PLAN LIES WITHIN THE FRASER-FORT GEORGE REGIONAL DISTRICT.

R. L. JOHNS LAND SURVEYING LTD.
LEGAL AND ENGINEERING SURVEYS
240 VICTORIA STREET
PRINCE GEORGE, B. C. V2L 2J4
PHONE: (604)562-5759
FAX: (604)562-5703