

PLAN NO. BCP 15139

Deposited in the Land Title Office at New Westminster this 21 day of *DEC* 2004.

REGISTRAR

*BW 572 929*

EXPLANATORY PLAN OF EASEMENT OVER PART OF LOTS 1 AND 2, DISTRICT LOT 2003, CARIBOO DISTRICT, PLAN BCP 15138.

Pursuant to Section 99 of the Land Title Act. B.C.G.S. 93G.087

Scale: 1 : 250 (Distances are in metres)

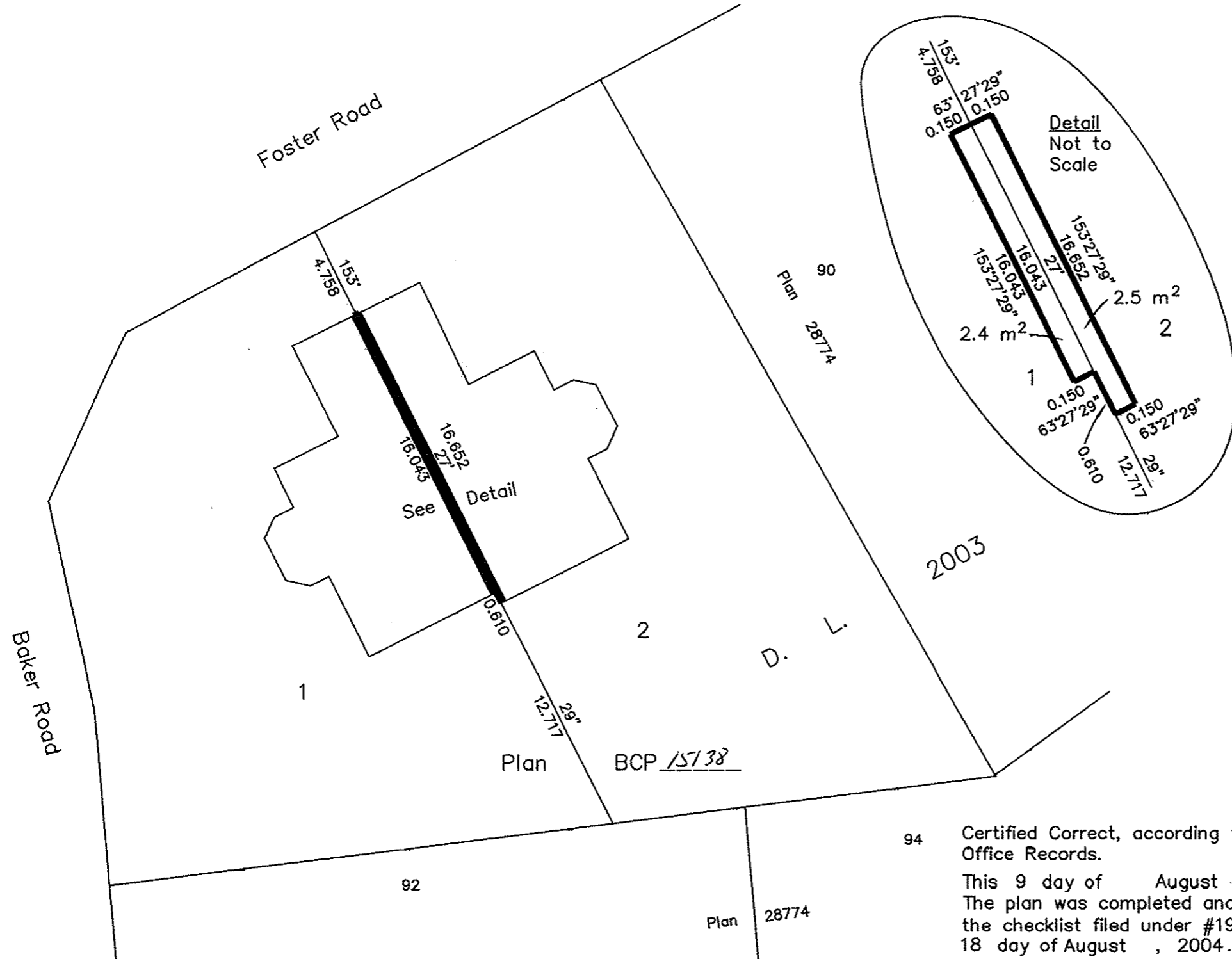
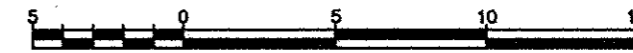

94 Certified Correct, according to Land Title Office Records.  
This 9 day of August, 2004.  
The plan was completed and checked, and the checklist filed under #19714, on the 18 day of August, 2004.

*Gordon Kilbride*  
Gordon Kilbride, B.C.L.S.

This plan lies within the Fraser-Fort George Regional District.

BOOK OF REFERENCE	
DESCRIPTION	AREA
Lot 1, D.L. 2003, Cariboo District, Plan BCP <u>15138</u> .	2.4 m <sup>2</sup>
Lot 2, D.L. 2003, Cariboo District, Plan BCP <u>15138</u> .	2.5 m <sup>2</sup>

**KILBRIDE LAND SURVEYING LTD.**  
British Columbia Land Surveyors  
Prince George, B.C.  
Ph: (250) 562-1196 Fax: 562-3656

F.B.- RA	D.L.- 2003	File No. - 040120F
----------	------------	--------------------