

Explanatory Plan to Accompany  
 By-Law No. 1423, City of Prince George, B.C.  
 Closing Part of 9<sup>th</sup> Avenue  
 Plan 1268, District Lot 343,

Cariboo District  
 Scale 1" = 100'

**PLAN B-7548**  
 Deposited in the Land Registry Office at Kamloops, B.C.  
 this 2<sup>nd</sup> day of MAY 1961.

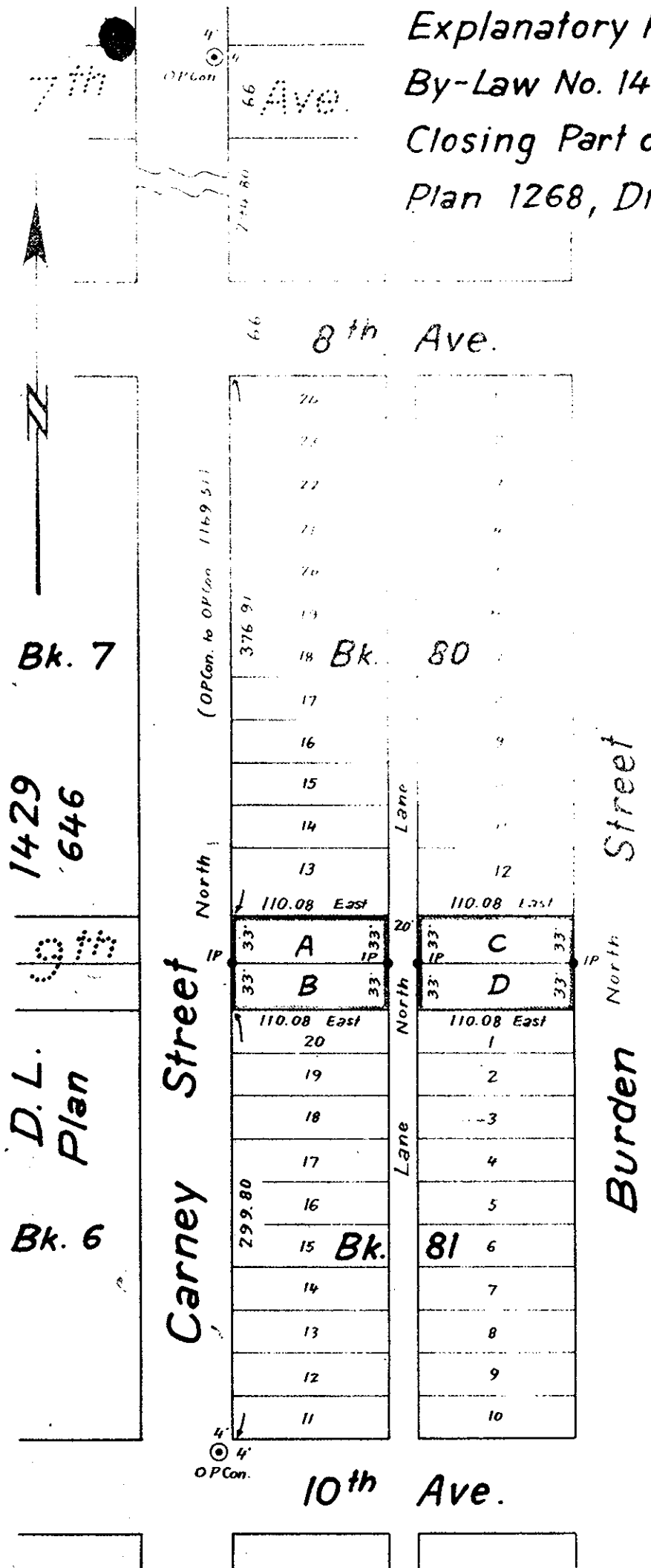

Legend

Bearings are astronomic and are derived from Plan 1268

Standard concrete post found shown  
 Iron post set shown

OPCon  
 IP

*Chapman*  
 Registrar

I, the undersigned, a surveyor in the City of Prince George, British Columbia, do hereby certify that I was present at and personally supervised the survey represented by this plan and that the bearings and distances are correct. The said survey was completed on the 1<sup>st</sup> day of March 1961.

Sworn before me this  
 8<sup>th</sup> day of March 1961

B.C.L.S.

*W. M. Whyte*  
 A Commissioner for taking affidavits  
 within British Columbia

McWilliam, Whyte, Serle & Goble  
 British Columbia Land Surveyors

Ref. No. 61100-C