

Plotted L.M.

PLAN OF RIGHT-OF-WAY
PACIFIC GREAT EASTERN RAILWAY
THROUGH PARTS OF
D.L. 2156 & D.L. 2062
CARIBOO DISTRICT-BRITISH COLUMBIA
SCALE: - 1 INCH = 200 FEET

PLAN No. A-1444
Deposited in the Land Registry
Office at Kamloops B.C. this
24 day of March 1955

J. V. McCastin
Registrar

L.2061

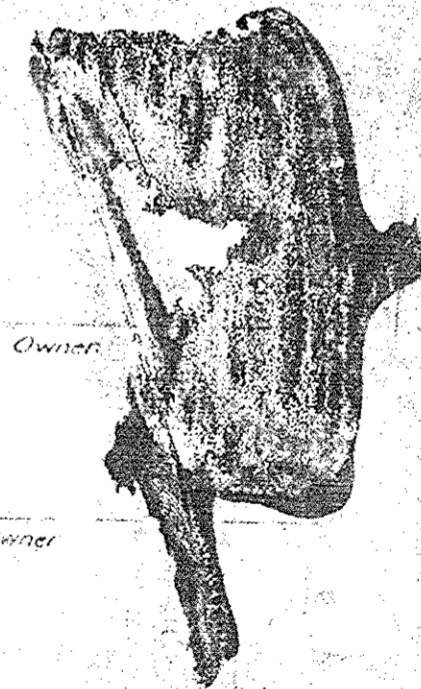
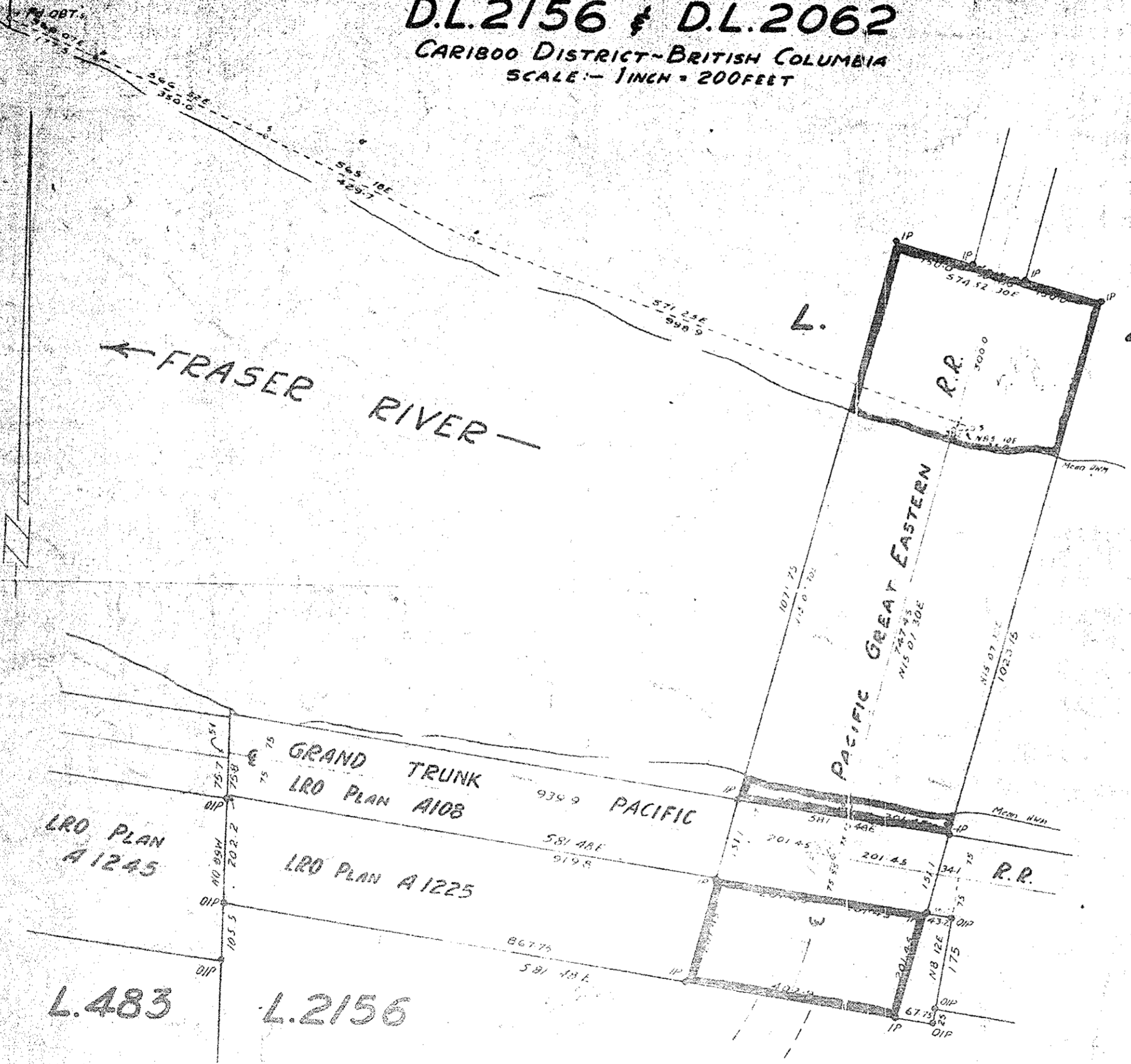

Signature of Registered Owner

Witness to Signature of Owner

Signature of Registered Owner

Witness to Signature of Owner

LEGEND:
Bearings are astronomic derived from
boundaries of LdL shown on LRO Plan No.
A1225.
• OIP denotes an old iron post found in place
• IP denotes an iron post placed in this survey

I, Charles P. Blodgett, of the City of Prince George,
in and to-wit, Surveyor make oath and
swear that I was present at and did personally
superintend the survey represented by this
plan and that the survey and plan are correct.

The above survey was completed on the
27 day of January, 1955.

Witnessed before me this
27 day of January, 1955. *[Signature]*

[Signature]
Commissioner for taking affidavits within the
Province of British Columbia