

PLAN OF SUBDIVISION OF THE WESTERN PORTION OF L.629.G.I. CARIBOO DIST. B.C.

Scale 200 Feet = 1 Inch.

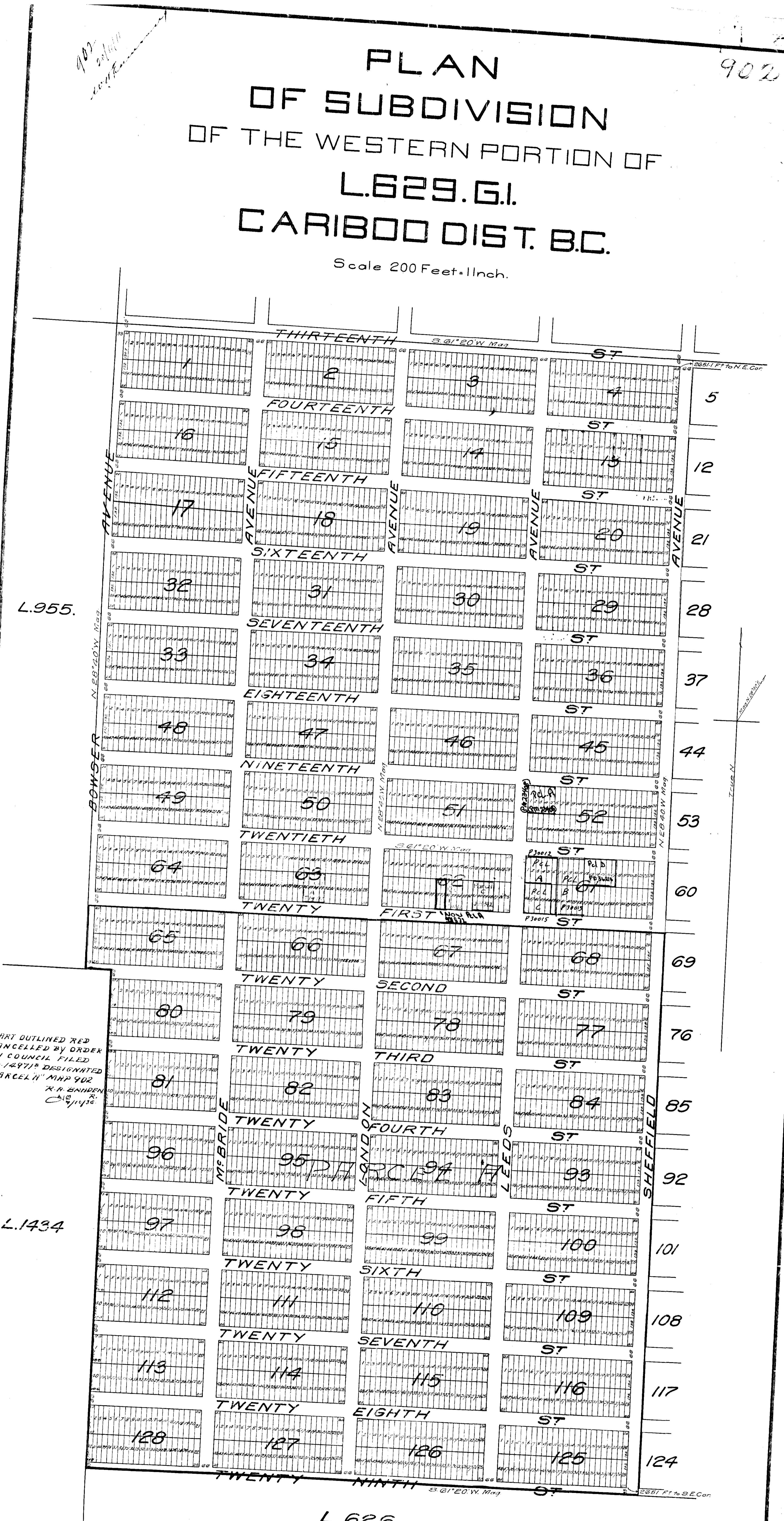

L.955.

L.1434

L.626

PART OUTLINED RED
CANCELLED BY ORDER
IN COUNCIL FILED
NO. 14971 DESIGNATED
PARCEL "A" MAP 902
R.A. BARNES
C 1/1/76

Each Street

I, O.B.N. Wilkie, a B.C.L.S. certify that
this plan is a correct representation
of the survey made by me upon the
ground and is prepared under
the Provisions of the Land Registry
Act

O.B.N. Wilkie