

26-FF-226

EXPLANATORY PLAN TO ACCOMPANY A RESTRICTIVE COVENANT ON LOTS 6 TO 13 INCLUSIVE, PLAN PGP40491 DISTRICT LOT 2432 CARIBOO DISTRICT. B.C.G.S. 93J.007

PLAN No. PGP 40492
DEPOSITED IN THE LAND TITLE OFFICE AT PRINCE GEORGE, B.C., THIS 2 DAY OF Oct. 19 96

PURSUANT TO SECTION 215 OF THE LAND TITLE ACT.

BOOK OF REFERENCE		AREA REQUIRED
DESCRIPTION		
LOT 6, PLAN PGP 40491, D. L. 2432		335 m ²
LOT 7, PLAN PGP 40491, D. L. 2432		260 m ²
LOT 8, PLAN PGP 40491, D. L. 2432		260 m ²
LOT 9, PLAN PGP 40491, D. L. 2432		260 m ²
LOT 10, PLAN PGP 40491, D. L. 2432		260 m ²
LOT 11, PLAN PGP 40491, D. L. 2432		260 m ²
LOT 12, PLAN PGP 40491, D. L. 2432		260 m ²
LOT 13, PLAN PGP 40491, D. L. 2432		260 m ²

Brian Biggar
REGISTRAR
PK 40096



SCALE = 1 : 750

ALL DISTANCES ARE SHOWN IN METRES.

BEARINGS ARE ASTRONOMIC, DERIVED FROM PLAN PGP40491.

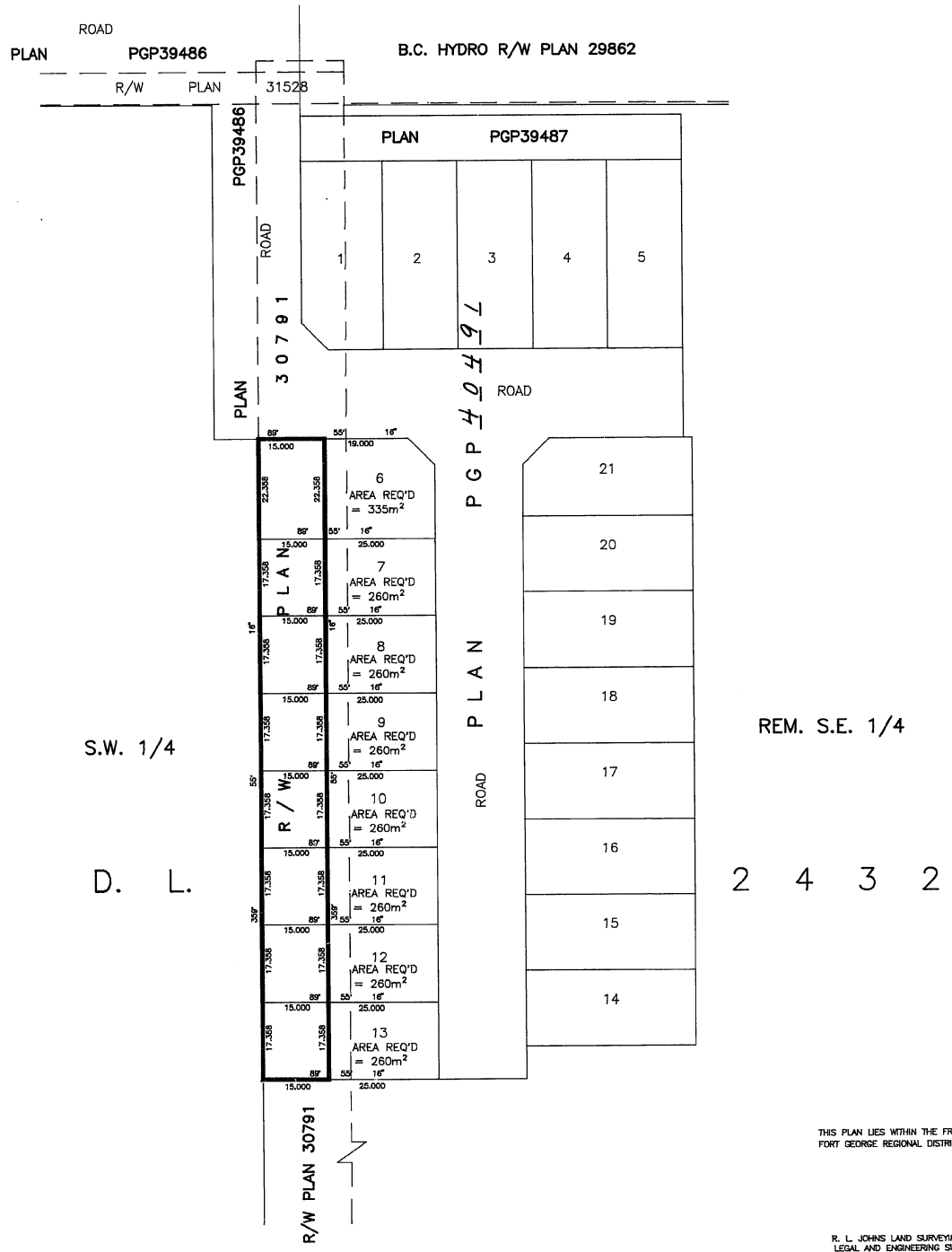

CERTIFIED CORRECT
ACCORDING TO LAND TITLE OFFICE RECORDS
THIS 27TH DAY OF SEPTEMBER, 1996.

R. L. Johns
R. L. JOHNS, B.C.L.S., C.L.S.

THIS PLAN LIES WITHIN THE FRASER-FORT GEORGE REGIONAL DISTRICT.

R. L. JOHNS LAND SURVEYING LTD.
LEGAL AND ENGINEERING SURVEYS
240 VICTORIA STREET
PRINCE GEORGE, B. C. V2L 2J4
PHONE: (604)582-5759
FAX: (604)562-5703
95-32-E