

**EXPLANATORY PLAN OF EASEMENT OVER PARTS OF STRATA LOTS 1 AND 2, DISTRICT LOT 2014, CARIBOO DISTRICT, STRATA PLAN EPS3221.**

**PLAN EPP62452**

Pursuant to Section 99(1)(e) of the Land Title Act.

BCGS 93G.087



The intended plot size of this plan is 432mm in width by 280mm in height (B size) when plotted at a scale of 1:250.

All distances are horizontal ground-level and in metres and decimals thereof.

Integrated Survey Area No. 39, City of Prince George,

Grid Bearings are derived from previously integrated Plan EPS3221.

**22  
Plan EPP5390**

**Plan  
EPS3221  
2014**

**Rem  
DL 2014**

**20  
Plan EPP5390**



**Creekside Way**

**DL  
Strata Lot 1**

**Strata Lot 2**

**Dwelling**

**Dwelling**

**0.30m wide Easement**

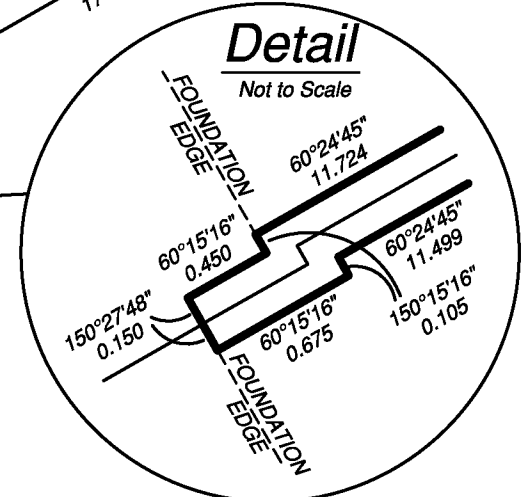

Book of Reference	
Legal Description	Area
Strata Lot 1 Plan EPS3221	1.8m <sup>2</sup>
Strata Lot 2 Plan EPS3221	1.8m <sup>2</sup>
<b>Total</b>	<b>3.7m<sup>2</sup></b>

This plan is based on the following Land Title and Survey Authority of BC Records: Plan EPS3221.

Tracey Peet, BCLS 936



WSP Surveys (BC) Limited Partnership  
780-3rd Avenue, Prince George, BC

PROJECT REF./DRAWING No.  
010054567-BNSU01-R00