

EXPLANATORY PLAN OF EASEMENT OVER PART OF LOT 3, DISTRICT LOT 2100, CARIBOO DISTRICT, PLAN PGP43819.

PLAN EPP44331

PURSUANT TO SECTION 99(1)(e) OF THE LAND TITLE ACT.

BCGS 93G.096

INTEGRATED SURVEY AREA No. 39, PRINCE GEORGE, NAD83 (CSRS)

THE INTENDED PLOT SIZE OF THIS PLAN IS 432mm IN WIDTH BY 280mm IN HEIGHT (B SIZE) WHEN PLOTTED AT A SCALE OF 1:500



ALL DISTANCES ARE HORIZONTAL GROUND-LEVEL AND ARE SHOWN IN METRES AND DECIMALS THEREOF, UNLESS OTHERWISE INDICATED.

LEGEND

GRID BEARINGS ARE DERIVED FROM PREVIOUSLY INTEGRATED PLAN PGP43819.

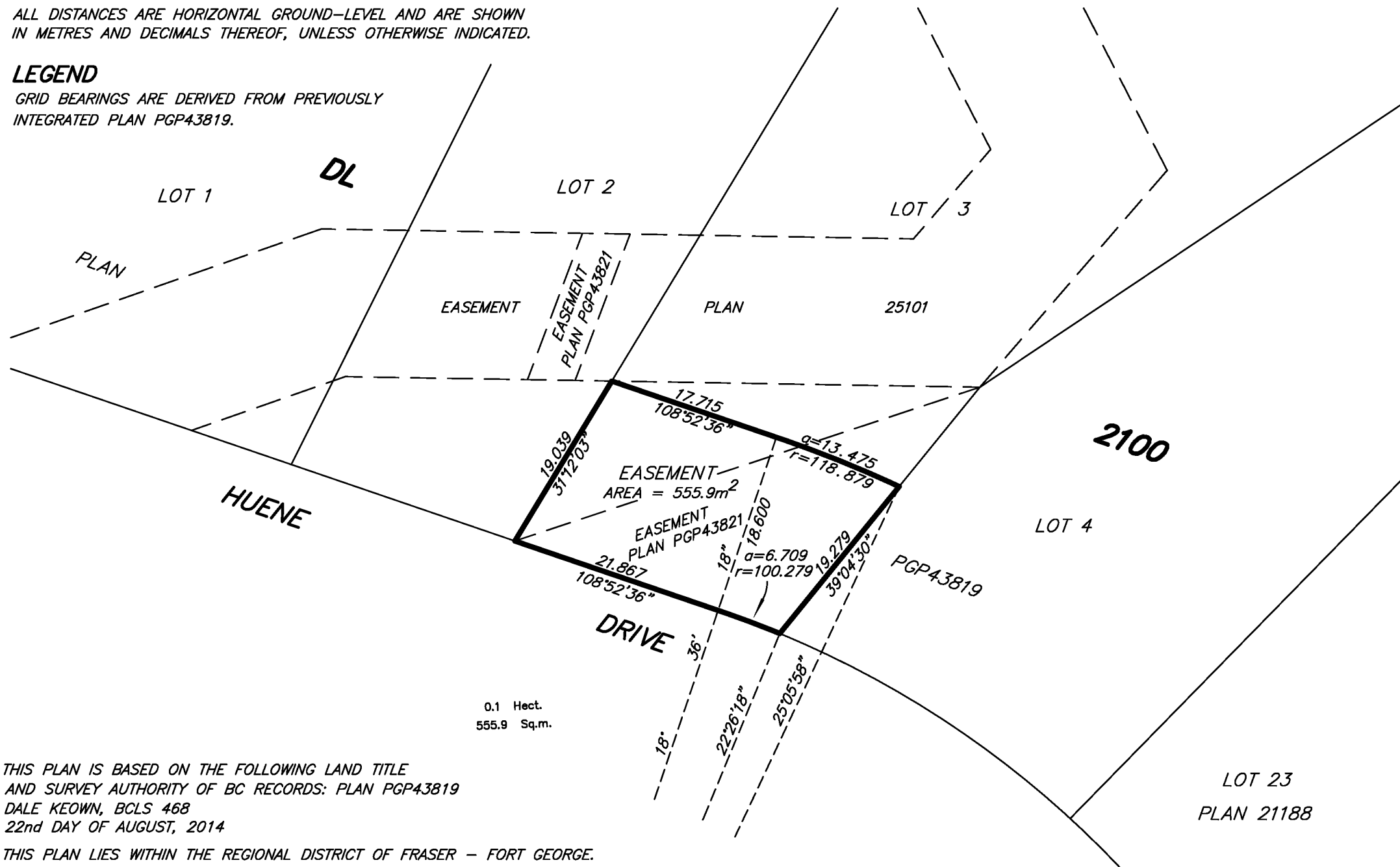

0.1 Hect.
555.9 Sq.m.

THIS PLAN IS BASED ON THE FOLLOWING LAND TITLE
AND SURVEY AUTHORITY OF BC RECORDS: PLAN PGP43819
DALE KEOWN, BCLS 468
22nd DAY OF AUGUST, 2014

THIS PLAN LIES WITHIN THE REGIONAL DISTRICT OF FRASER - FORT GEORGE.

McElhanney
McElhanney Associates
Land Surveying Ltd.
Prince George, B.C.

E-mail: pgmals@mcElhanney.com
Ph: (250) 561-2229 Fax: (250) 563-1941

| | |
|----------|------------------------|
| DL- 2100 | File No. - 6014-2102-A |
|----------|------------------------|

LOT 23
PLAN 21188