

INDIAN RESERVE NO: 2

PLAN OF SUBDIVISION OF LOT 11868  
 AND PART OF LOT 847  
 CARIBOO DISTRICT  
 BRITISH COLUMBIA

Scale: 1 inch = 200 feet

LEGEND

BEARINGS ARE ASTRONOMIC AND ARE DERIVED FROM CENTRE LINE OF C.N.R. RAILWAY AS SHOWN ON PLAN 2251 KAMLOOPS LAND REGISTRY OFFICE.

- |                               |             |
|-------------------------------|-------------|
| R/W CENTRE LINE               | —           |
| LOT BOUNDARY                  | —           |
| GALVANIZED IRON BAR FOUND     | ● O.I.P.    |
| GALVANIZED IRON BAR SET       | ● I.P.      |
| WOODEN POST FOUND             | ○ O.P.      |
| STANDARD PIPE POST FOUND      | ● O.P.P.    |
| STANDARD PIPE POST SET        | ○ P.P.      |
| STANDARD CONCRETE POST FOUND  | ● O.P. Con. |
| PITS AND MOUND SHOWN AS       | Pit. M.     |
| BEARINGS TREES SHOWN AS       | B. Ts.      |
| AREA REQUIRED OUTLINED IN RED | ---         |
| RIVER TRAVERSE LINE SHOWN AS  | ---         |

AFFIDAVIT

I, Alfred Wade of the City of Vancouver British Columbia Land Surveyor make oath and say that I was present at and did personally superintend the survey represented by this plan and that the survey and plan are correct. The said survey was completed on the 31<sup>st</sup> day of May 1956.

*Alfred Wade*  
 British Columbia Land Surveyor

Sworn before me this 27<sup>th</sup> day of July 1956.

*W. J. Salmond*  
 A Notary Public in and for the Province of British Columbia

Approved under the Land Registry Act this day of 1956.

Approving Officer: \_\_\_\_\_

I hereby certify that this is a true copy of the Official Plan on deposit in the Department of Lands and Forests and numbered Plan 10 Tube 153.

*Surveyor General*  
 Victoria, B.C.  
 22<sup>nd</sup> October, 1956.

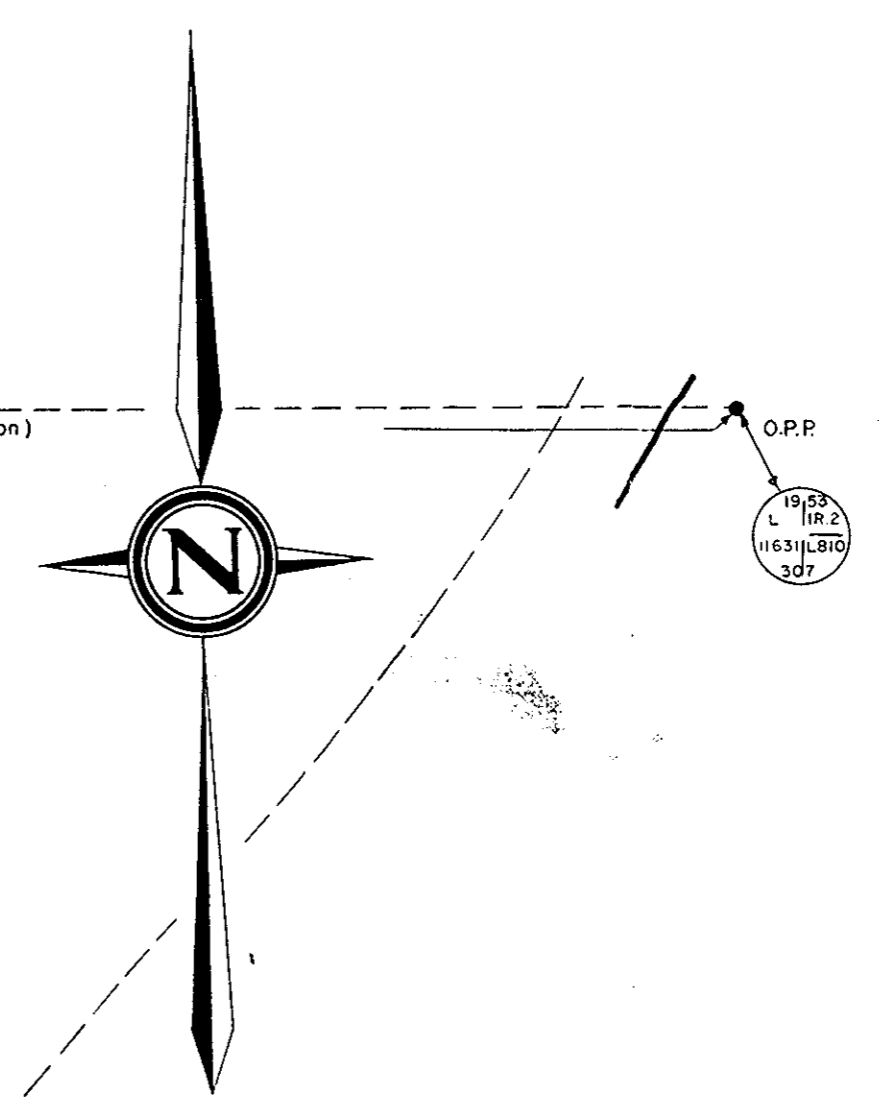

DL. 808

DISTRICT LOT 847

LOT 1  
 7.27 AC.

FRASER RIVER

ENLARGEMENT OF RIVER TRAVERSE  
 SCALE 1 inch = 100 feet

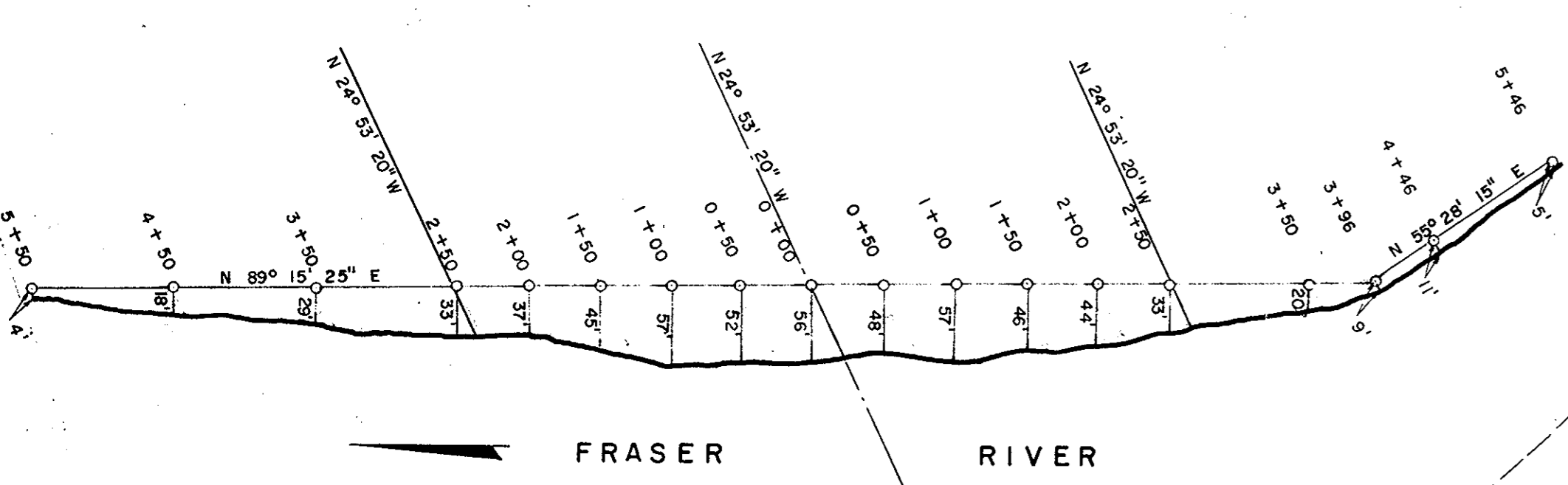

54-122 S.W.

ORIGINAL

C-3002-1