

26-FF-226

PLAN NO. 32597

EXPLANATORY PLAN OF WATERLINE EASEMENT ON LOTS 7 AND 8, PLAN 19529, DISTRICT LOT 2101, CARIBOO DISTRICT.

Deposited in the Land Title Office at Prince George this 12th day of Dec 1987.

SCALE : 1 : 500 (Distances are in metres)

W.G. Brady
Registrar



Bearings are astronomic derived from Plan 19529.

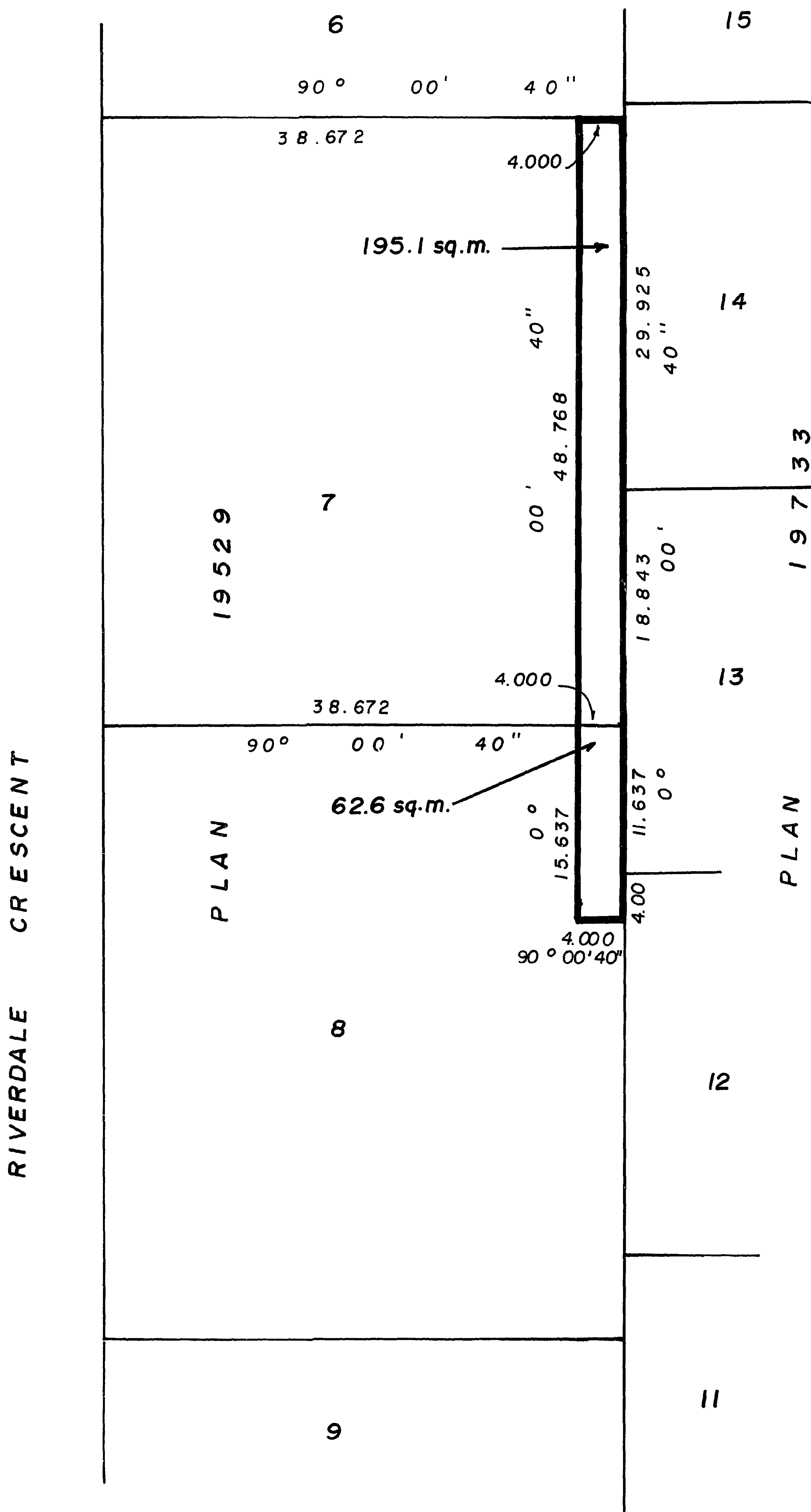

CERTIFIED CORRECT
THIS 9 DAY OF September 1987.

Gordon Killbride
G. KILBRIDE, B.C.L.S.

BOOK OF REFERENCE	
DESCRIPTION	AREA
LOT 7, PL. 19529	195.1 sq.m.
LOT 8, PL. 19529	62.6 sq.m.

THIS PLAN LIES WITHIN THE FRASER FORT GEORGE REGIONAL DISTRICT.

McWILLIAM, WHYTE, GOBLE, & ASSOCIATES,
B.C. LAND SURVEYORS
PRINCE GEORGE - KAMLOOPS - SMITHERS - SALMON ARM

REF. NO. 87173 QK 39