

26-FF

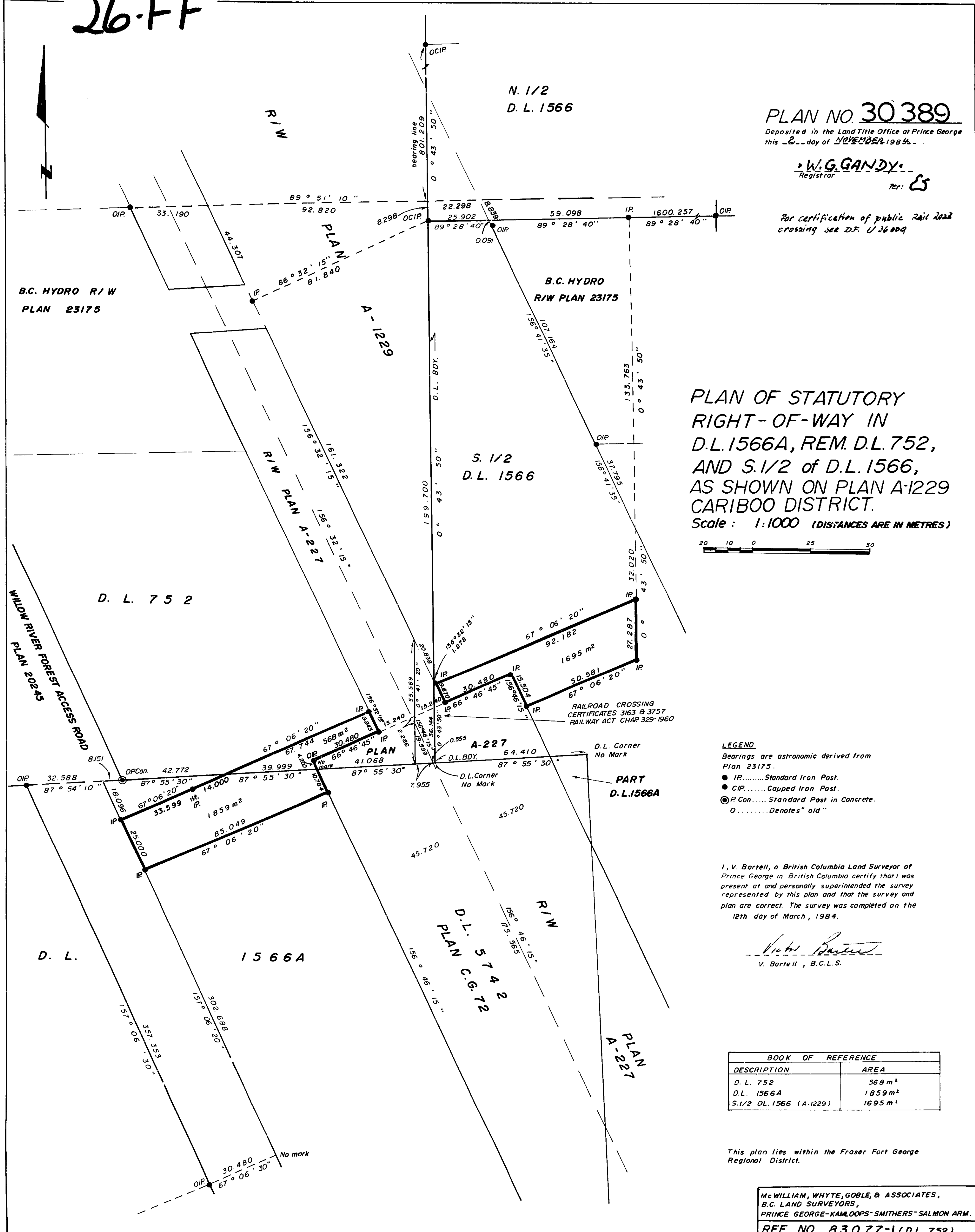

N. 1/2
D. L. 1566

PLAN NO. 30389

Deposited in the Land Title Office at Prince George
this 2nd day of NOVEMBER 1984.

W. G. GANDY
Registrar

For certification of public Rail road
crossing see D.F. U 36 009

PLAN OF STATUTORY
RIGHT-OF-WAY IN
D.L. 1566A, REM. D.L. 752,
AND S. 1/2 of D.L. 1566,
AS SHOWN ON PLAN A-1229
CARIBOO DISTRICT.

Scale : 1:1000 (DISTANCES ARE IN METRES)



LEGEND

Bearings are astronomic derived from
Plan 23175.

- IP.....Standard Iron Post.
- CIP.....Capped Iron Post.
- P Con.....Standard Post in Concrete.
-Denotes "old"

I, V. Bartell, a British Columbia Land Surveyor of
Prince George in British Columbia certify that I was
present at and personally supervised the survey
represented by this plan and that the survey and
plan are correct. The survey was completed on the
12th day of March, 1984.

V. Bartell
V. Bartell, B.C.L.S.

BOOK OF REFERENCE	
DESCRIPTION	AREA
D. L. 752	568 m ²
D.L. 1566A	1859 m ²
S. 1/2 D.L. 1566 (A-1229)	1695 m ²

This plan lies within the Fraser Fort George
Regional District.

McWILLIAM, WHYTE, GOBLE, & ASSOCIATES,
B.C. LAND SURVEYORS,
PRINCE GEORGE-KAMLOOPS-SMITHERS-SALMON ARM.
REF. NO. 83077-1 (D.L. 752)