

26-FF-226

29848

REFERENCE PLAN OF EASEMENT THROUGH
 LOTS B & C, PLAN **29844**
 DISTRICT LOT 954
 CARIBOO DISTRICT — BRITISH COLUMBIA
 SCALE: 1 : 500.



PLAN No **29848**
 Deposited in the Land Title
 Office at Prince George, B.C. this
29th day of Feb., 1984.

NOTE : Bearings are astronomic, derived from the
 south boundary of Lot B, Plan **29844**

J. Carlson *per. J.C.*
 acting Registrar

LEGEND: • OIP denotes an old iron pin found.

| BOOK OF REFERENCE | |
|-------------------|----------------------|
| PARCEL | AREA REQ'D |
| LOT B | 100.6 m ² |
| LOT C | 100.6 m ² |
| ALL IN PLAN | 29844 |

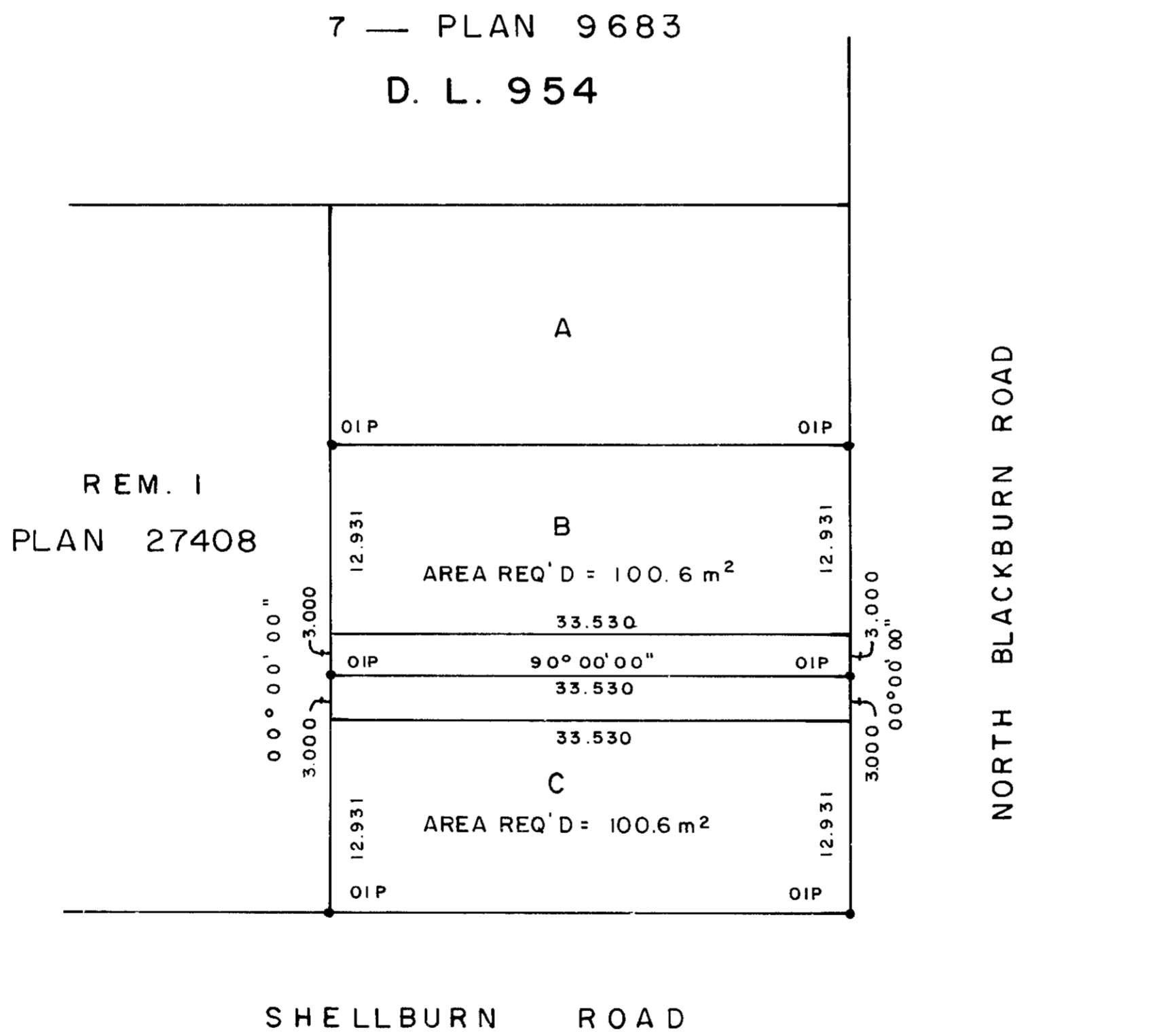

I, DONALD A. DUFFY, a British Columbia Land
 Surveyor, of Prince George, in British Columbia,
 certify that I was present at and did personally
 superintend the survey represented by this plan,
 and that the survey and plan are correct. The
 survey was completed on the 20 day of JAN
 1982.

This plan lies within the Fraser- Fort George
 Regional District.

W. D. USHER & ASSOCIATES
 LAND SURVEYORS
 PRINCE GEORGE — B.C.