

EXPLANATORY PLAN OF  
 STATUTORY RIGHT-OF-WAY FOR MUNICIPAL PURPOSES THROUGH  
 LOT 6, PLAN 22369  
 DISTRICT LOT 2433  
 CARIBOO DISTRICT — BRITISH COLUMBIA

SCALE: 1 : 500

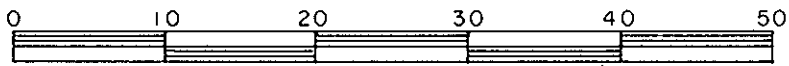

NOTE: Bearings are astronomic, derived from Plan 22369.

PLAN No. 775 L  
28903

Deposited in the Land Title Office at Prince George, B.C. this 29 day of December, 1982.

E.J. RAVEN  
 Registrar



LOT 7 -- PLAN 9394

13.250  
 00° 11' 15"

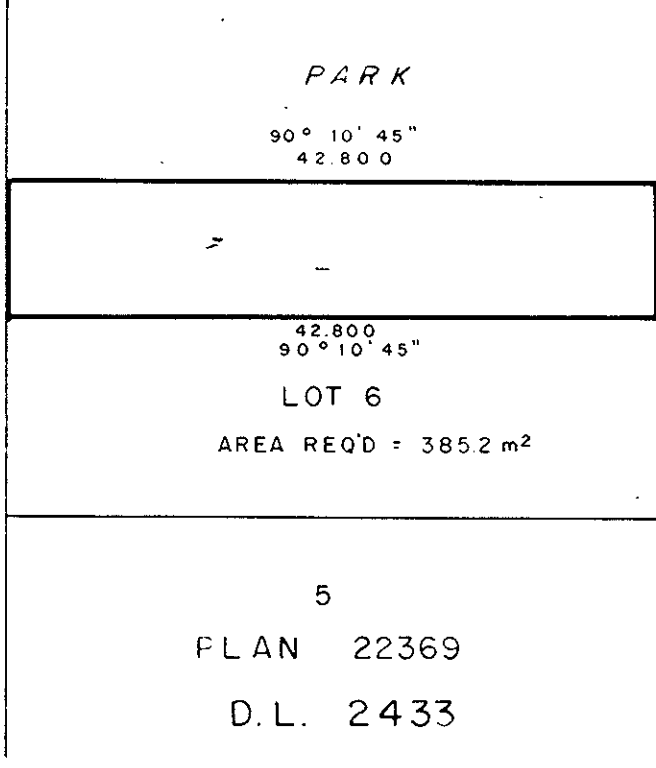

13.250  
 00° 10' 45"

DRIVE

OPAL

CERTIFIED CORRECT

According to measurements shown on Plan 22369.  
 This 29 day of November, 1982.

[Signature]  
 D. A. DUFFY, B.C.L.S.

W.D. USHER & ASSOCIATES  
 LAND SURVEYORS  
 PRINCE GEORGE — B.C.