

PLAN OF SUBDIVISION OF PART OF
 LOT 1, PLAN 19398
 DISTRICT LOT 954
 CARIBOO DISTRICT - BRITISH COLUMBIA

N M
 PLOTTED

SCALE: 1 : 1000

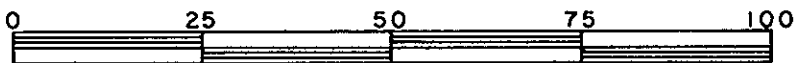

PLAN No 28482
 Deposited in the Land Title
 Office at Prince George, B.C. this
16 day of July, 1982.

NOTE: Bearings are astronomic, derived from the
 east boundary of Lot 1, Plan 19398.

LEGEND: • OIP denotes an old iron pin found.
 • IP denotes an iron pin set.

E. J. R.
 Registrar

N.E. 1/4 D.L. 954

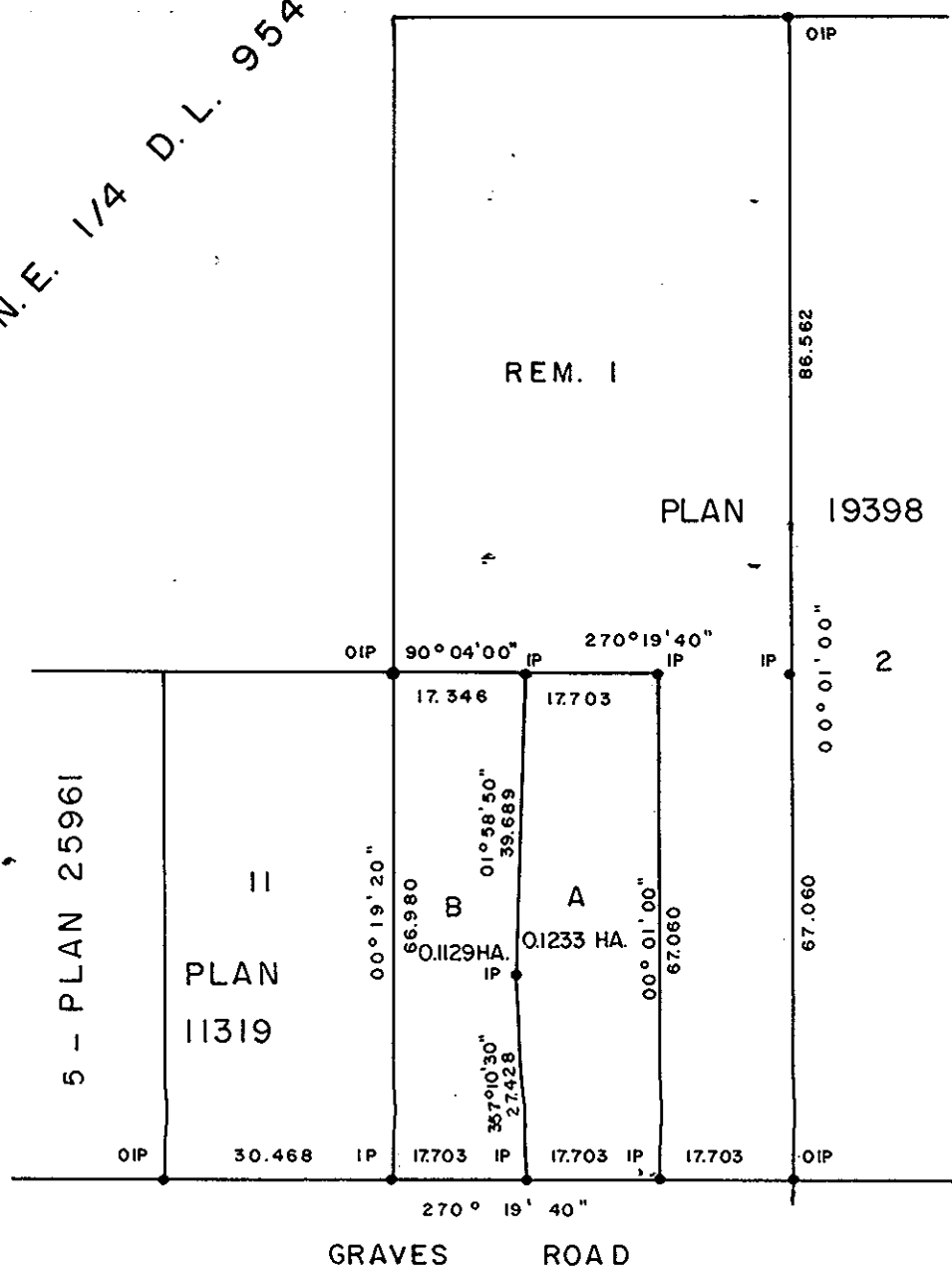

PLAN 9683 - D.L. 954

Owner [Signature]
 Witness [Signature]
D.A. DUFFY

Approved under the Land Title Act
 this 2 day of JULY, 1982

I, DONALD A. DUFFY, a British Columbia Land
 Surveyor, of Prince George, in British Columbia,
 certify that I was present at and did personally
 superintend the survey represented by this plan,
 and that the survey and plan are correct. The
 survey was completed on the 22nd day of April,
 1982.

Owner [Signature]
 Witness [Signature]
D.A. DUFFY

C. E. Oest
 Approving Officer, City of Prince George

This plan lies within the Fraser-Fort George
 Regional District.

W. D. USHER & ASSOCIATES
 LAND SURVEYORS
 PRINCE GEORGE - B.C.
 MN 74-75 13338