

26-FF-226

EXPLANATORY PLAN OF
 BUILDING LEASE AND PARKING EASEMENT AREAS
 LOTS 18 & 19, BLOCK 60, PLAN 752
 DISTRICT LOT 937
 CARIBOO DISTRICT - BRITISH COLUMBIA
 SCALE: 1 : 250

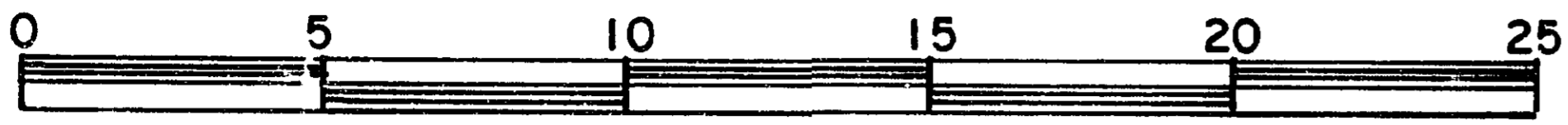

NOTE: Bearings are astronomic, derived from Plan 18409.
 Lot dimensions are derived from Plan 752.
 Parking easement areas are shown hatched.

PLAN No **28472**

Deposited in the Land Title
 Office at Prince George, B.C. this
13th day of July, 1982

"E.J. Raven" per gr
 Registrar

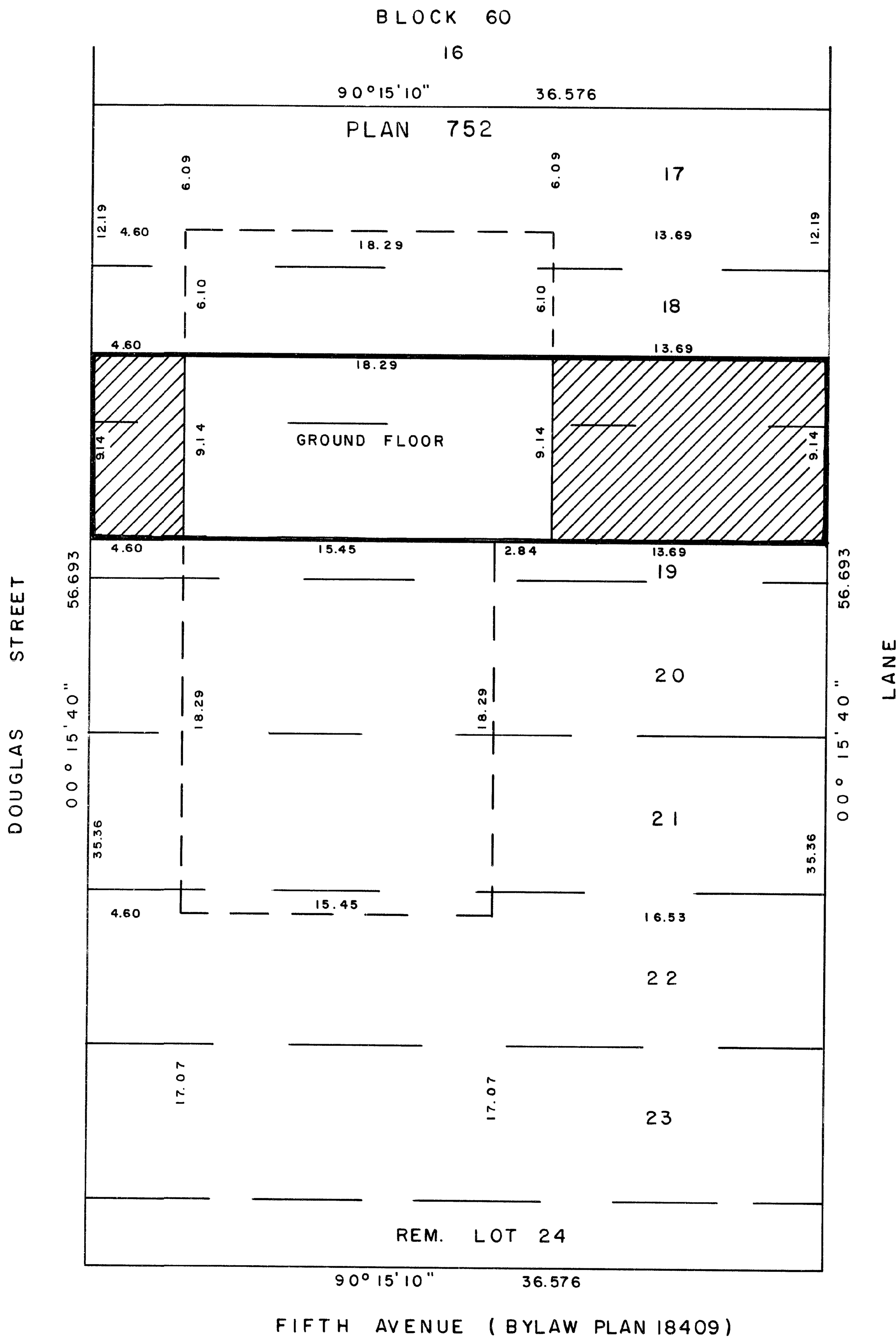

CERTIFIED CORRECT
 This 30th day of June, 1982.

D. A. DUFFY, B.C.L.S.

W. D. USHER & ASSOCIATES
 LAND SURVEYORS
 PRINCE GEORGE - B.C.
 13431