

26226

EXPLANATORY PLAN OF
 STATUTORY RIGHT-OF-WAY FOR MUNICIPAL UTILITIES THROUGH
 LOT 38, PLAN 15556 AND
 LOTS 96 & 97, PLAN 22369
 DISTRICT LOT 2433
 CARIBOO DISTRICT— BRITISH COLUMBIA
 SCALE: 1 : 1000

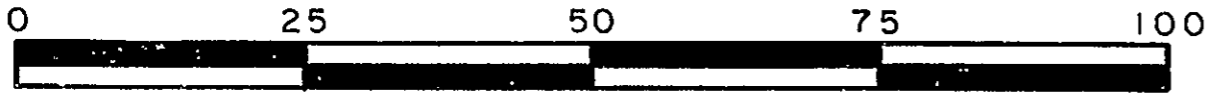

NOTE : Bearings are astronomic, derived from the east boundary of Lot 96, Plan 22369.

PLAN No 28032
 Deposited in the Land Title Office at Prince George, B.C. this 13 day of Jan., 1982

E. J. Raven
 Registrar *per: Sp.*

BOOK OF REFERENCE

PARCEL	AREA REQ'D
LOT 38, PLAN 15556, D.L. 2433	0.1303 HA.
LOT 96, PLAN 22369, D.L. 2433	48.77 m ²
LOT 97, PLAN 22369, D.L. 2433	335.3 m ²

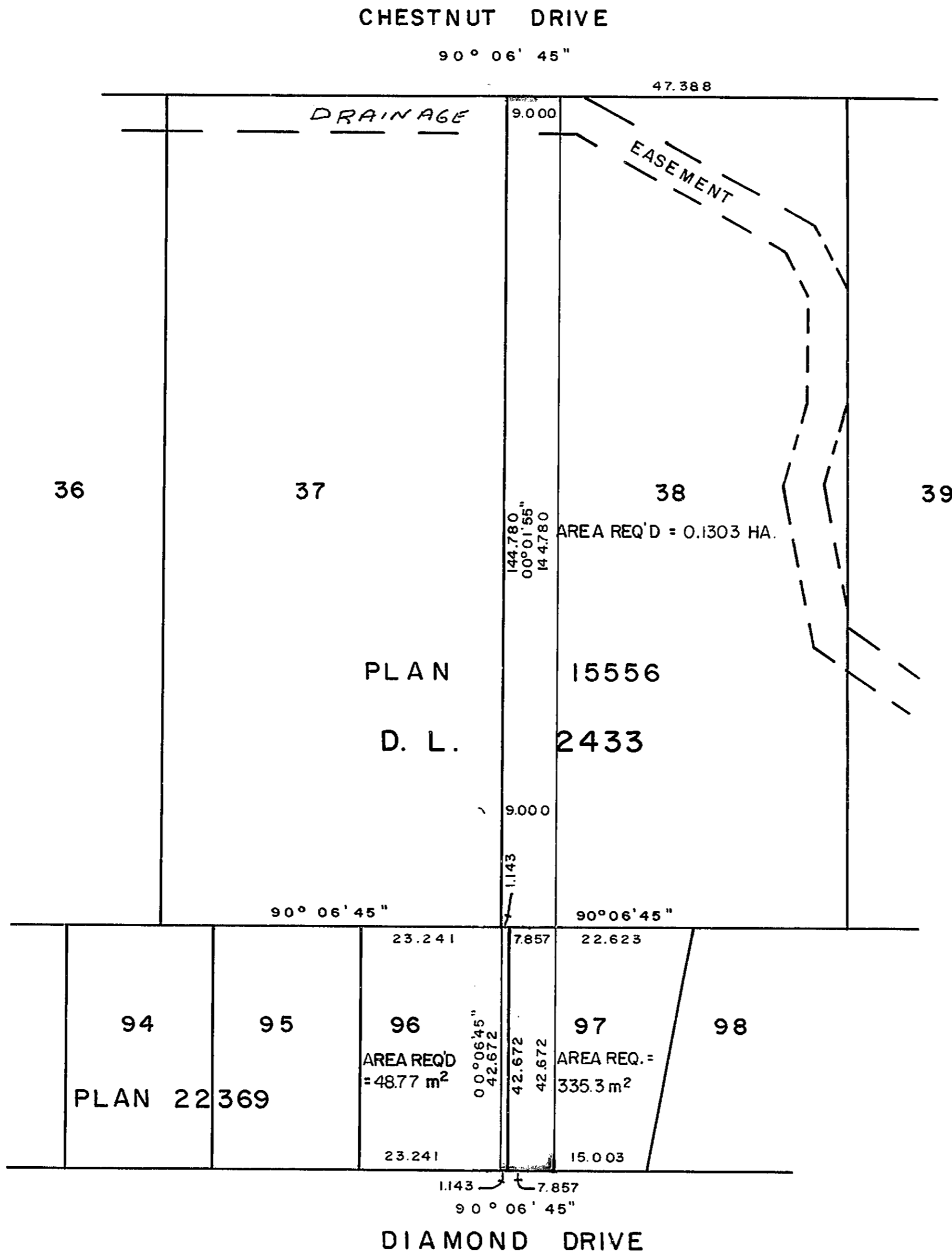

CERTIFIED CORRECT
 According to Plan of record in the
 Prince George Land Title Office.
 This 16 day of SEPT., 1981.

[Signature]
 D. A. DUFFY, B.C.L.S.

This plan lies within the Fraser-Fort George Regional District.

W. D. USHER & ASSOCIATES
 LAND SURVEYORS
 PRINCE GEORGE — B. C.
 13059