

PLAN OF SUBDIVISION OF PART OF  
S. E. 1/4 D. L. 954 (PLAN B-1643)  
CARIBOO DISTRICT - BRITISH COLUMBIA

*Plotted (GM)*

SCALE: 1 : 1000

NOTE: Bearings are astronomic, derived from the  
easterly boundary of Lot 1, Plan 11319.

LEGEND: •OIP denotes an old iron pin found.  
•IP denotes an iron pin set.

*25415*

PLAN N<sup>o</sup> \_\_\_\_\_

Deposited in the Land Registry  
Office at Prince George, B.C. this  
*31* day of *Oct*, 1979

*"E. J. Raven"*  
Registrar

Approved by: THE ROYAL TRUST COMPANY

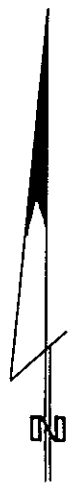
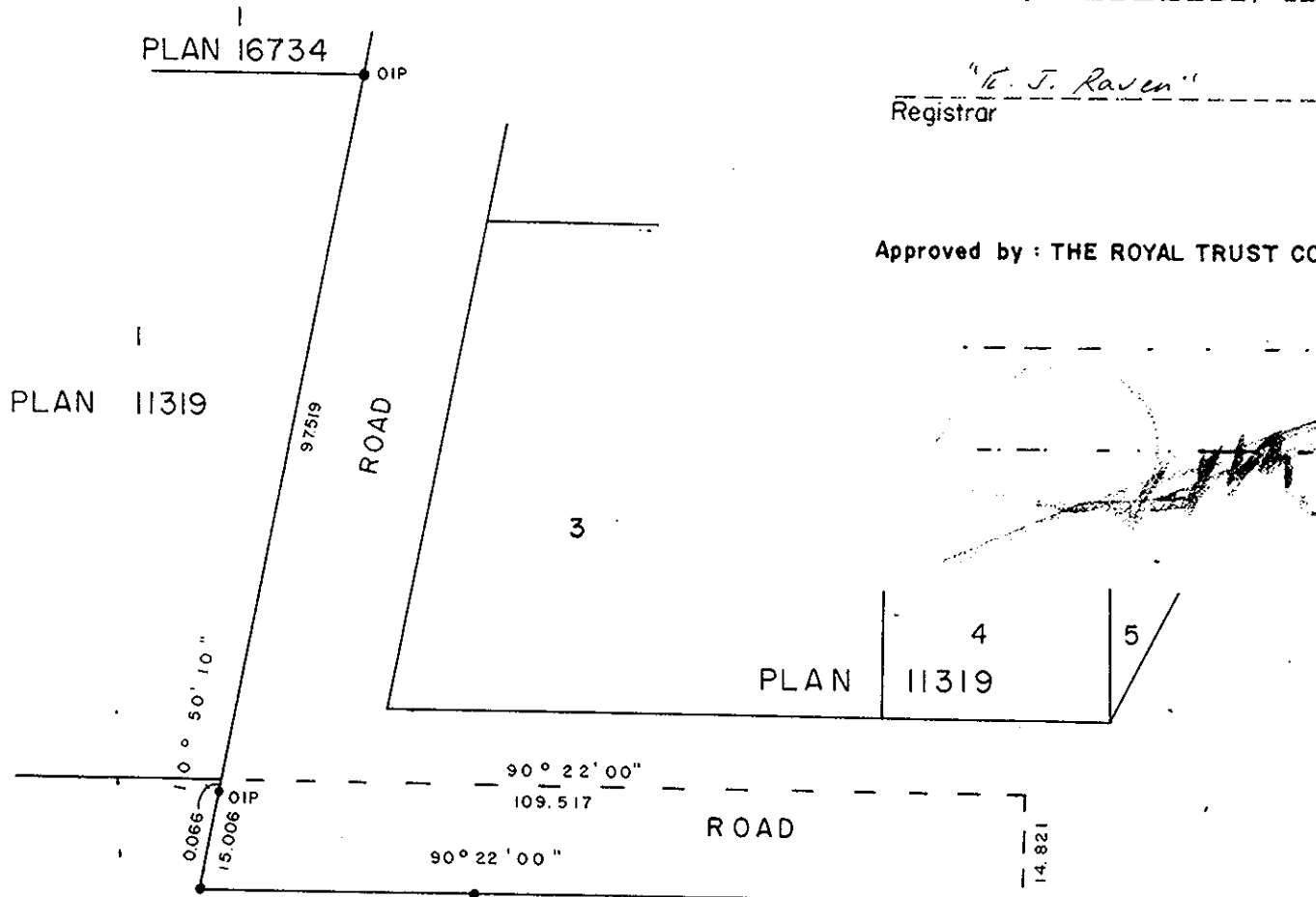

*[Handwritten signature]*

Approved by: INLAND NATURAL GAS CO. LTD.

*[Handwritten signature]*  
V.P. - M.P.S.  
*[Handwritten signature]*  
SUCSY

S.E. 1/4  
D.L. 954  
(PLAN B-1643)

A  
0.813 HA

PART OF  
S.E. 1/4  
D.L. 954

YELLOWHEAD HIGHWAY 16 R/W, PLAN

Owner \_\_\_\_\_

Witness \_\_\_\_\_

I, DONALD A. DUFFY of the City of Prince George,  
a British Columbia Land Surveyor, make oath and say  
that I was present at and did personally superintend  
the survey represented by this plan and that the survey  
and plan are correct. The said survey was completed  
on the *15* day of *OCT*, 1979

*[Handwritten signature]*  
B.C.L.S.

Sworn before me this *16*  
day of *OCT*, 1979

*[Handwritten signature]*  
A Commissioner for taking Affidavits  
for British Columbia.

Approved under the Land Registry Act  
this *23* day of *OCT*, 1979

*[Handwritten signature]*  
Approving Officer, City of Prince George

This plan lies within the Fraser-Fort George  
Regional District.