

PLAN OF SUBDIVISION OF
 BLOCK A
 S.W. 1/4 D.L. 2100
 CARIBOO DISTRICT - BRITISH COLUMBIA

SCALE: 1" = 100'

NOTE: Bearings are astronomic, derived from the west boundary of Block A, S.W. 1/4 D.L. 2100.

LEGEND: • OPP denotes an old pipe post found.
 • OIP denotes an old iron pin found.
 • IP denotes an iron pin set.

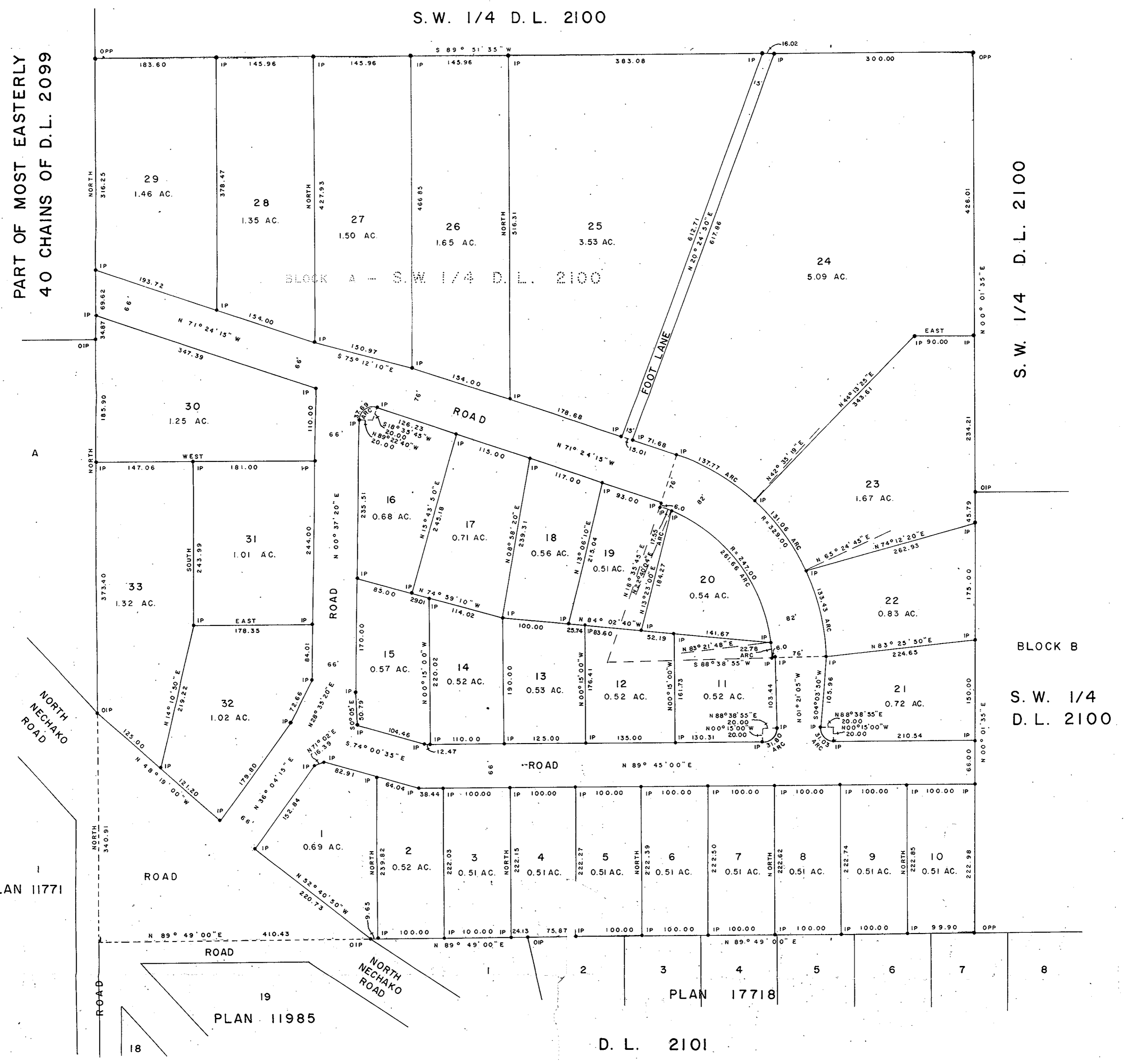

I. Toombs & Sons Homes Ltd.,
 PP. _____
 Owner _____
 Witness _____
 Pres. _____

I, DONALD A. DUFFY, of the City of Prince George, a British Columbia Land Surveyor, make oath and say that I was present at and did personally superintend the survey represented by this plan and that the survey and plan are correct. The said survey was completed on the 18 day of Sept., 1973.

[Signature]
 B.C.L.S.

Sworn before me this 18 day of Sept., 1973.

[Signature]
 A Commissioner for taking Affidavits for British Columbia.

I hereby certify that the lands within this plan were not zoned for agricultural or farm use under a by-law subsisting immediately prior to the 21st of December 1972, of a municipality or regional district.

[Signature]
 Date: 16th Oct. 1973
 Approving Officer - Dept. of Highways

Approved under the Land Registry Act this 16th day of October, 1973.

[Signature]
 Approving Officer, Dept. of Highways

This plan lies within the Fraser-Fort George Regional District.