



City of Prince George History Sheet

| | |
|--------|-----------|
| PID: | 030600901 |
| | 030600910 |
| SD/MU: | |
| WO: | |

Civic Address: 7639, 7645 Creekside Way

Legal Description: SL 1 & SL 2 District Lot: 2014 Plan: EPS5332

| Service Type | Diameter (mm) | Material | Invert Elev at main (m) | Invert Elev at property line (m) | Invert Depth at service end (m) | Distance into property (m) | Installation Date |
|---------------|---------------|----------|-------------------------|----------------------------------|---------------------------------|----------------------------|-------------------|
| Sanitary (S1) | 100mm | PVC | 582.28 | 583.41 | 2.47 | - | September 2010 |
| Sanitary (S2) | 100mm | PVC | 582.29 | 583.48 | 2.43 | - | September 2010 |
| Water (W1) | 20mm | Copper | 583.72 | 583.16 | 2.72 | - | September 2010 |
| Water (W2) | 20mm | Copper | 583.70 | 582.98 | 2.93 | - | September 2010 |
| Storm (D1) | 100mm | PVC | 582.52 | 583.50 | 2.38 | - | September 2010 |
| Storm (D2) | 100mm | PVC | 582.42 | 583.49 | 2.42 | - | September 2010 |

| Service Connection Location | | | | Sanitary (m) | Storm (m) |
|---------------------------------|---|-------------------------|---|--------------|-----------|
| Distance from downstream San MH | - | towards upstream San MH | - | - | |
| Distance from downstream Stm MH | - | towards upstream Stm MH | - | | |

| Power | Size | Communications | Size | Cable | Size | Gas | Size |
|---------------------|----------|---------------------|----------|---------------------|------|----------|--------------|
| BC Hydro | 75mm DB2 | Telus | 50mm DB2 | Shaw | - | FortisBC | 42 PROP/P.E. |
| Underground Service | | Underground Service | | Underground Service | | | |

| | | | |
|---------------|---------------------|--------------|---|
| Installed by: | Fortwood Homes Ltd. | Survey Date: | - |
| Comments: | | | |
| | | | |
| | | | |

NOT TO SCALE The information contained herein is for internal use only.
Not to be relied on unless confirmed by site inspection and/or investigation.

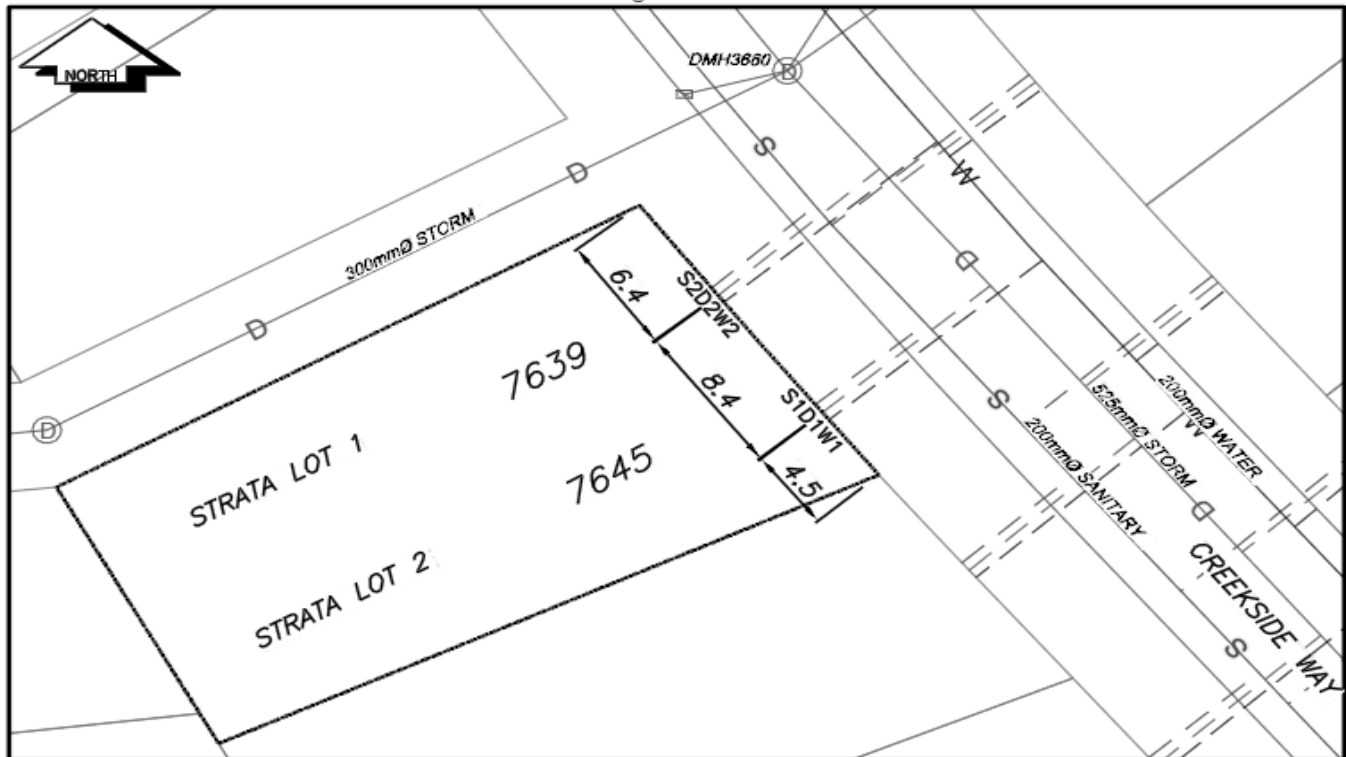

| | | | | | |
|----|-------------|-----|------------------|-----|---------------|
| CS | CURB STOP | --- | WATER SERVICE | --- | STORM SERVICE |
| CO | CLEAN OUT | --- | SANITARY SERVICE | --- | GAS |
| WV | WATER VALVE | --- | FIRE HYDRANT | --- | ENCUMBRANCE |

NOT TO SCALE