



City of Prince George
History Sheet

PID:	030130298
SD/MU:	
WO:	

Civic Address: 1098, 1104 Harper St

Legal Description: Lot: Parcel C District Lot: 1489 Plan: 40534

Service Type	Diameter (mm)	Material	Invert Elev at main (m)	Invert Elev at property line (m)	Invert Elev at service end (m)	Distance into property (m)	Installation Date
Sanitary (1098)	100mm	PVC	-	-	-	-	January 1960
Sanitary (1104)	100mm	PVC	-	-	-	-	January 1960
Water (1098)	20mm	Copper	-	-	-	-	January 1960
Water (1104)	20mm	Copper	-	-	-	-	January 1960
Storm	N/A	N/A	-	-	-	-	

Service Connection Location				Sanitary (m)	Storm (m)
Distance from downstream San MH	3059	towards upstream San MH	3054	1.80	
Distance from downstream San MH	3059	towards upstream San MH	3054	6.00	

Power	Size	Communications	Size	Cable	Size	Gas	Size
BC Hydro	-	Telus	-	Shaw	-	FortisBC	-
Underground Service		Underground Service		Underground Service			

Installed by: Survey Date: -

Comments:

NOT TO SCALE The information contained herein is for internal use only.
Not to be relied on unless confirmed by site inspection and/or investigation.

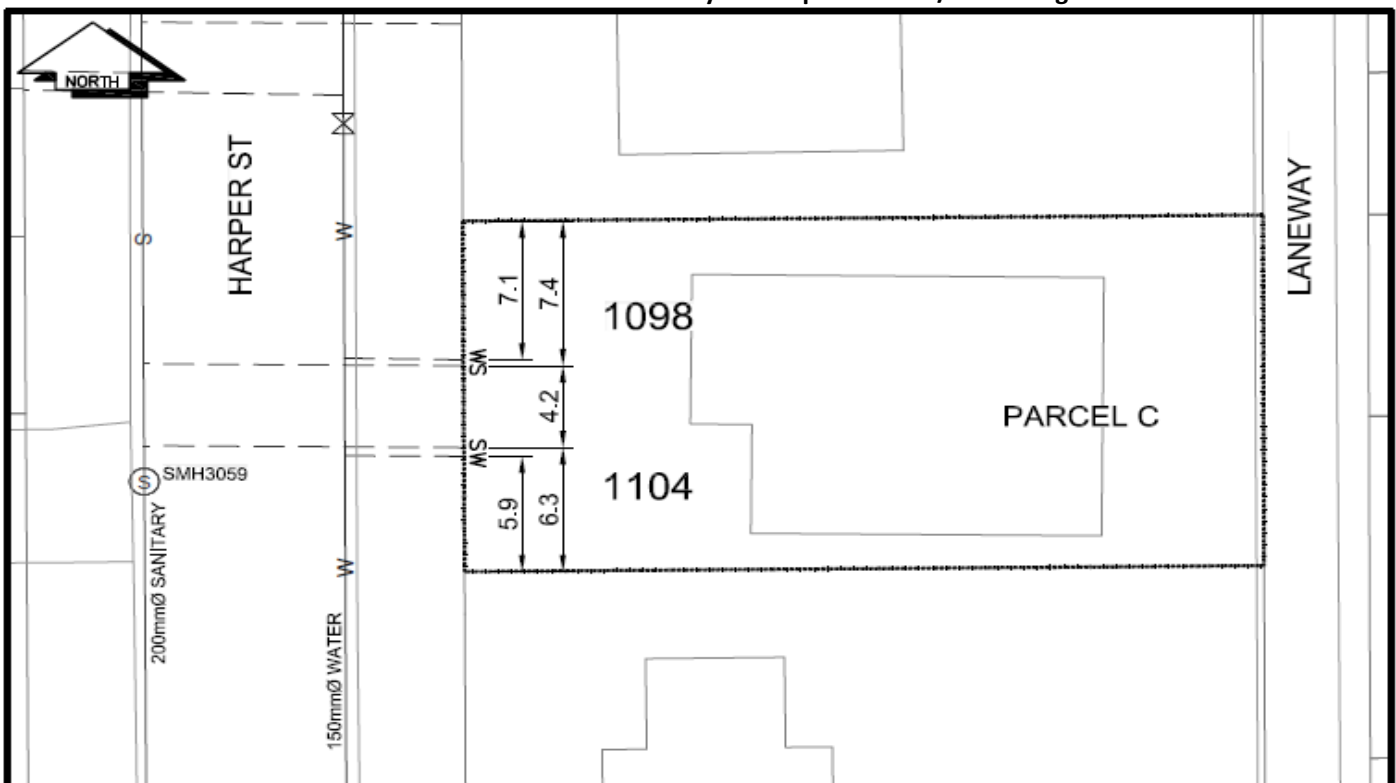

CS	CURB STOP	---	W	WATER SERVICE	---	O	STORM SERVICE
CO	CLEAN OUT	---	S	SANITARY SERVICE	---	G	GAS
WV	WATER VALVE	---	FH	FIRE HYDRANT	---	---	ENCUMBRANCE

NOT TO SCALE