



City of Prince George History Sheet

PID:	029818150
MU:	101891
WO:	97102

Civic Address: 1710 5th Ave

Legal Description: Lot: PCL B Block: 156 District Lot: 343 Plan: 1268

Service Type	Diameter (mm)	Material	Invert Elev at main (m)	Invert Elev at property line (m)	Invert Elev at service end (m)	Distance into property (m)	Installation Date
Sanitary	100mm	PVC	-	577.12	2.01	-	December 1955
Water	40mm	Copper	576.96	-	576.83	-1.50	August 2018
Storm	200mm	PVC	-	577.55	-	-	

Service Connection Location				Sanitary (m)	Storm (m)
Distance from downstream San MH	1995	towards upstream San MH	2702	18.26	
200mm Storm service connected to Recharge chamber					

Power	Size	Communications	Size	Cable	Size	Gas	Size
BC Hydro	-	Telus	-	Shaw	-	FortisBC	-
Overhead Service		Overhead Service		Overhead Service			

Installed by:	City of Prince George forces	Survey Date:	-
Comments:	Existing 12mm water service decommissioned and new 40mm water installed in same trench		

NOT TO SCALE The information contained herein is for internal use only.
Not to be relied on unless confirmed by site inspection and/or investigation.

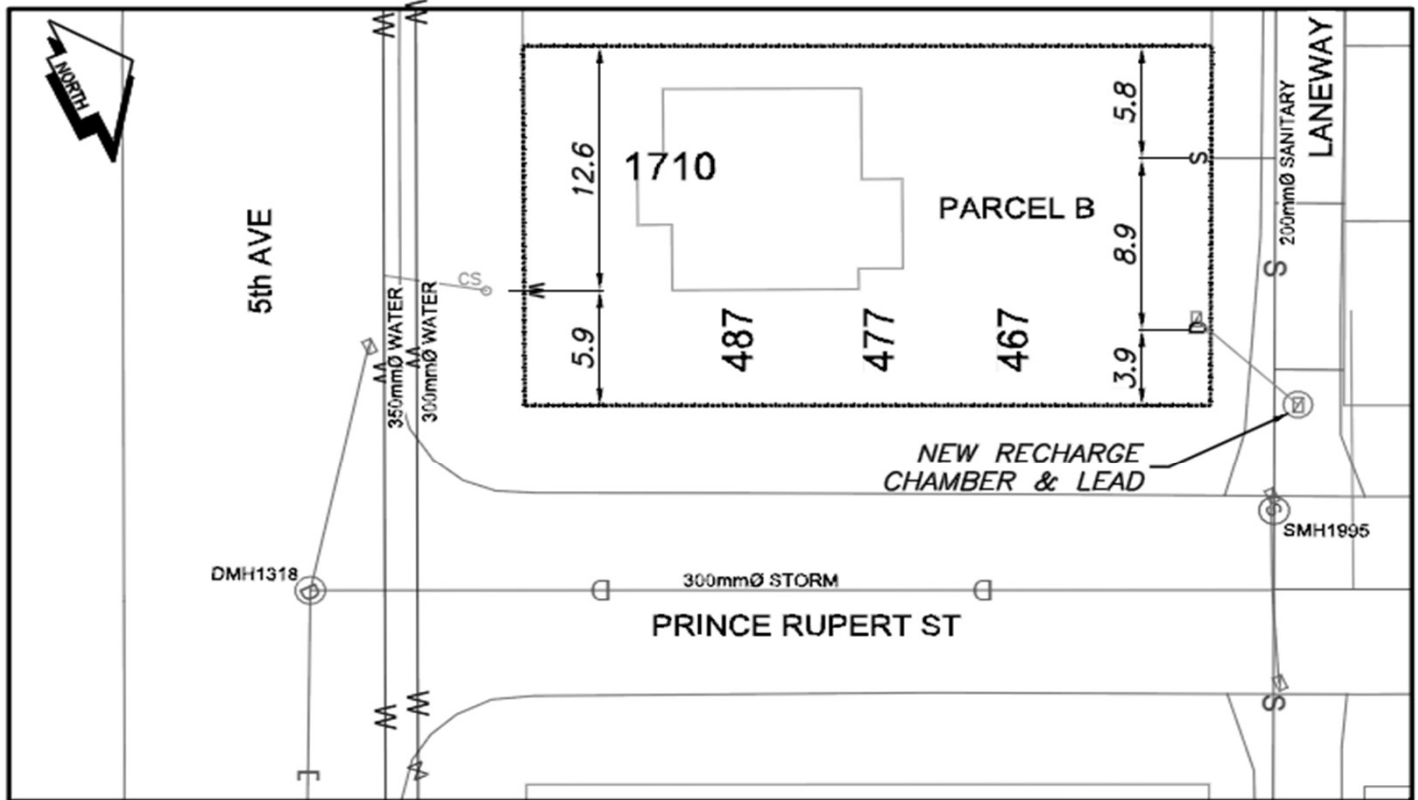

CS	CURB STOP	W	WATER SERVICE	S	SANITARY SERVICE	G	GAS
CO	CLEAN OUT	---	ENCUMBRANCE	+	FIRE HYDRANT		
V	WATER VALVE						

NOT TO SCALE