

City of Prince George

HISTORY SHEET

PID: ~~XXXXXX~~ 005276276 028512481 Scale: 1:500
 Legal: LOT 1 D.L.: 1599 PLAN: ~~36155~~ EPP9554

Address: 7060 EUGENE ROAD

Sanitary Connection:#	SIZE:	100mmØ	MATERIAL:	PVC	INV.	745.08m	CONNECTED
Water Connection:#	SIZE:	19mmØ	MATERIAL:	COPPER	INV.	N/A	CONNECTED
Storm Connection:#	SIZE	100mmØ	MATERIAL	PVC	INV.	745.07m	CONNECTED
Cash Receipt No's:	WATER		SANITARY		STORM		
CURB FROM PROPERTY LINE	5.0m					PAVEMENT WIDTH	10.0m
HYDRO	75mm BD2	U/G CONNECTION				✓	
TELEPHONE	50mm BD2	U/G CONNECTION				✓	
GAS	42 PROP /P.E						

Information Sheets: L&M ENGINEERING LTD REFERENCE DRAWINGS - 1313-06-04-C001

Comments: CS CURB STOP SDW WATER SERVICE HYDRO SERVICE GAS GAS
 CO CLEAN OUT STORM SERVICE CABLE SERVICE TELECOMMUNICATIONS E ELECTRICAL
 SANITARY SERVICE

**THE INFORMATION CONTAINED HEREIN IS FOR INTERNAL USE ONLY.
 NOT TO BE RELIED UPON UNLESS CONFIRMED BY THE SITE INSPECTION AND/OR INVESTIGATION**

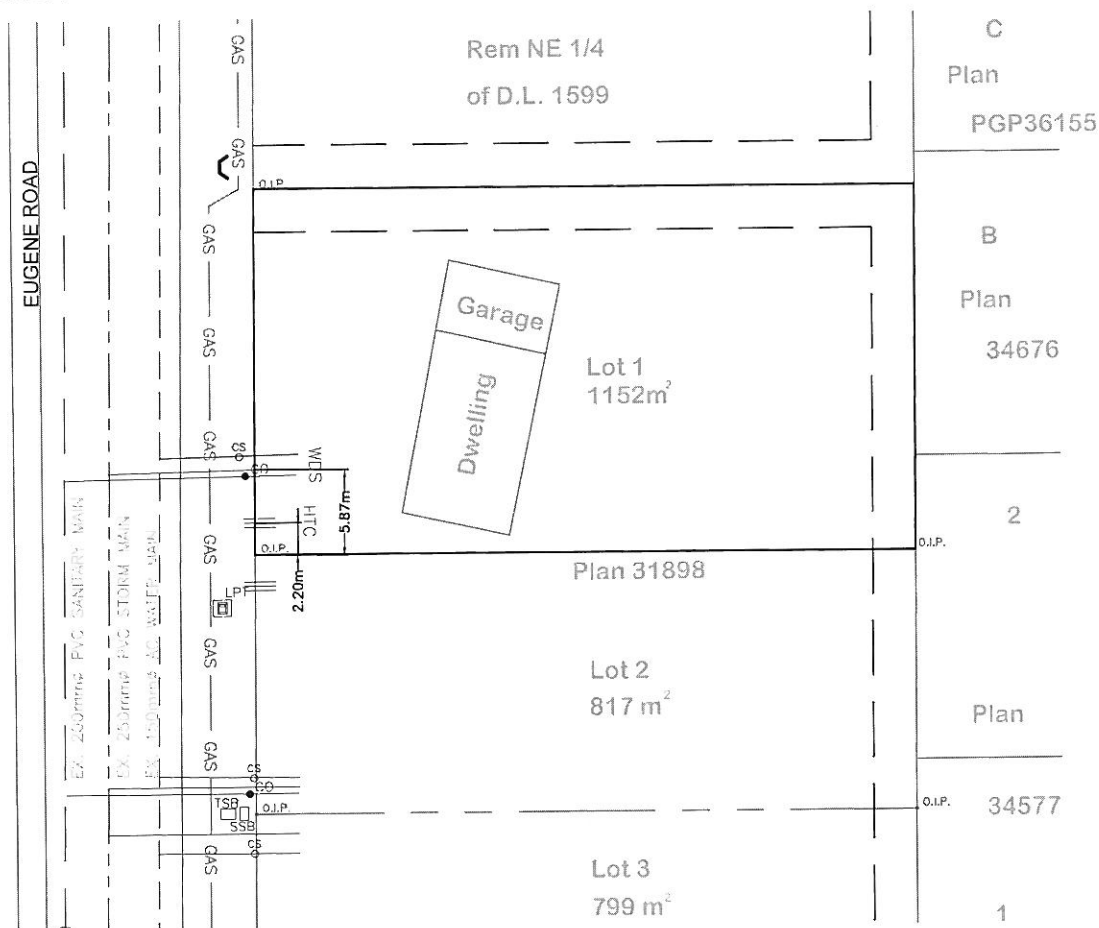

SANITARY, STORM & WATER SERVICE INVERTS	SANITARY	WATER	STORM
1. Distance from San. M.H. <u>4927</u> toward San. M.H. <u>4926</u> to lot service connection point is:	31.31m	N/A	N/A
1a. Distance from Stm. M.H. <u>3436</u> toward Stm. M.H. <u>3435</u> to lot service connection point is:	N/A	N/A	33.07m
2. Main Size at connection point is	200mmØ	150mmØ	250mmØ
3. Invert of main at conn. stub point is	744.47m	-	744.27m
4. Invert at service end is	744.47m	-	745.07m
5. Cover at property line in meters	1.71m	-	1.69m
6. Survey Date <u>NOV 2010</u> Book Ref.: <u>HELENE ASBUILTS</u> By: <u>FORESIGHT SURVEY AND DESIGN</u>			

SANITARY HISTORY:

DATE INSTALLED: SEPTEMBER 2010

INSTALLED BY: WESTERN INDUSTRIAL CONTRACTORS

WATER HISTORY:

DATE INSTALLED: -

INSTALLED BY: -

STORM HISTORY:

DATE INSTALLED: SEPTEMBER 2010

INSTALLED BY: WESTERN INDUSTRIAL CONTRACTORS