



# Lot Services Sketch

PID: 028038878

Civic Address: 604 BOUNDARY RD

Legal Description: Lot: 1 District Lot: 749 Plan: BCP41575

Service Type	Diameter (mm)	Material	Invert Elev @ Main (m)	Invert Elev @ Property Line (m)	Invert Elev @ Service End (m)	Distance into Property (m)	Installation Date
Sanitary	N/A	-	-	-	-	-	-
Water	150	AC	-	-	-	-	JAN 1979
Storm	N/A	-	-	-	-	-	-

Sanitary Service Connection Location Notes	Storm Service Connection Location Notes
Distance from downstream SMH #: N/A	Distance from downstream DMH #: N/A
Distance to upstream SMH #: N/A	Distance to upstream DMH #: N/A

Miscellaneous Utilities			
Power	Communications	Cable	Gas
BC Hydro	TELUS	Shaw Cable	FortisBC
Overhead Service	Overhead Service	Overhead Service	Underground Service

<b>Installation By:</b> Unknown	<b>Draft Date:</b> OCT 2024	<b>Survey Date:</b> N/A
---------------------------------	-----------------------------	-------------------------

<b>Comments:</b>
Water Service is ~178.5m West from the South East corner of Lot 1.

**NOT TO SCALE** The information contained herein is for internal use only.  
**Not to be relied on unless confirmed by site inspection and/or investigation.**

**SEE PAGE 2 FOR SKETCH.**

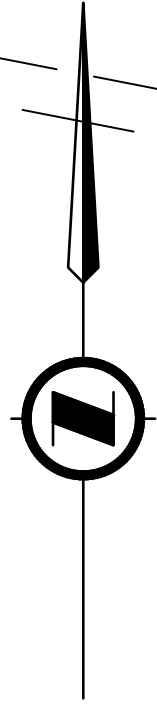

ENCUMBRANCE: BCP7676

LOT 1

ENCUMBRANCE: 20524

ENCUMBRANCE: BCP10776

PLOT DATE: 2024-10-23 C:\Data\Civil\3D Projects\11552024\Boundary\_Rd\604\_Boundary\_Rd.dwg

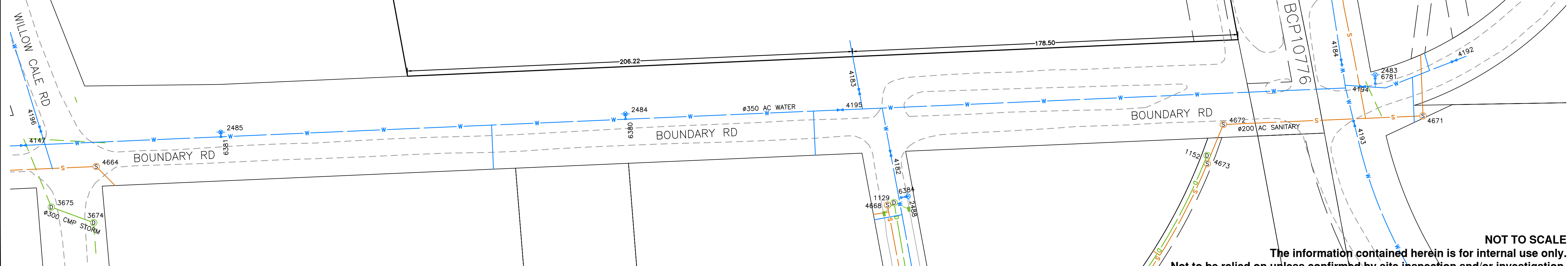

**LEGEND**

- SANITARY GRAVITY MAIN
- STORM GRAVITY MAIN
- WATER PRESSURIZED MAIN
- SANITARY SERVICE LINE
- STORM SERVICE LINE / CATCH BASIN LEAD
- WATER SERVICE LINE / HYDRANT LEAD
- PROPERTY LINE
- ENCUMBRANCE
- ROAD EDGE
- SANITARY CLEAN-OUT
- STORM CLEAN-OUT
- WATER CURB-STOP
- WATER SYSTEM VALVE
- FIRE HYDRANT



REV	DATE	REVISIONS	DR
1	24-10-23	SERVICE SKETCH	BK

**CIVIC ADDRESS:**  
604 BOUNDARY RD

**LEGAL DESCRIPTION:**  
LOT: 1  
BLOCK:  
DISTRICT LOT: 749  
PLAN: BCP41575

DRAWING No.  
**h-028038878**

SHEET No. 2 of 2  
REV. No. 1

**NOT TO SCALE**  
The information contained herein is for internal use only.  
Not to be relied on unless confirmed by site inspection and/or investigation.