



City of Prince George History Sheet

PID:	027557499
MU:	100503
WO:	

Civic Address: 2609 Vance Road
4001 Hollandia Drive

Legal Description: Lot: B District Lot: 753 Plan: BCP36526

Service Type	Diameter (mm)	Material	Invert Elev at main (m)	Invert Elev at property line (m)	Invert Elev at service end (m)	Distance into property (m)	Installation Date
Sanitary	100mm	PVC	-	-	-	-	January 1976
Water	20mm	Copper	-	-	-	-	January 1978
Storm	N/A	N/A	-	-	-	-	

Service Connection Location				Sanitary (m)	Storm (m)
Distance from downstream San MH	3587	towards upstream San MH	3582	28.58	
Distance from downstream Stm MH	3732	towards upstream Stm MH	-		

Power	Size	Communications	Size	Cable	Size	Gas	Size
BC Hydro	-	Telus	-	Shaw	-	FortisBC	-
Underground Service		Underground Service		Underground Service			

Installed by:	Survey Date:	-
Comments:	Water service location confirmed October 2016.	

NOT TO SCALE The information contained herein is for internal use only.
Not to be relied on unless confirmed by site inspection and/or investigation.

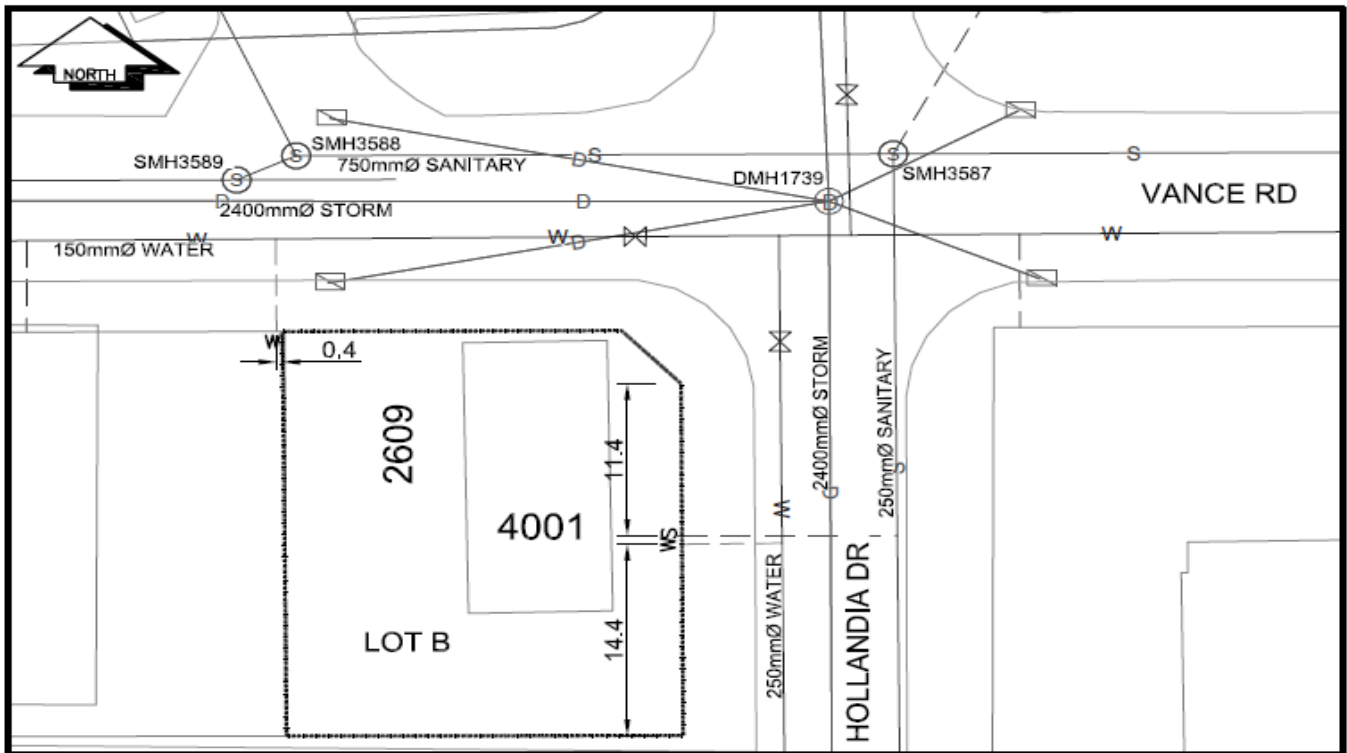

CS CURB STOP	--- W WATER SERVICE	--- S SANITARY SERVICE	--- D STORM SERVICE	--- G GAS
CO CLEAN OUT				

NOT TO SCALE