

# CITY OF PRINCE GEORGE HISTORY SHEET

PID 026784700

ROLL NUMBER: #

SHEET No. #

LEGAL: LOT A BLOCK

DL 8180  
CARIBOO DISTRICT

PLAN BCP25328

ADDRESS: 2990 RECPLACE DRIVE

SANITARY CONNECTION: SIZE:  $\phi$  200 PVC DR35 INV. 586.957 CONNECTEDWATER CONNECTION: FROM MAIN:  $\phi$  200 DUCTILE IRON INV. 586.048 METER:STORM CONNECTION: SIZE:  $\phi$  600 STEEL ULTRA FLO INV. 587.366 CONNECTED

CASH RECEIPT No: # WATER - SANITARY - STORM

CURB FROM PROPERTY LINE: 3.8m

PAVEMENT WIDTH 12.4m

B.C. HYDRO: -

U/G CONNECTION

B.C. TELEPHONE -

U/G CONNECTION

B.C.GAS -

INFORMATION SHEETS: -

COMMENTS: -

THE INFORMATION CONTAINED HEREIN IS FOR EXTERNAL USE ONLY  
NOT TO BE RELIED UPON UNLESS CONFIRMED BY THE INSPECTION AND/OR INVESTIGATION

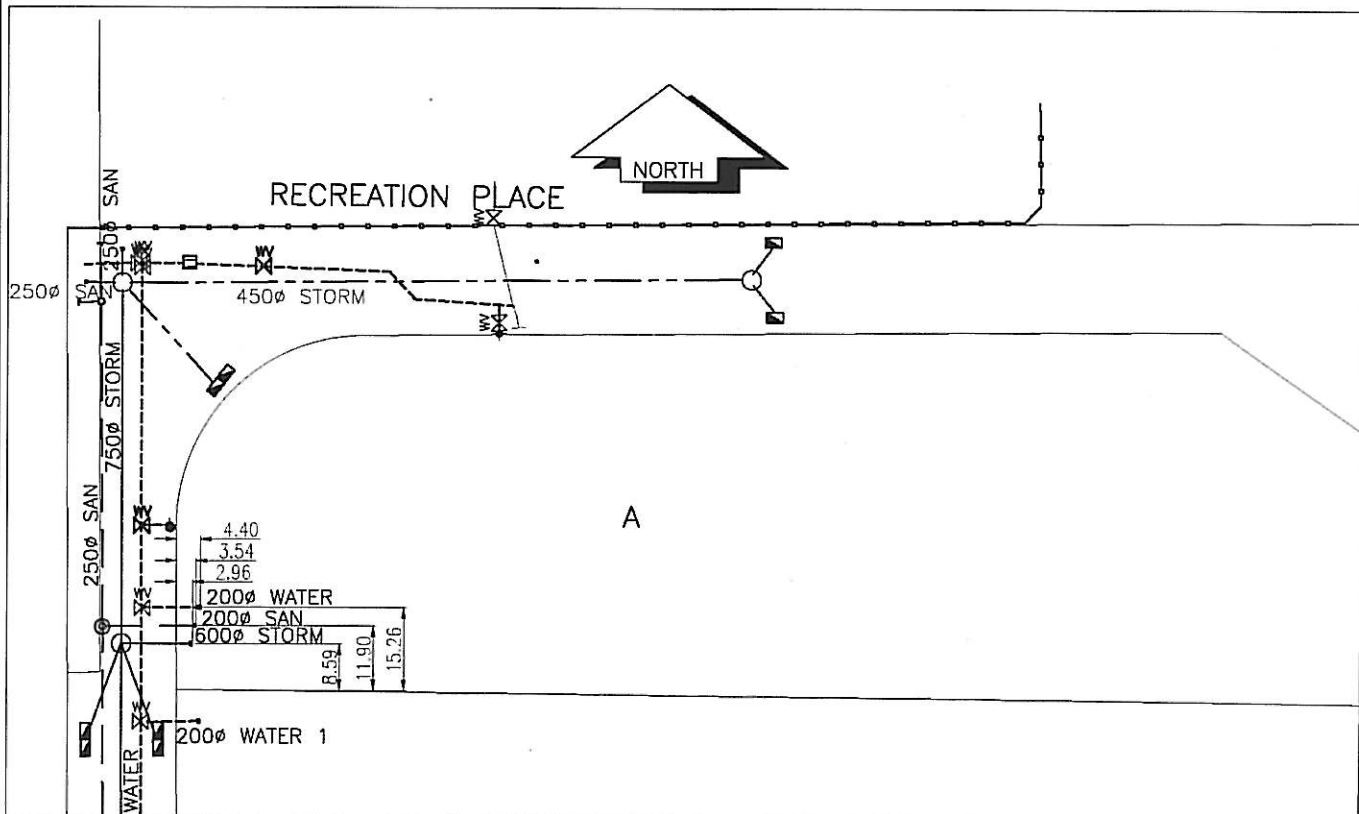

# CITY OF PRINCE GEORGE HISTORY SHEET SANITARY & STORM INVERT CALCULATIONS

1. Distance from M.H. to connection point is	m toward M.H.	SANITARY	WATER	STORM
2. Calculated invert of main to connection point is				
3. Main Size at connection point is	mm			
4. Conn. Invert at half diameter (Crown) of main is				
5. Add to (4) allowance of 0.2 for 1/8 bend. Adjusted invert now				
6. Dist. from main to P/L equals	m at	m/m gives rise of		
7. Item (5) plus (6) equals Calculated Elev. of conn. inv. at P/L equals				
13. Elev of ref. hub top				
14. Elev. of invert at P/L line		586.957m	586.048m	587.366m
15. Difference or cut below at property line		2.690m	3.592m	2.339m
16. Survey date <u>JUNE 2007</u> Book Ref by				
17. Cut at P/L in metres				

## Sanitary History:

INSTALLED IN 2006

## Water History:

INSTALLED IN 2006

## Storm History:

INSTALLED IN 2006