



# City of Prince George History Sheet

PID:	025748246
SD/MU:	
WO:	

Civic Address: 5777, 5787 Albert Pl

Legal Description: Lot: 1 District Lot: 754 Plan: BCP7518

Service Type	Diameter (mm)	Material	Invert Elev at main (m)	Invert Elev at property line (m)	Invert Elev at service end (m)	Distance into property (m)	Installation Date
Sanitary (S1)	100mm	PVC	-	-	-	-	January 1978
Sanitary (S2)	100mm	PVC	63708.00	637.30	-	-	January 1978
Water	50mm	Copper	-	-	-	-	January 1980
Storm	200mm	PVC	637.16	63732.00	-	-	January 1980

Service Connection Location	Sanitary (m)	Storm (m)
100mm Sanitary service connected to San MH3766	-	-
100mm Sanitary service connected to San MH3766	-	-
200mm Storm service connected to Stm MH 431	-	-

Power	Size	Communications	Size	Cable	Size	Gas	Size
BC Hydro	-	Telus	-	Shaw	-	FortisBC	-
Overhead Service		Overhead Service		Overhead Service			

Installed by:	City of Prince George forces	Survey Date:	-
Comments:			

**NOT TO SCALE** The information contained herein is for internal use only.  
Not to be relied on unless confirmed by site inspection and/or investigation.

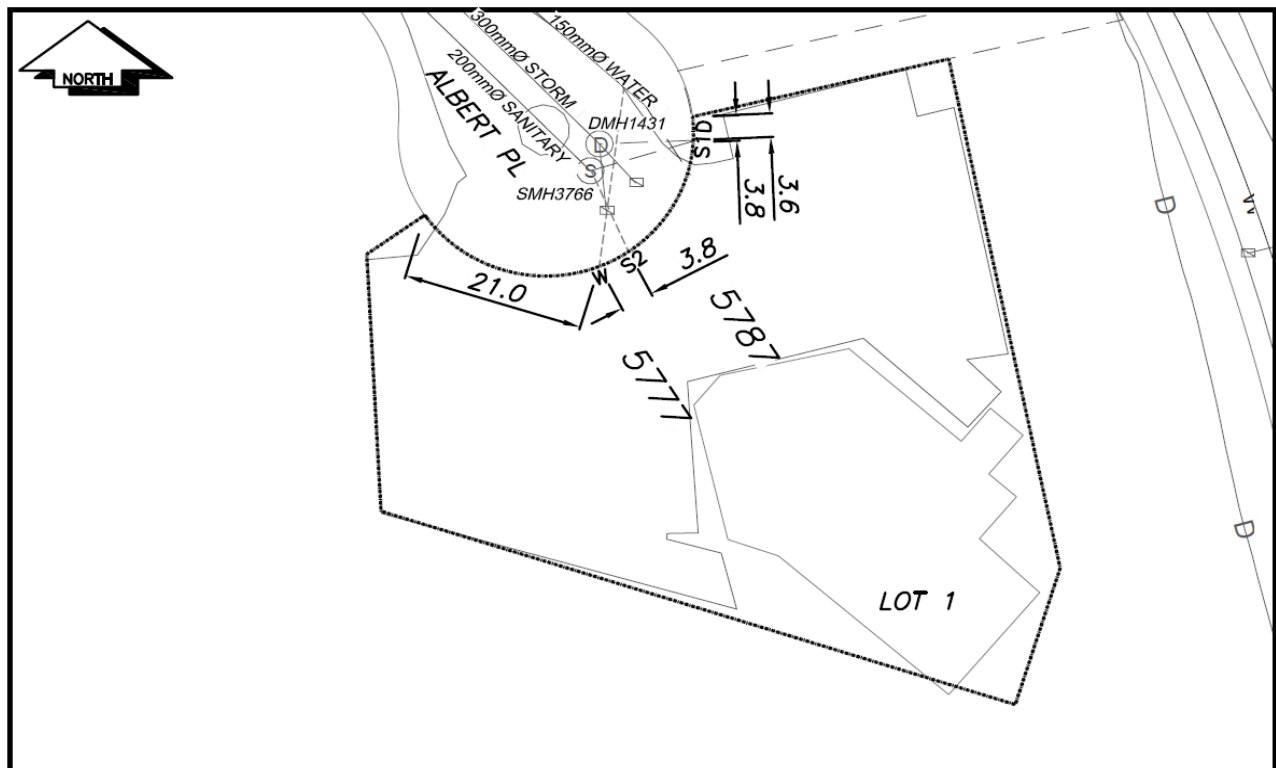

CS	CURB STOP	—	WATER SERVICE	—	STORM SERVICE
CO	CLEAN OUT	- - -	SANITARY SERVICE	—G—	GAS
⊗	WATER VALVE	—	FIRE HYDRANT	- - - -	ENCUMBRANCE

**NOT TO SCALE**