



CITY OF  
PRINCE GEORGE

Civic Address: 1810 3rd Ave

Legal Description: Parcel D (PS040297) Block: 48 District Lot: 343 Plan: 1268

Lot Services Sketch

PID:

025197380

Service Type	Diameter (mm)	Material	Invert Elev @ Main (m)	Invert Elev @ Property Line (m)	Invert Elev @ Service End (m)	Distance into Property (m)	Installation Date
Sanitary	100	PVC	-	-	-	-	1957
Water	50	PVC	578.685	-	-	14.2	2022
Storm	200	PVC	-	-	-	-	1960

Sanitary Service Connection Location Notes	Storm Service Connection Location Notes
Distance from downstream SAN MH #2696: 21.69M	Distance from downstream STM MH #: N/A
Distance to upstream SAN MH #: N/A	Distance to upstream STM MH #: N/A

Miscellaneous Utilities			
Power	Communications	Cable	Gas
BC Hydro	TELUS	Shaw Cable	FortisBC
Overhead Service	Overhead Service	Overhead Service	Underground Service

Installation By:	WATER INSTALLED BY COPG 2022	Draft Date:	-	Survey Date:	-
Comments: WATER SERVICE INSULATED WITH RIGID INSULATION					
Storm Sevice is ±7.0m Northwest from the Southeast corner of PCL D Water Service is ±12.0m Northwest from Southeast corner of PCL D					
Sanitary Service -s ±16.1m Northwest of the Southeast corner of PCL D. MU#100113					

**NOT TO SCALE The information contained herein is for internal use only.**  
**Not to be relied on unless confirmed by site inspection and/or investigation.**

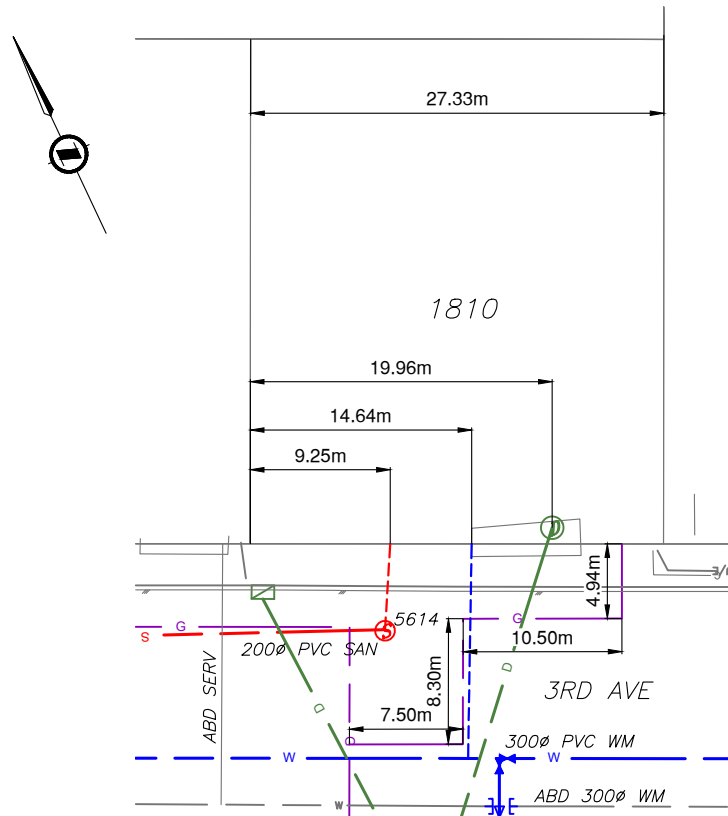

	WATER SERVICE AND CURB STOP (CS)		G	UNDERGROUND GAS LINE
	WATER HYDRANT LEAD, VALVE, HYDRANT		W	WATER MAIN
	SANITARY SERVICE AND CLEAN OUT (CO)		S	SANITARY MAIN
	STORM SERVICE		D	STORM MAIN
	ROAD EDGE			ENCUMBRANCE