

City of Prince George HISTORY SHEET

SHEET NUMBER 6 OF 18

ROLL NUMBER 023970006

Legal: LOT 6

BLK

D.L. 4048

PLAN PGP41855

Address: 4685 GRAY DRIVE

Sanitary Connection:# SIZE: 100mm \varnothing MATERIAL: PVC INV. 763.25m CONNECTEDWater Connection:# FROM MAIN: 19mm \varnothing COPPER METERStorm Connection:# SIZE 100mm \varnothing MATERIAL PVC INV. 763.22m CONNECTED

C Receipt No's: WATER SANITARY STORM

CURB FROM PROPERTY LINE 5.0m

PAVEMENT WIDTH 10.0m

B.C. HYDRO 75mm \varnothing DB2 U/G CONNECTIONB.C. TELEPHONE 50mm \varnothing PVC U/G CONNECTIONB.C. GAS 42mm \varnothing PE SDR10

Information Sheets: REF. DWGS. L&M ENGINEERING LTD. JOB. 1063-05-02

Comments: BENCH MARK: 86H-1856 766.416m

THE INFORMATION CONTAINED HEREIN IS FOR INTERNAL USE ONLY.

NOT TO BE RELIED UPON UNLESS CONFIRMED BY THE SITE INSPECTION AND/OR INVESTIGATION

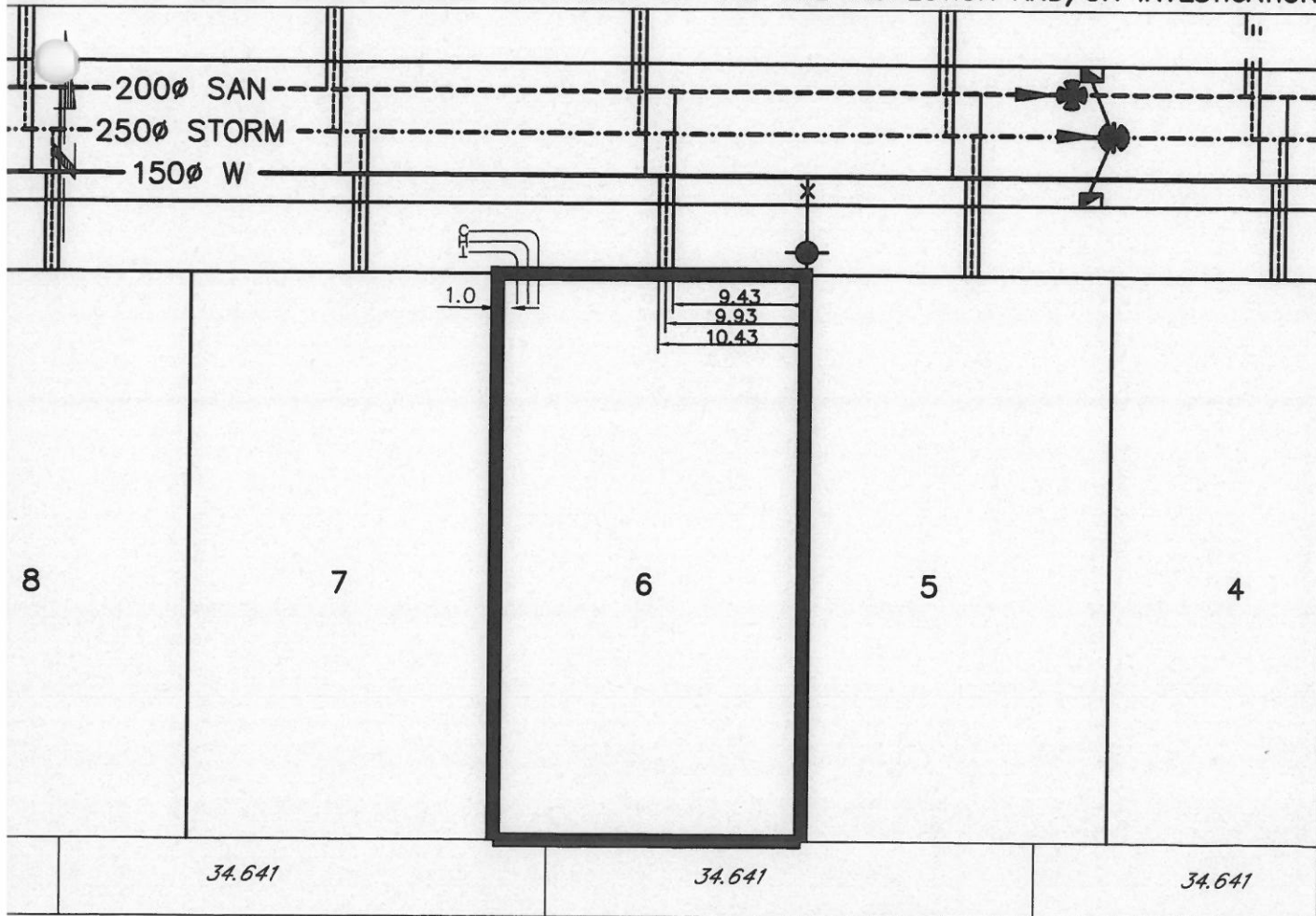

SANITARY & STORM INVERT CALCULATIONS			SANITARY	STORM
1. Distance from San. M.H. 4	to connection point is	toward San. M.H. 5	28.6	
1a. Distance from Strm. M.H. 4	to connection point is	toward Strm. M.H. 5		31.7
2. Calculated invert of main at conn. stub pt is			762.35	762.76
3. Main Size at connection point is			200mmØ	250mmØ
4. Conn. invert at half diameter (Crown) of main is			762.45	762.89
5. Add to (4) allowance of 0.2 for 1/8 bend adjusted invert now			N/A	N/A
6. Dist. from main to P/L equalsm at% gives rise of			13m @ 6.5% = 0.84m Rise	10m @ 3.9% = 0.39m Rise
7. Item (5) plus (6) equals Calculated Elev. of conn. inv. at P/L equals				
13. Elev. of ref. hub top				766.416
14. of invert at P/line			763.25	763.22
15. Difference of cut below at property line			2.29	2.33
16. Survey Date SEPT 19 97 Book Ref. N/A by V.G.				
17. Cut at P/line in feet and inches			7'6"	7'8"

This image shows a single sheet of white paper with horizontal blue or grey ruling lines. On the left edge, there is a circular punch hole, suggesting it was part of a binder or folder. The paper is otherwise blank, with no writing or markings.

This image shows a single sheet of white paper with horizontal blue or grey ruling lines. The lines are evenly spaced and run across the width of the page. There are approximately 20 lines visible. The paper appears to be a standard notebook page.
