

City of Prince George
HISTORY SHEET

SHEET NUMBER **3 OF 18** ROLL NUMBER **023969971**

Legal: **LOT 3** **BLK** **D.L. 4048** **PLAN 76P41855**

Address: **4649 GRAY DRIVE**

Sanitary Connection:# SIZE: **100mmØ** MATERIAL: **PVC** INV. **761.67m** CONNECTED

Water Connection:# FROM MAIN: **19mmØ COPPER** METER

Storm Connection:# SIZE **100mmØ** MATERIAL **PVC** INV. **761.65m** CONNECTED

Cash Receipt No's: WATER SANITARY STORM

CURB FROM PROPERTY LINE **5.0m** PAVEMENT WIDTH **10.0m**

B.C. HYDRO **75mmØ DB2** U/G CONNECTION

B.C. TELEPHONE **50mmØ PVC** U/G CONNECTION

B.C. GAS **42mmØ PE SDR10**

Information Sheets: REF. DWGS. L&M ENGINEERING LTD. JOB. 1063-05-02

Comments: BENCH MARK: **86H-1856 766.416m**

THE INFORMATION CONTAINED HEREIN IS FOR INTERNAL USE ONLY.

NOT TO BE RELIED UPON UNLESS CONFIRMED BY THE SITE INSPECTION AND/OR INVESTIGATION

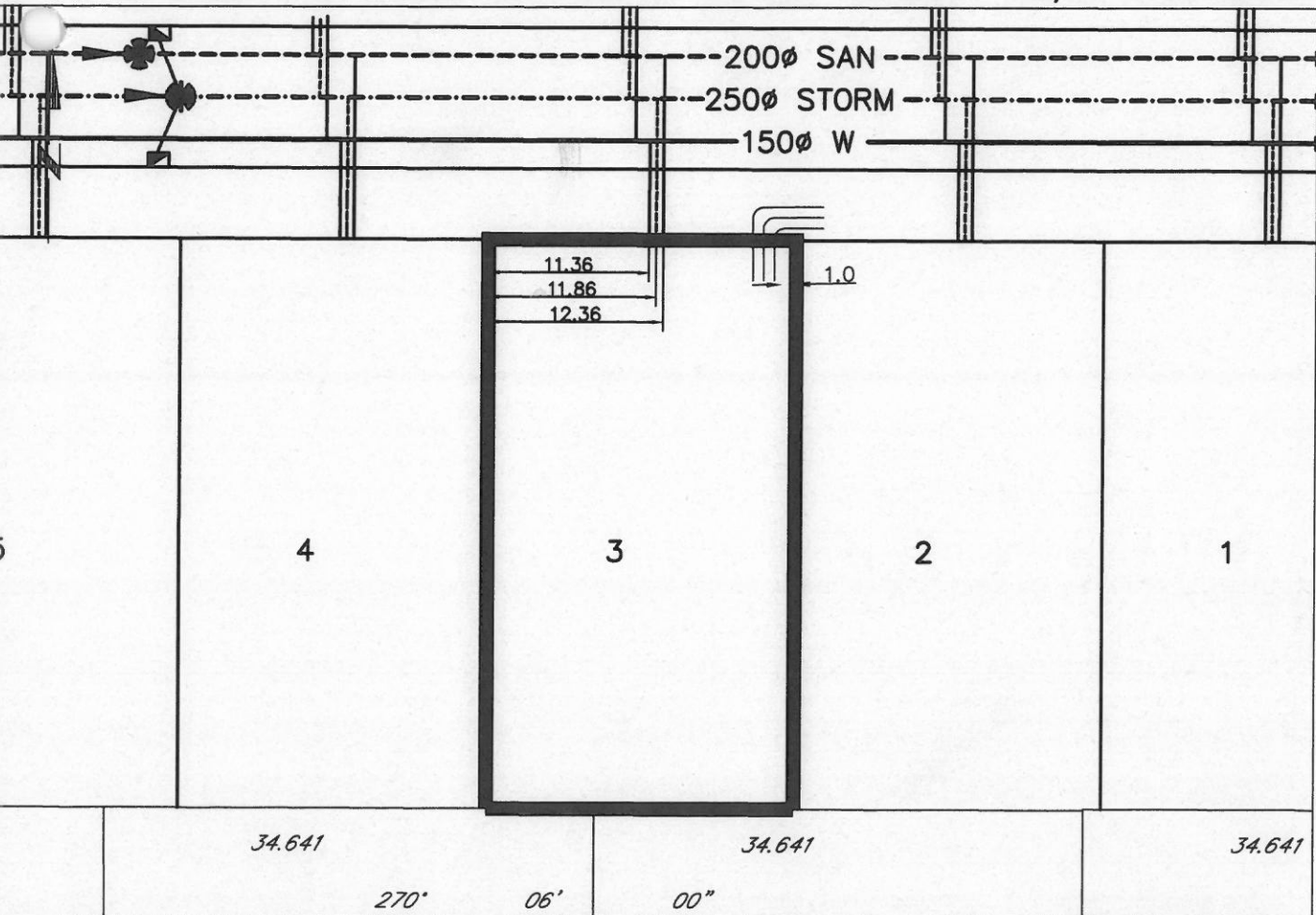

SANITARY & STORM INVERT CALCULATIONS	SANITARY	STORM
1. Distance from San. M.H. 4 to connection point is toward San. M.H. 3	36.7	
1a. Distance from Stm. M.H. 4 to connection point is toward Stm. M.H. 3		33.6
2. Calculated invert of main at conn. stub pt is	761.78	761.20
3. Main Size at connection point is	200mm ϕ	250mm ϕ
4. Conn. invert at half diameter (Crown) of main is	760.88	761.32
5. Add to (4) allowance of 0.2 for 1/8 bend adjusted invert now	N/A	N/A
6. Dist. from main to P/L equalsm at% gives rise of	13m @ 6.3% = 0.83m Rise	10m @ 3.7% = 0.37m Rise
7. Item (5) plus (6) equals Calculated Elev. of conn. inv. at P/L equals		
13. Elev. of ref. hub top		766.416
14. Elev. of invert at P/line	761.67	761.65
15. Difference of cut below at property line	2.26	2.38
16. Survey Date SEPT 19 97 Book Ref. N/A by V.G.		
17. Cut at P/line in feet and inches	7'5"	7'10"

Blank lined paper with a binder hole on the left.

This image shows a single sheet of white paper with horizontal blue or grey ruling lines, typical of notebook paper. The lines are evenly spaced and run across the width of the page. There is no handwriting or other markings on the paper.
