



City of Prince George
History Sheet

| | |
|--------|-----------|
| PID: | 023605324 |
| SD/MU: | |
| WO: | 79981 |

Civic Address: 4760 Continental Way

Legal Description: Lot: 1 District Lot: 745 Plan: PGP40699

| Service Type | Diameter (mm) | Material | Invert Elev at main (m) | Depth of Cut at property line (m) | Invert Elev at service end (m) | Distance into property (m) | Installation Date |
|--------------|---------------|----------|-------------------------|-----------------------------------|--------------------------------|----------------------------|-------------------|
| Sanitary | 100mm | PVC | - | 2.03 | 595.67 | - | October 1982 |
| Water | 40mm | Copper | - | - | - | - | August 2014 |
| Storm | 150mm | PVC | - | 1.80 | 595.41 | - | October 1982 |

| Service Connection Location | | | | Sanitary (m) | Storm (m) |
|---------------------------------|------|-------------------------|------|--------------|-----------|
| Distance from downstream San MH | 3684 | towards upstream San MH | 3683 | 82.30 | |
| Distance from downstream Stm MH | 1907 | towards upstream Stm MH | 1908 | - | 82.60 |

| Power | Size | Communications | Size | Cable | Size | Gas | Size |
|---------------------|------|---------------------|------|---------------------|------|----------|------|
| BC Hydro | - | Telus | - | Shaw | - | FortisBC | - |
| Underground Service | | Underground Service | | Underground Service | | | |

| | | |
|---------------|--------------|-----------------|
| Installed by: | Survey Date: | October 7, 1982 |
| Comments: | | |

NOT TO SCALE The information contained herein is for internal use only.
Not to be relied on unless confirmed by site inspection and/or investigation.

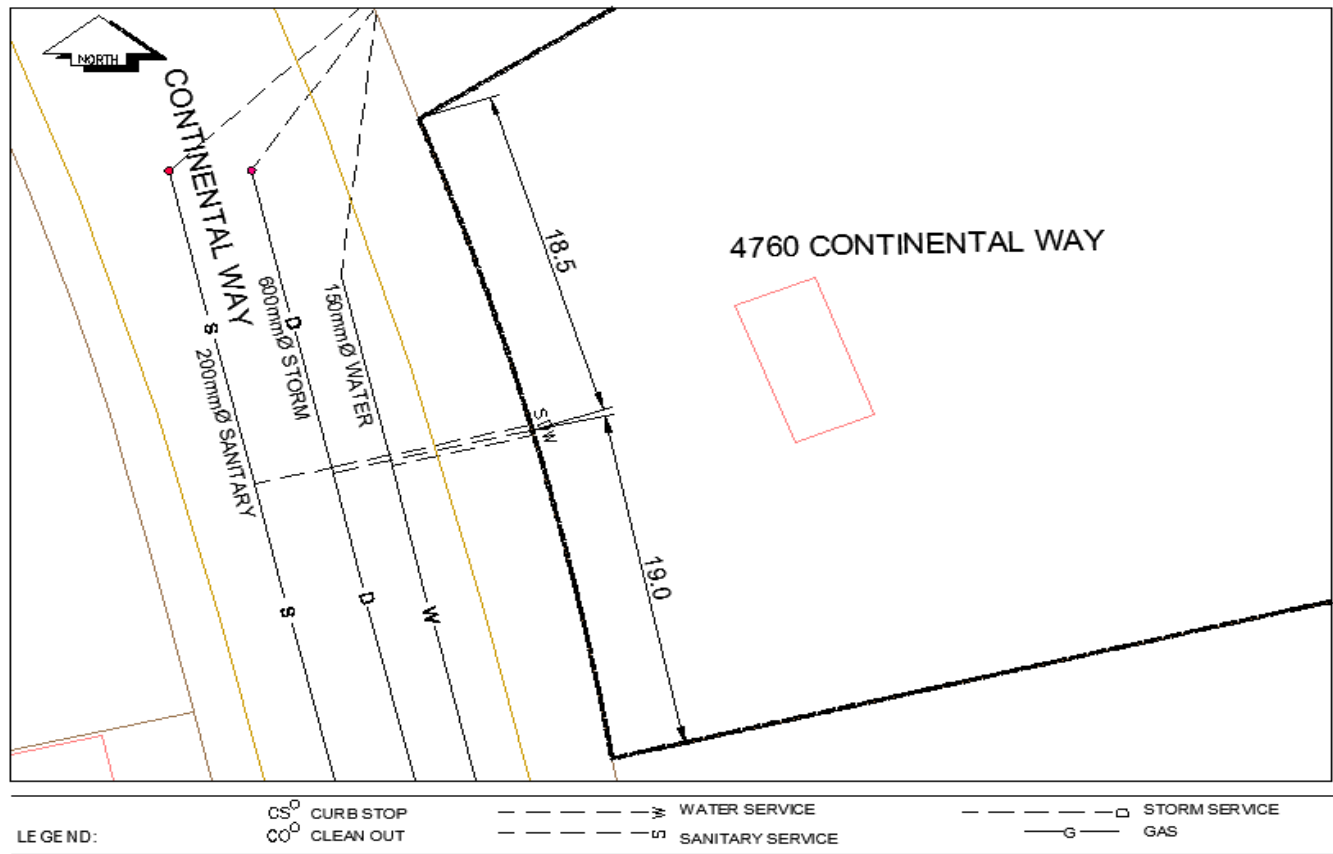

NOT TO SCALE