



City of Prince George History Sheet

PID:	015911969
MU:	101155
WO:	58476/5007622

Civic Address: 1811 Victoria St

Legal Description: Lot: A District Lot: 343 Plan: 34496

Service Type	Diameter (mm)	Material	Invert Elev at main (m)	Invert Elev at property line (m)	Invert Elev at service end (m)	Distance into property (m)	Installation Date
Sanitary	150mm	AC	-	-	571.27	-	September 1973
Water (W1)	32mm	Copper	-	-	-	-	June 1956
Water (W2)	100mm	PVC	570.62	-	-	-	December 2017
Storm	200mm	PVC	-	-	-	-	May 2011

Service Connection Location	Sanitary (m)	Storm (m)
150mm Sanitary service connected to San MH3288	-	
200mm Storm Service connected to CBMH in laneway		

Power	Size	Communications	Size	Cable	Size	Gas	Size
BC Hydro	-	Telus	-	Shaw	-	FortisBC	-
Underground Service		Underground Service		Underground Service			

Installed by:	Water(W2) and Storm installed by City of Prince George forces	Survey Date:	-
Comments:			

NOT TO SCALE The information contained herein is for internal use only.
Not to be relied on unless confirmed by site inspection and/or investigation.

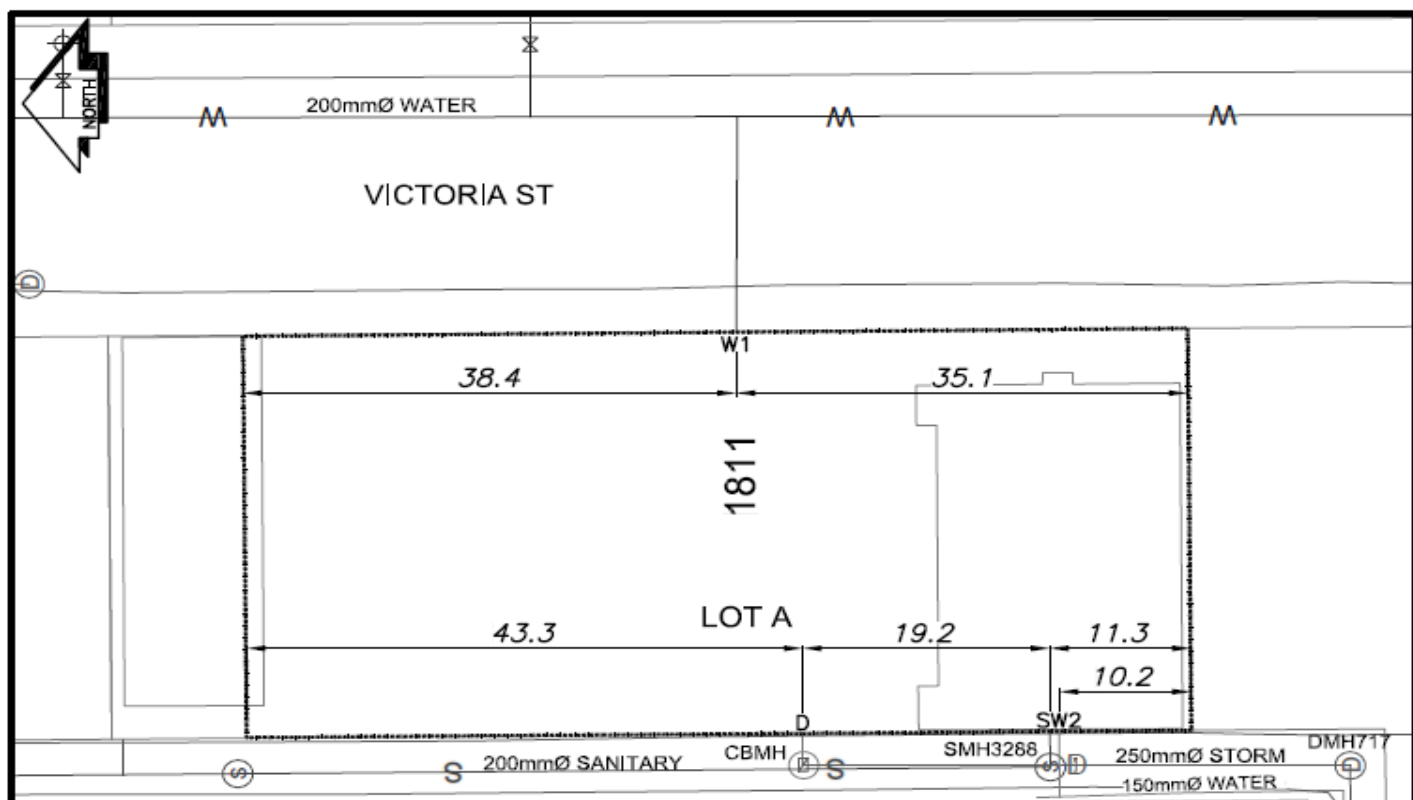

CS ^o CURB STOP	— — — — — WATER SERVICE	— — — — — STORM SERVICE
CO ^o CLEAN OUT	— — — — — SANITARY SERVICE	— — — — — GAS
⊗ WATER VALVE	⊗ FIRE HYDRANT	— — — — — ENCUMBRANCE

NOT TO SCALE