



# City of Prince George History Sheet

PID:	013276972
MU:	101377
WO:	71307

Civic Address: 2731/2733 Vance Rd

Legal Description: Lot: 37 District Lot: 753 Plan: 8391

Service Type	Diameter (mm)	Material	Invert Elev at main (m)	depth of cut at property line (m)	Invert Elev at service end (m)	Distance into property (m)	Installation Date
West Sanitary	100mm	PVC	-	2.26	591.08	-	November 1977
East Sanitary	100mm	PVC	-	-	-	-	June 2013
West Water	20mm	Copper	-	-	-	-	November 1977
East Water	20mm	Copper	-	-	-	-	June 2013
Storm	N/A	N/A	-	-	-	-	

Service Connection Location				Sanitary (m)	Storm (m)
Distance from downstream San MH	3575	towards upstream San MH	3576	91.20	
Distance from downstream San MH	3575	towards upstream San MH	3576	104.60	
Distance from downstream Stm MH	-	towards upstream Stm MH	-		

Power	Size	Communications	Size	Cable	Size	Gas	Size
BC Hydro	-	Telus	-	Shaw	-	FortisBC	-
Overhead Service		Overhead Service		Overhead Service			

Installed by:	City of Prince George forces	Survey Date:	-
Comments:			

**NOT TO SCALE** The information contained herein is for internal use only.  
Not to be relied on unless confirmed by site inspection and/or investigation.

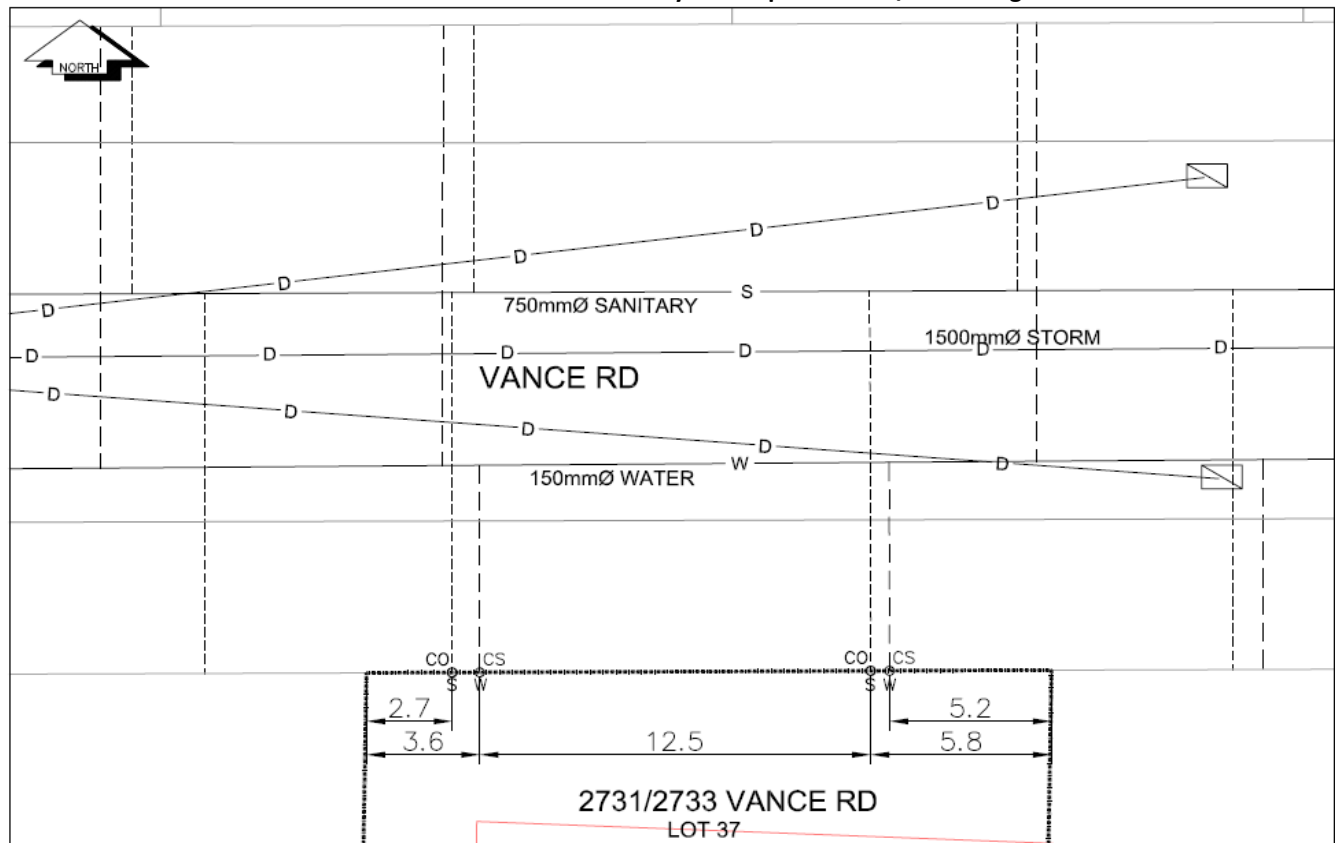

LEGEND:	CS CURB STOP	--- WATER SERVICE	--- STORM SERVICE
	CO CLEAN OUT	--- SANITARY SERVICE	⊗ WATER VALVE

**NOT TO SCALE**