



City of Prince George
History Sheet

PID:	010600680
MU:	101261
WO:	64746 - 64749

Civic Address: 4050, 3990 18th Ave
1655, 1687, 1777, 1783 Quinn St
Legal Description: Lot: 2 (REM) District Lot: 2508 Plan: 19210

Service Type	Diameter (mm)	Material	Invert Elev at main (m)	Invert Elev at property line (m)	Invert Elev at service end (m)	Distance into property (m)	Installation Date
Sanitary (18th W)	150mm	AC	-	-	-	-	January 1972
Sanitary (18th E)	100mm	PVC	-	-	-	-	May 2012
Sanitary (Quinn)	100mm	AC	-	-	-	-	Jan1957
Water (18th W)	100mm	Unknown	-	-	-	-	January 1979
Water (18th E)	100mm	PVC	-	-	-	-	May 2012
Water (Quinn N)	25mm	Copper	-	-	-	-	January 1964
Water (Quinn S)	100mm	Unknown	-	-	-	-	January 1964
Storm (18th W)	450mm	AC	-	-	-	-	January 1973
Storm (18th E)	150mm	PVC	-	-	-	-	May 2012
Storm (Quinn N)	200mm	AC	-	-	-	-	January 1966
Storm (Quinn S)	100mm	AC	-	-	-	-	January 1966

Service Connection Location	Sanitary (m)	Storm (m)
150mm Sanitary service connected to San MH 4032	-	
Distance from downstream San MH 4033 towards upstream San MH 4034	81.40	
Distance from downstream San MH 835 towards upstream San MH 4007	11.10	
450mm Storm service connected to Stm MH 1104		
150mm Storm service conneted to Stm MH3121		
200mm Storm service connected to Stm MH 2142		
Distance from downstream Stm MH 2142 towards upstream Stm MH 2141		68.50

Power	Size	Communications	Size	Cable	Size	Gas	Size
BC Hydro	-	Telus	-	Shaw	-	FortisBC	-
Overhead Service		Overhead Service		Overhead Service			

Installed by: City of Prince George forces	Survey Date: -
Comments:	

NOT TO SCALE The information contained herein is for internal use only.
Not to be relied on unless confirmed by site inspection and/or investigation.

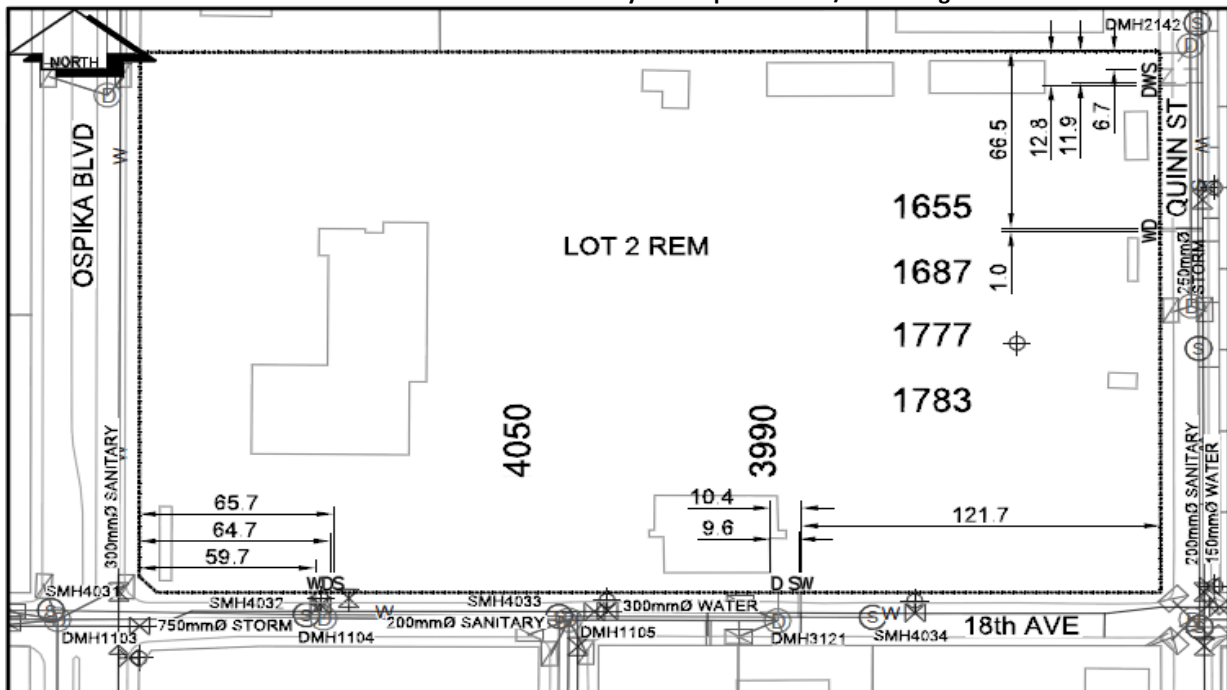

CS CURB STOP	--- WATER SERVICE	--- STORM SERVICE
CO CLEAN OUT	--- SANITARY SERVICE	--- GAS
WV WATER VALVE	--- FIRE HYDRANT	--- ENCUMBRANCE

NOT TO SCALE