



City of Prince George

History Sheet

PID:	007721501
	007721510
SD/MU:	
WO:	

Civic Address: 1841 Juniper St

Legal Description: Lot: 5, 6 Block: 308 District Lot: 343 Plan: 1268

Service Type	Diameter (mm)	Material	Invert Elev at main (m)	Invert Elev at property line (m)	Invert Depth at service end (m)	Distance into property (m)	Installation Date
Sanitary	100mm	AC	-	577.27	2.10	-	January 1957
Water	20mm	Copper	-	-	-	-	January 1957
Storm	N/A	N/A	-	-	-	-	

Service Connection Location				Sanitary (m)	Storm (m)
Distance from downstream San MH	3308	towards upstream San MH	3204	57.39	
Distance from downstream Stm MH	-	towards upstream Stm MH	-		

Power	Size	Communications	Size	Cable	Size	Gas	Size
BC Hydro	-	Telus	-	Shaw	-	FortisBC	-
Overhead Service		Overhead Service		Overhead Service			

Installed by:	Survey Date:	-
Comments:	Water and Sanitary service location confirmed March 2017.	

NOT TO SCALE The information contained herein is for internal use only.
Not to be relied on unless confirmed by site inspection and/or investigation.

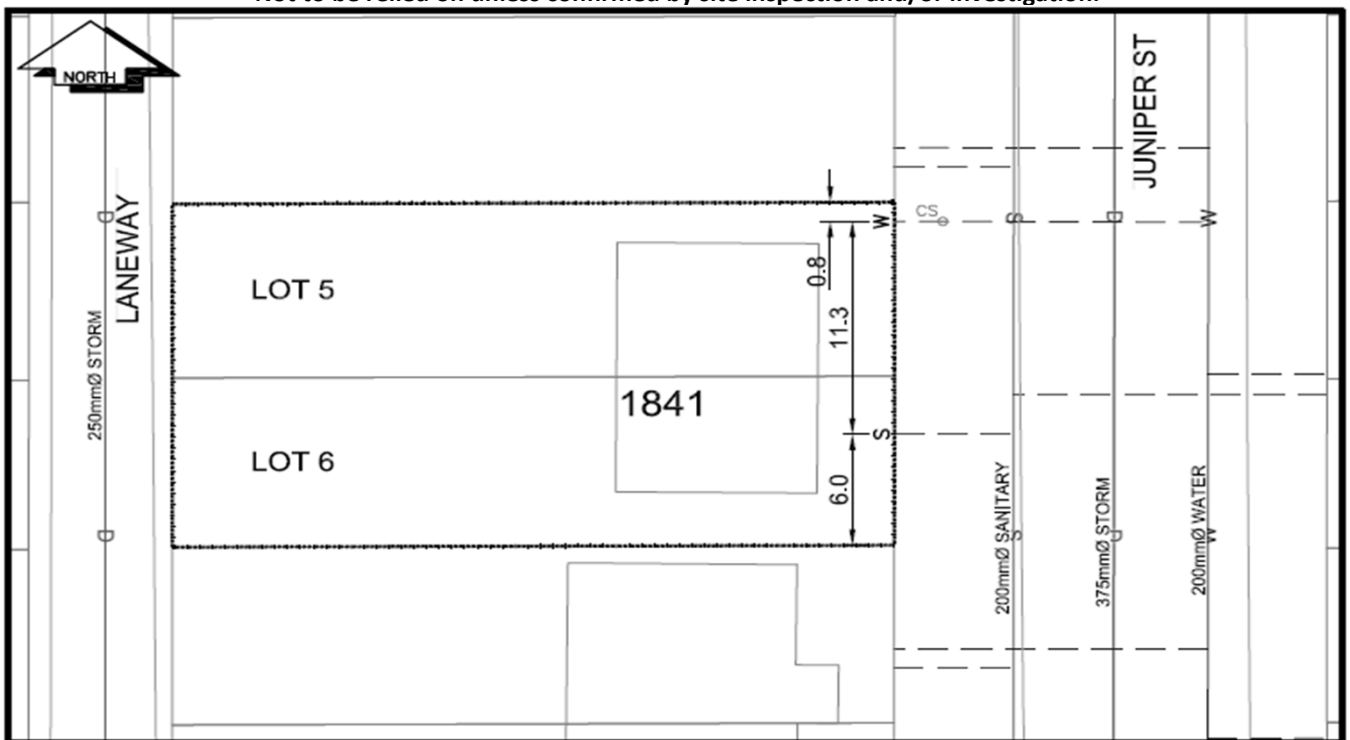

CS	CURB STOP	---	WATER SERVICE	---	STORM SERVICE
CO	CLEAN OUT	---	SANITARY SERVICE	---	GAS
⊗	WATER VALVE	⊗	FIRE HYDRANT	---	ENCUMBRANCE

NOT TO SCALE