



City of Prince George

History Sheet

| | |
|--------|-----------|
| PID: | 007252374 |
| | 007252455 |
| SD/MU: | |
| WO: | |

Civic Address: 1798 Kenwood Street

Legal Description: Lot: 1 District Lot: 343 Plan: 14716

Lot: 12 District Lot: 343 Plan: 1268

| Service Type | Diameter (mm) | Material | Invert Elev at main (m) | Invert Elev at property line (m) | Invert Elev at service end (m) | Distance into property (m) | Installation Date |
|--------------|---------------|----------|-------------------------|----------------------------------|--------------------------------|----------------------------|-------------------|
| Sanitary | 100mm | AC | - | - | - | - | January 1957 |
| Water | 13mm | Copper | - | - | - | - | January 1957 |
| Storm | N/A | N/A | - | - | - | - | |

| Service Connection Location | | | | Sanitary (m) | Storm (m) |
|---------------------------------|------|-------------------------|------|--------------|-----------|
| Distance from downstream San MH | 3188 | towards upstream San MH | 3187 | 20.45 | |
| Distance from downstream Stm MH | - | towards upstream Stm MH | - | | |

| Power | Size | Communications | Size | Cable | Size | Gas | Size |
|------------------|------|------------------|------|------------------|------|----------|------|
| BC Hydro | - | Telus | - | Shaw | - | FortisBC | - |
| Overhead Service | | Overhead Service | | Overhead Service | | | |

| | | |
|---------------|--------------|---|
| Installed by: | Survey Date: | - |
| Comments: | | |
| | | |
| | | |

NOT TO SCALE The information contained herein is for internal use only.
Not to be relied on unless confirmed by site inspection and/or investigation.

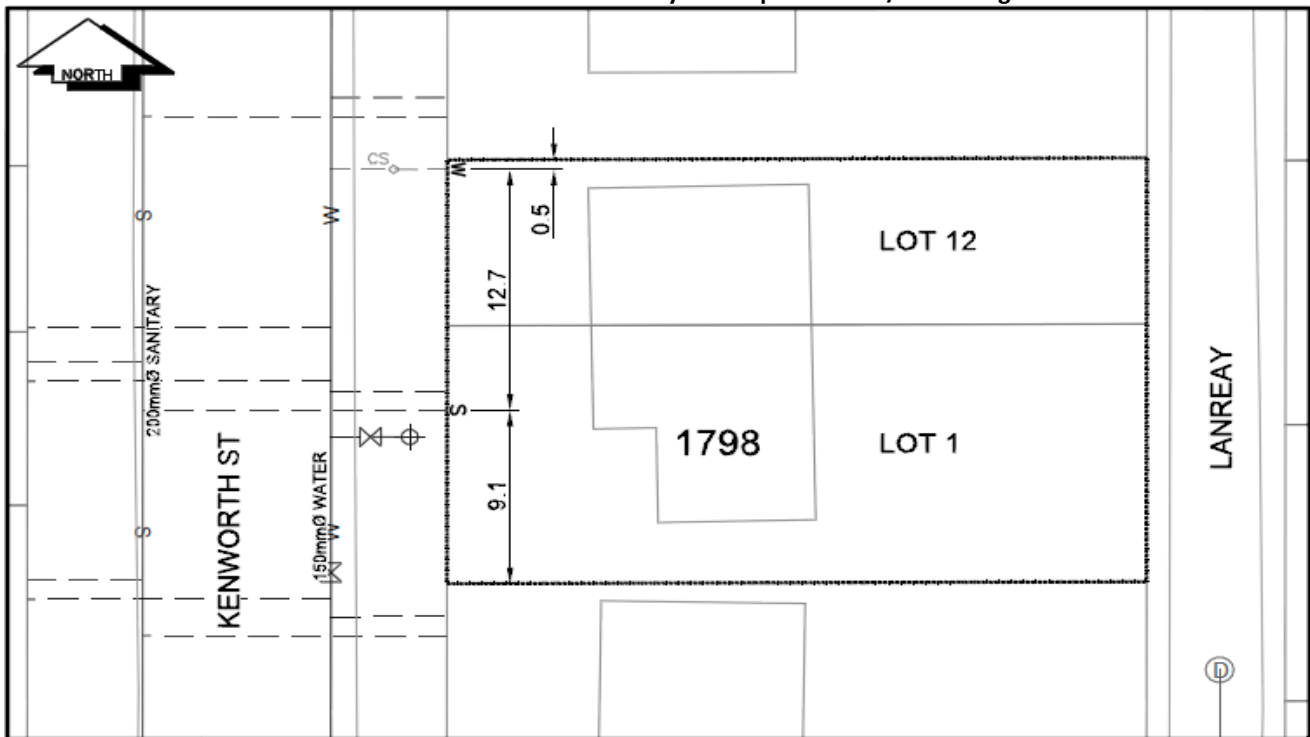

| LEGEND: | |
|---------|------------------|
| CS | CURB STOP |
| CO | CLEAN OUT |
| ⊗ | WATER VALVE |
| — W | WATER SERVICE |
| — S | SANITARY SERVICE |
| ⊗ | FIRE HYDRANT |
| — S | STORM SERVICE |
| — G | GAS |
| --- | ENCUMBERANCE |

NOT TO SCALE