



City of Prince George  
**History Sheet**

PID:	006869947
SD/MU:	
WO:	

Civic Address: 4505 Handlen Road

Legal Description: Lot: A District Lot: 4048 Plan: 26702

Service Type	Diameter (mm)	Material	Invert Elev at main (m)	Invert Elev at property line (m)	Invert Depth at service end (m)	Distance into property (m)	Installation Date
Sanitary	100mm	PVC	-	-	2.84	-	June 1980
Water	20mm	Copper	-	-	-	-	July 2014
Storm	N/A	N/A	-	-	-	-	

Service Connection Location				Sanitary (m)	Storm (m)
Distance from downstream San MH	318	towards upstream San MH	219	45.79	
Distance from downstream Stm MH	-	towards upstream Stm MH	-		

Power	Size	Communications	Size	Cable	Size	Gas	Size
BC Hydro	-	Telus	-	Shaw	-	FortisBC	-
Overhead Service		Overhead Service		Overhead Service			

Installed by:	City of Prince George forces	Survey Date:	-
Comments:	Existing 20mm water service disconnected in June 2014 and new 20mm water installed same trench to 400mm watermain		

**NOT TO SCALE** The information contained herein is for internal use only.  
Not to be relied on unless confirmed by site inspection and/or investigation.

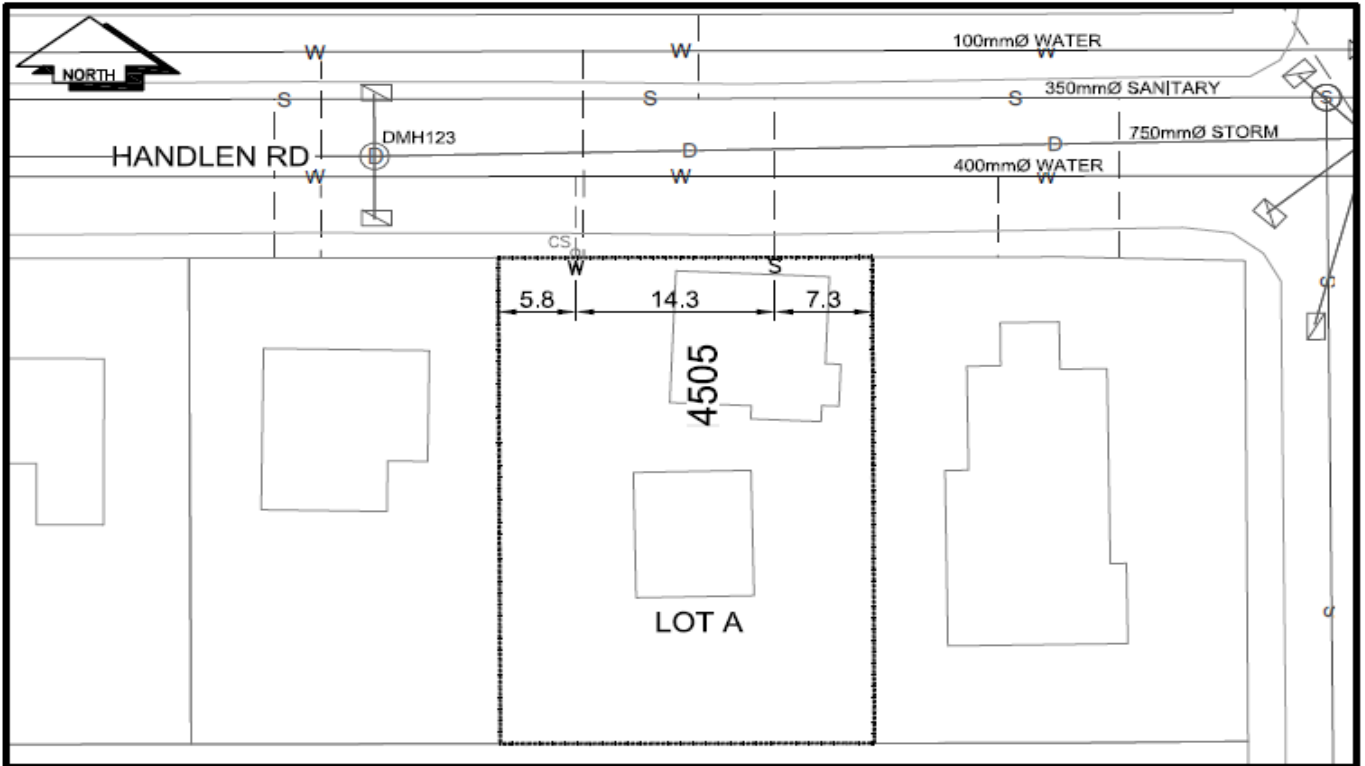

CS <sup>o</sup> CURB STOP	--- W WATER SERVICE	--- S STORM SERVICE
CO <sup>o</sup> CLEAN OUT	--- S SANITARY SERVICE	--- G GAS
⊗ WATER VALVE	⊗ FIRE HYDRANT	--- ENCUMBRANCE

**NOT TO SCALE**