



City of Prince George
History Sheet

PID:	006596975
MU:	100352/100424
WO:	23468-23469

Civic Address: 5028, 5078 Hart Hwy

Legal Description: Lot: PCL A (W23583) District Lot: 4039 Plan: 27213

Service Type	Diameter (mm)	Material	Invert Elev at main (m)	Invert Elev at property line (m)	Invert Depth at service end (m)	Distance into property (m)	Installation Date
Sanitary (S1)	100mm	PVC	-	678.05	2.80	-	December 1979
Sanitary (S2)	150mm	PVC	-	682.19	2.80	-	December 1979
Sanitary (S3)	100mm	PVC	-	676.84	3.80	-	December 1979
Water (W1)	25mm	Copper	-	-	-	-	December 1979
Water (W2)	25mm	Copper	-	-	-	-	December 1979
Water (W3)	25mm	Copper	-	-	-	-	December 1979
Storm (D1)	150mm	PVC	-	678.16	3.10	-	December 1979
Storm (D2)	150mm	PVC	-	677.15	3.75	-	December 1979

Service Connection Location				Sanitary (m)	Storm (m)
Distance from downstream San MH	1261	towards upstream San MH	1236	19.10	
150mm Sanitary service connected to new San MH 1261					
Distance from downstream San MH	1265	towards upstream San MH	1261	62.97	

Power	Size	Communications	Size	Cable	Size	Gas	Size
BC Hydro	-	Telus	-	Shaw	-	FortisBC	-
Overhead Service		Overhead Service		Overhead Service			

Installed by:	Survey Date:	-
Comments: Water (W1, W2, W3) and Sanitary (S1) confirmed June 27, 2018		
Elevations and depths for sanitary and storm services from history sheet and ENG card.		

NOT TO SCALE The information contained herein is for internal use only.
Not to be relied on unless confirmed by site inspection and/or investigation.

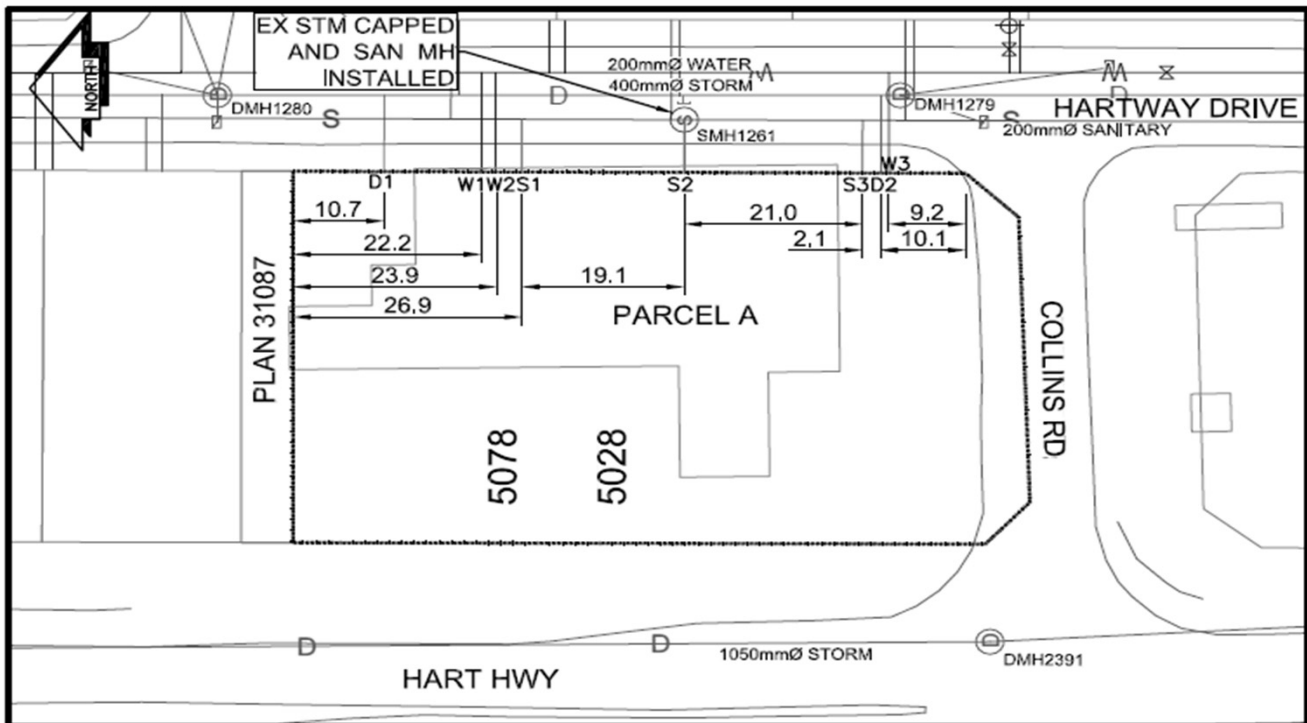

CS	CURB STOP	—	WATER SERVICE	—	STORM SERVICE
CO	CLEAN OUT	- - - -	SANITARY SERVICE	—G—	GAS
⊗	WATER VALVE	⊗	FIRE HYDRANT	- - - -	ENCUMBRANCE

NOT TO SCALE