



City of Prince George

|        |           |
|--------|-----------|
| PID:   | 005437580 |
|        | 005437601 |
|        | 005437628 |
| SD/MU: |           |
| WO:    |           |

## History Sheet

Civic Address: 2609 Gunn Road  
 Legal Description: Lot: 48 District Lot: 629 Plan: 902  
 Lot: 47 District Lot: 629 Plan: 902  
 Lot: 46 District Lot: 629 Plan: 902

| Service Type | Diameter (mm) | Material | Invert Elev at main (m) | Invert Elev at property line (m) | Invert Depth at service end (m) | Distance into property (m) | Installation Date |
|--------------|---------------|----------|-------------------------|----------------------------------|---------------------------------|----------------------------|-------------------|
| Sanitary     | 100mm         | AC       | -                       | 689.75                           | 2.74                            | -                          | January 1976      |
| Water        | Unknown       | Unknown  | -                       | -                                | -                               | -                          | April 1998        |
| Storm        | N/A           | N/A      | -                       | -                                | -                               | -                          |                   |

| Service Connection Location     |      |                         |      | Sanitary (m) | Storm (m) |
|---------------------------------|------|-------------------------|------|--------------|-----------|
| Distance from downstream San MH | 2883 | towards upstream San MH | 2882 | 58.87        |           |
| Distance from downstream Stm MH | -    | towards upstream Stm MH | -    |              |           |

| Power            | Size | Communications   | Size | Cable            | Size | Gas      | Size |
|------------------|------|------------------|------|------------------|------|----------|------|
| BC Hydro         | -    | Telus            | -    | Shaw             | -    | FortisBC | -    |
| Overhead Service |      | Overhead Service |      | Overhead Service |      |          |      |

|               |              |   |
|---------------|--------------|---|
| Installed by: | Survey Date: | - |
| Comments:     |              |   |
|               |              |   |
|               |              |   |

**NOT TO SCALE** The information contained herein is for internal use only.  
 Not to be relied on unless confirmed by site inspection and/or investigation.

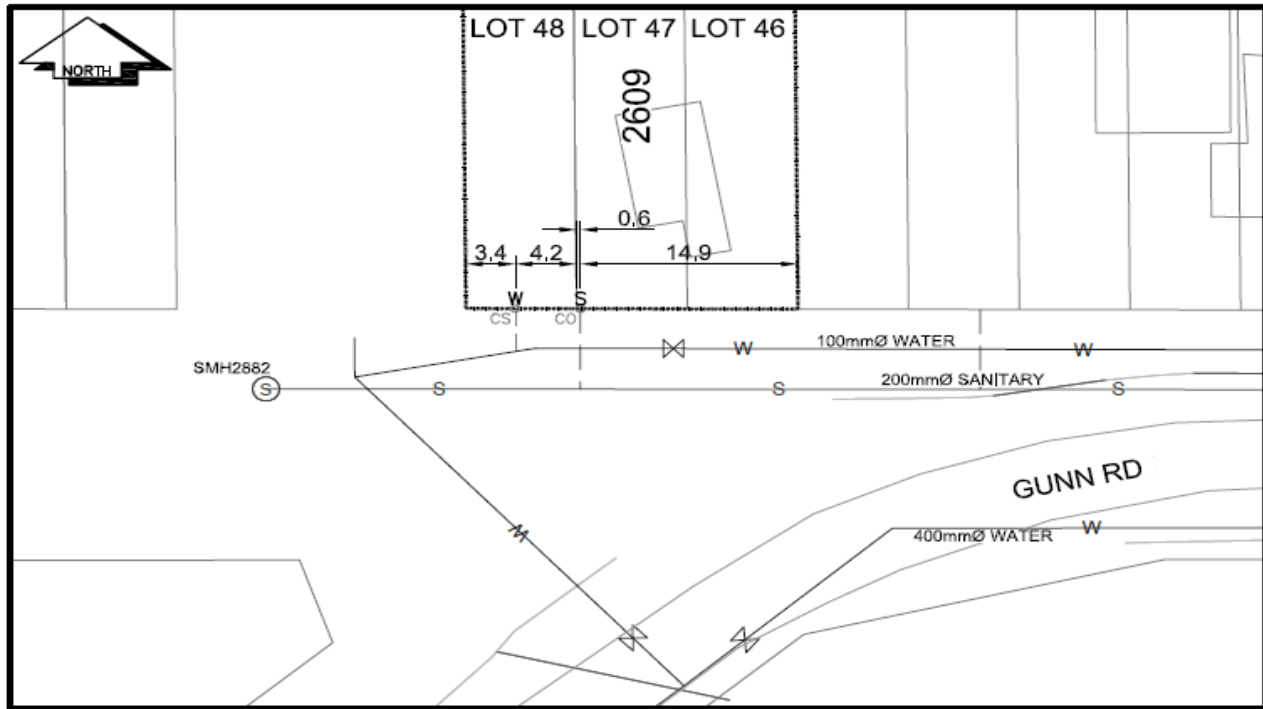

| LEGEND:         |             |       |                  |
|-----------------|-------------|-------|------------------|
| CS <sup>o</sup> | CURB STOP   | --- W | WATER SERVICE    |
| CO <sup>o</sup> | CLEAN OUT   | --- S | SANITARY SERVICE |
| ⊗               | WATER VALVE | ⊗     | FIRE HYDRANT     |
|                 |             | --- o | STORM SERVICE    |
|                 |             | --- G | GAS              |
|                 |             | ---   | ENCUMBRANCE      |

**NOT TO SCALE**