



City of Prince George

| | |
|--------|-----------|
| PID: | 005437580 |
| | 005437601 |
| | 005437628 |
| SD/MU: | |
| WO: | |

History Sheet

Civic Address: 2607 Gunn Road
 2609 Gunn Road
 2615 Gunn Road

Legal Description: Lot: 48 District Lot: 629 Plan: 902
 Lot: 47 District Lot: 629 Plan: 902
 Lot: 46 District Lot: 629 Plan: 902

| Service Type | Diameter (mm) | Material | Invert Elev at main (m) | Invert Elev at property line (m) | Invert Depth at service end (m) | Distance into property (m) | Installation Date |
|--------------|---------------|----------|-------------------------|----------------------------------|---------------------------------|----------------------------|-------------------|
| Sanitary | 100mm | AC | - | 689.75 | 2.74 | - | January 1976 |
| Water | Unknown | Unknown | - | - | - | - | April 1998 |
| Storm | N/A | N/A | - | - | - | - | |

| Service Connection Location | | | | Sanitary (m) | Storm (m) |
|---------------------------------|------|-------------------------|------|--------------|-----------|
| Distance from downstream San MH | 2883 | towards upstream San MH | 2882 | 58.87 | |
| Distance from downstream Stm MH | - | towards upstream Stm MH | - | | |

| Power | Size | Communications | Size | Cable | Size | Gas | Size |
|------------------|------|------------------|------|------------------|------|----------|------|
| BC Hydro | - | Telus | - | Shaw | - | FortisBC | - |
| Overhead Service | | Overhead Service | | Overhead Service | | | |

| | | |
|---------------|--------------|---|
| Installed by: | Survey Date: | - |
| Comments: | | |
| | | |
| | | |

NOT TO SCALE The information contained herein is for internal use only.
 Not to be relied on unless confirmed by site inspection and/or investigation.

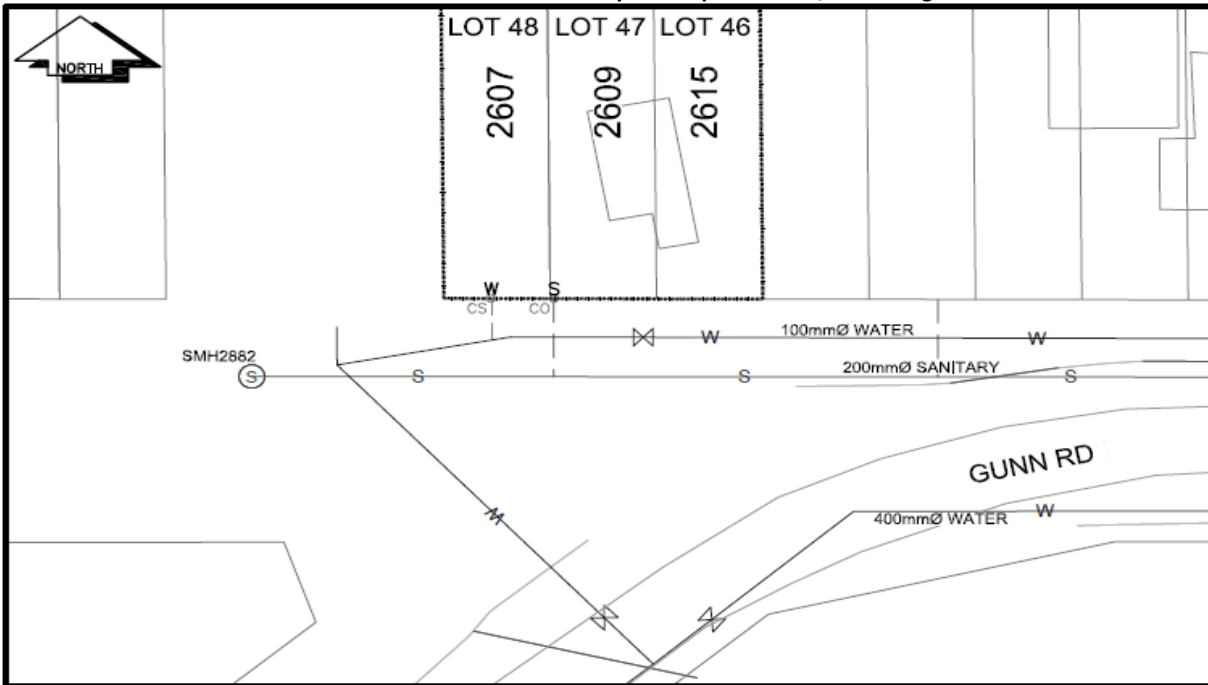

LEGEND:

| | | | | | | | |
|----|-------------|-----|---|------------------|-----|-----|---------------|
| CS | CURB STOP | --- | W | WATER SERVICE | --- | ○ | STORM SERVICE |
| CO | CLEAN OUT | --- | S | SANITARY SERVICE | --- | G | GAS |
| ⊗ | WATER VALVE | ⊗ | ⊗ | FIRE HYDRANT | --- | --- | ENCUMBRANCE |

NOT TO SCALE