



City of Prince George
History Sheet

PID:	005294231
SD/MU:	
WO:	

Civic Address: 2634 Capella Drive

Legal Description: Lot: PCL 1 District Lot: 753 Plan: 30666

Service Type	Diameter (mm)	Material	Invert Elev at main (m)	Invert Elev at property line (m)	Invert Depth at service end (m)	Distance into property (m)	Installation Date
Sanitary	100mm	Unknown	-	626.85	2.38	-	January 1979
Water	Unknown	Unknown	-	-	-	-	January 1979
Storm	N/A	N/A	-	-	-	-	

Service Connection Location				Sanitary (m)	Storm (m)
Distance from downstream San MH	3670	towards upstream San MH	3672	36.60	
Distance from downstream Stm MH	-	towards upstream Stm MH	-		

Power	Size	Communications	Size	Cable	Size	Gas	Size
BC Hydro	-	Telus	-	Shaw	-	FortisBC	-
Overhead Service		Overhead Service		Overhead Service			

Installed by:	Survey Date:	-
Comments: 20mm copper service services 2634 Capella Dr and 25mm plastic service services 2626 Capella Dr		

NOT TO SCALE The information contained herein is for internal use only.
Not to be relied on unless confirmed by site inspection and/or investigation.

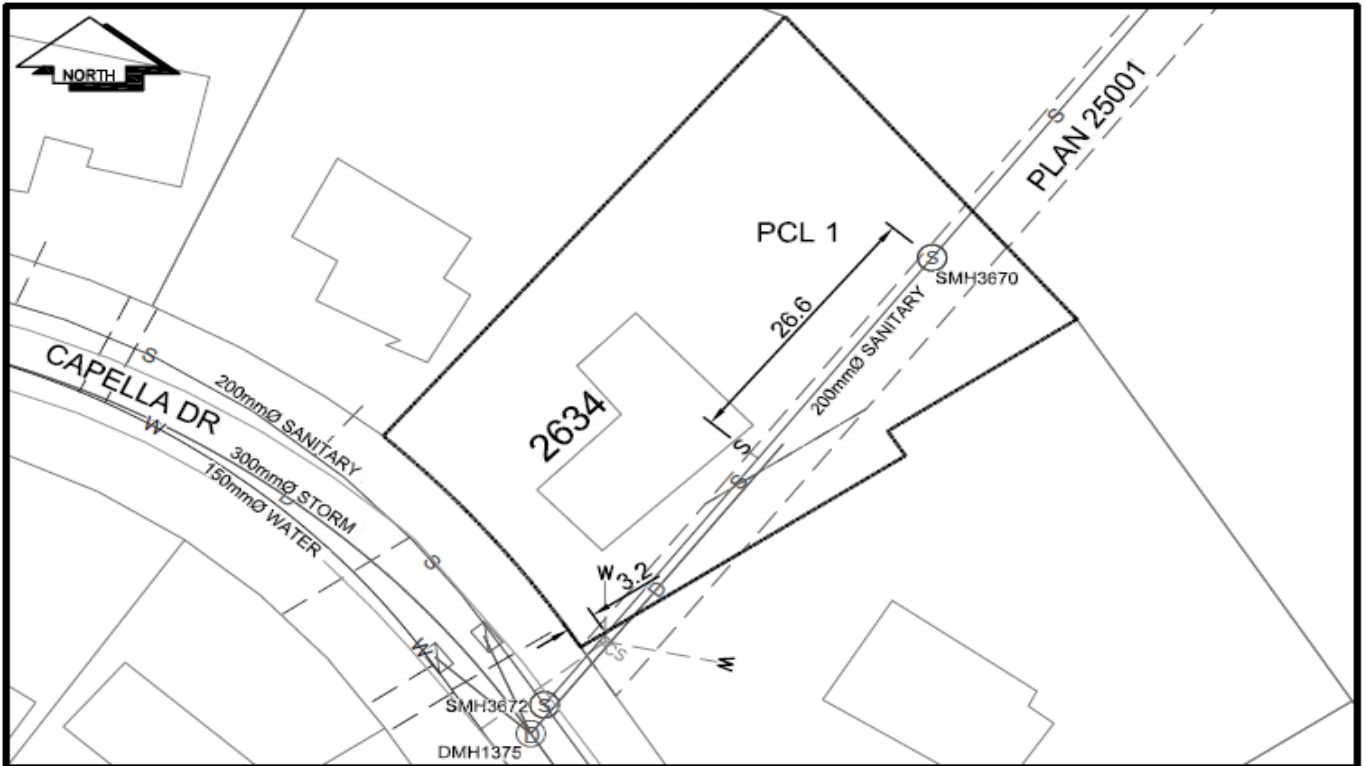

CS	CURB STOP	---	W	WATER SERVICE	---	○	STORM SERVICE
CO	CLEAN OUT	---	S	SANITARY SERVICE	---	G	GAS
⊗	WATER VALVE	⊗	⊗	FIRE HYDRANT	---	---	ENCUMBRANCE

NOT TO SCALE