



City of Prince George
History Sheet

PID:	004606698
	004606710
SD/MU:	
WO:	

Civic Address: 1716, 1718 9th Ave

Legal Description: Lot: 13, 14 Block: 191 District Lot: 343 Plan: 1268

Service Type	Diameter (mm)	Material	Invert Elev at main (m)	Invert Elev at property line (m)	Invert Depth at service end (m)	Distance into property (m)	Installation Date
Sanitary	100mm	AC	-	574.82	1.28	-	December 1956
Water	20mm	Copper	575.57	575.85	-	-	August 2015
Storm	N/A	N/A	-	-	-	-	

Service Connection Location				Sanitary (m)	Storm (m)
Distance from downstream San MH	3094	towards upstream San MH	3091	14.90	
Distance from downstream Stm MH	-	towards upstream Stm MH	-		

Power	Size	Communications	Size	Cable	Size	Gas	Size
BC Hydro	-	Telus	-	Shaw	-	FortisBC	-
Overhead Service		Overhead Service		Overhead Service			

Installed by:	Water service installed by City of Prince George forces	Survey Date:	-
Comments:			

NOT TO SCALE The information contained herein is for internal use only.
Not to be relied on unless confirmed by site inspection and/or investigation.

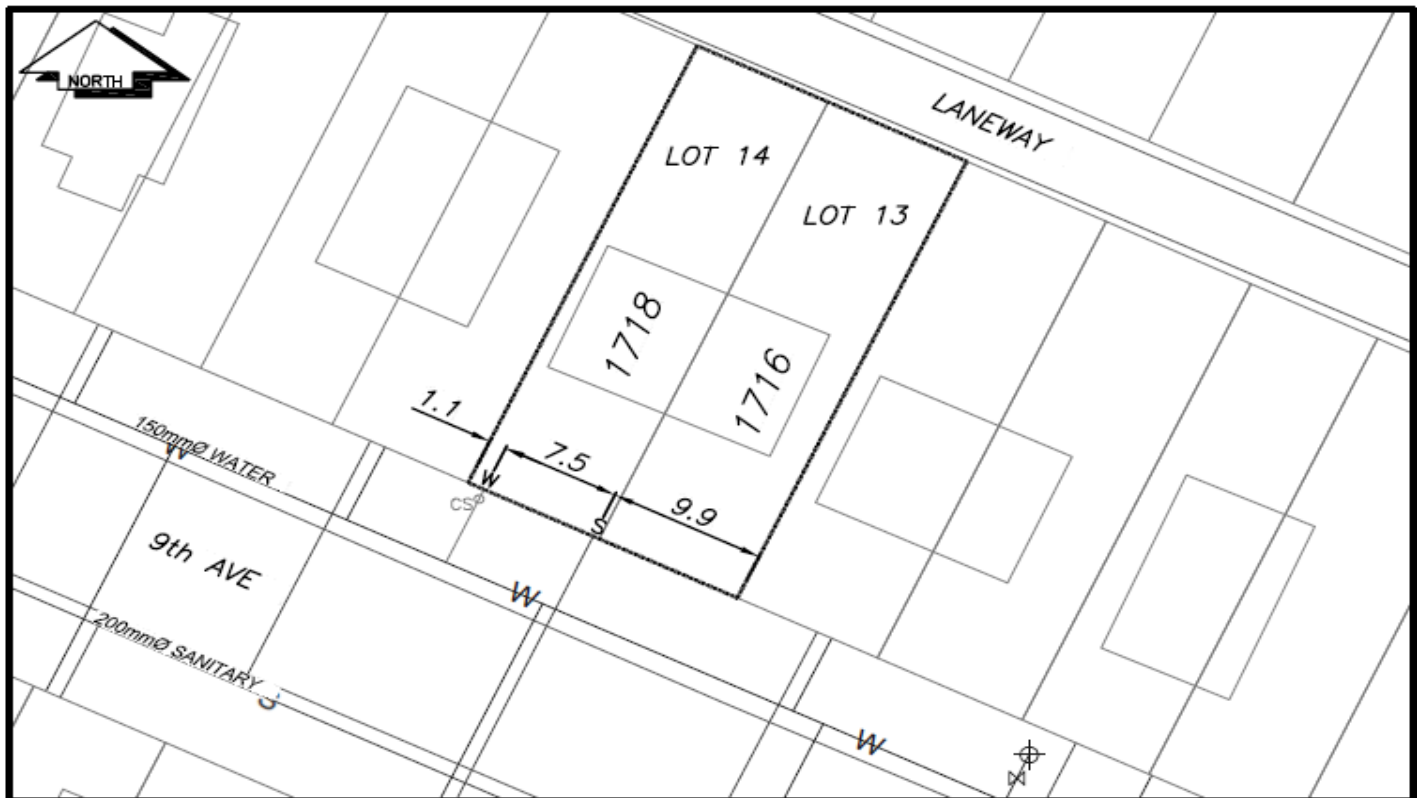

LEGEND:		
CS	CURB STOP	— W — WATER SERVICE
CO	CLEAN OUT	- - - - S - - - - SANITARY SERVICE
⊗	WATER VALVE	— G — GAS
		— W — STORM SERVICE
		⊕ FIRE HYDRANT
		- - - - ENCUMBERANCE

NOT TO SCALE