

**City of Prince George
HISTORY SHEET**

J0950303 JK

Refer to SFG 1974 Assessment

SHEET NUMBER **8012** Roll Number **110.017**

Legal: LOT'S **17** BLOCK **23** D.L. **417** PLAN **1409**

Address: **2261 Regent Cres Prince George**

Sanitary Connection: # _____ SIZE **4"** MATERIAL **Ac** INV. _____ CONNECTED **MAR. 73**

Water Connection # _____ SIZE **3/4"** MATERIAL **Cu** METER _____ CONNECTED **MAR. 7**

Storm Connection: # _____ SIZE _____ MATERIAL _____ INV. _____ CONNECTED _____

Cash Receipt No's: WATER SANITARY STORM _____

CURB FROM PROPERTY LINE _____ PAVEMENT WIDTH _____

B.C. HYDRO **OH** UNDERGROUND CONNECTION _____

B.C. TELEPHONE **OH** UNDERGROUND CONNECTION _____

INLAND GAS **Specifications at Inland Natural Gas.**

Information Sheets: _____

Comments: **Sold as fully serviced lots.**

SITE PLAN N.T.S.

Water and Sewer from Regent Crescent
approx. middle of lot

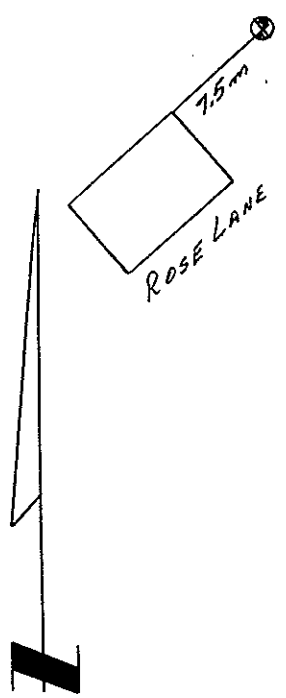

Sewer
Regent

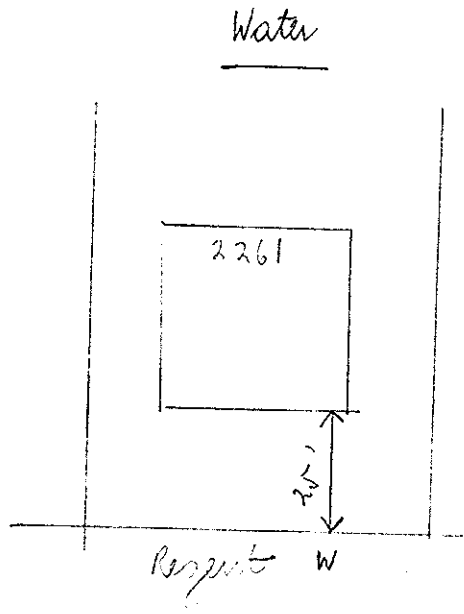

Water