



City of Prince George
History Sheet

| | |
|--------|-----------|
| PID: | 004156382 |
| SD/MU: | |
| WO: | |

Civic Address: 1438 Paxton Ave

Legal Description: Lot: 44 District Lot: 1426 Plan: 20156

| Service Type | Diameter (mm) | Material | Invert Elev at main (m) | Invert Elev at property line (m) | Invert Elev at service end (m) | Distance into property (m) | Installation Date |
|--------------|---------------|----------|-------------------------|----------------------------------|--------------------------------|----------------------------|-------------------|
| Sanitary | 100mm | AC | - | - | - | - | December 1971 |
| Water | 20mm | Copper | - | - | - | - | December 1971 |
| Storm | N/A | N/A | - | - | - | - | |

| Service Connection Location | Sanitary (m) | Storm (m) |
|---|--------------|-----------|
| 100MM SANITARY SERVICE CONNECTED TO SAN mh1810 | - | |
| Distance from downstream Stm MH - towards upstream Stm MH - | | |

| Power | Size | Communications | Size | Cable | Size | Gas | Size |
|---------------------|------|---------------------|------|---------------------|------|----------|------|
| BC Hydro | - | Telus | - | Shaw | - | FortisBC | - |
| Underground Service | | Underground Service | | Underground Service | | | |

| | | |
|---------------|--------------|---|
| Installed by: | Survey Date: | - |
| Comments: | | |
| | | |
| | | |

NOT TO SCALE The information contained herein is for internal use only.
Not to be relied on unless confirmed by site inspection and/or investigation.

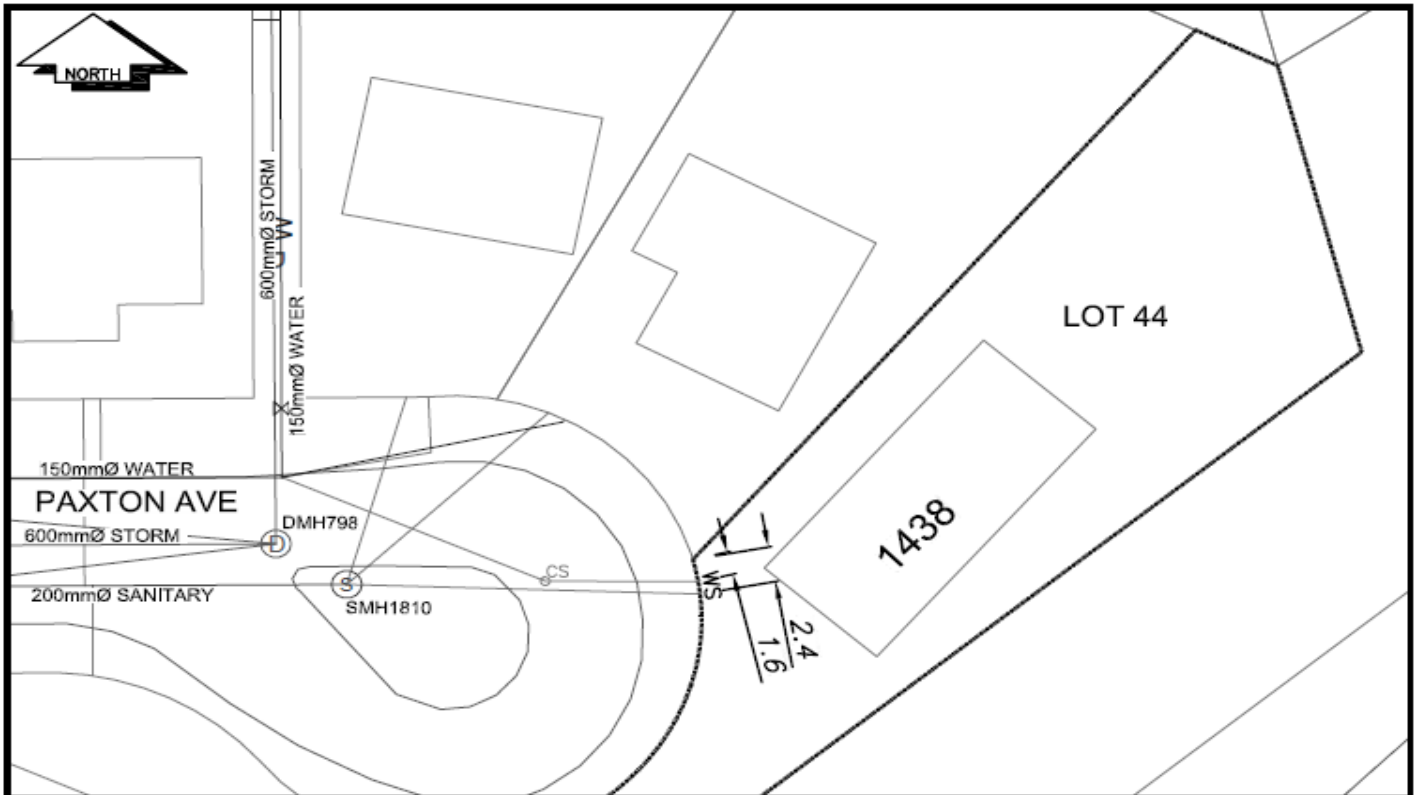

| LEGEND: | | | | | |
|---------|-------------|--|------------------|--|---------------|
| | CURB STOP | | WATER SERVICE | | STORM SERVICE |
| | CLEAN OUT | | SANITARY SERVICE | | GAS |
| | WATER VALVE | | FIRE HYDRANT | | ENCUMBRANCE |

NOT TO SCALE