

The City of Prince George does not represent or guarantee that the information contained in this document is accurate or reliable, and any person who relies on this information in this document does so at their own risk.

City of Prince George
This information has been provided subject to the *Federal Copyright Act* and in accordance with the *Provincial Freedom of Information and Protection of Privacy Act*.

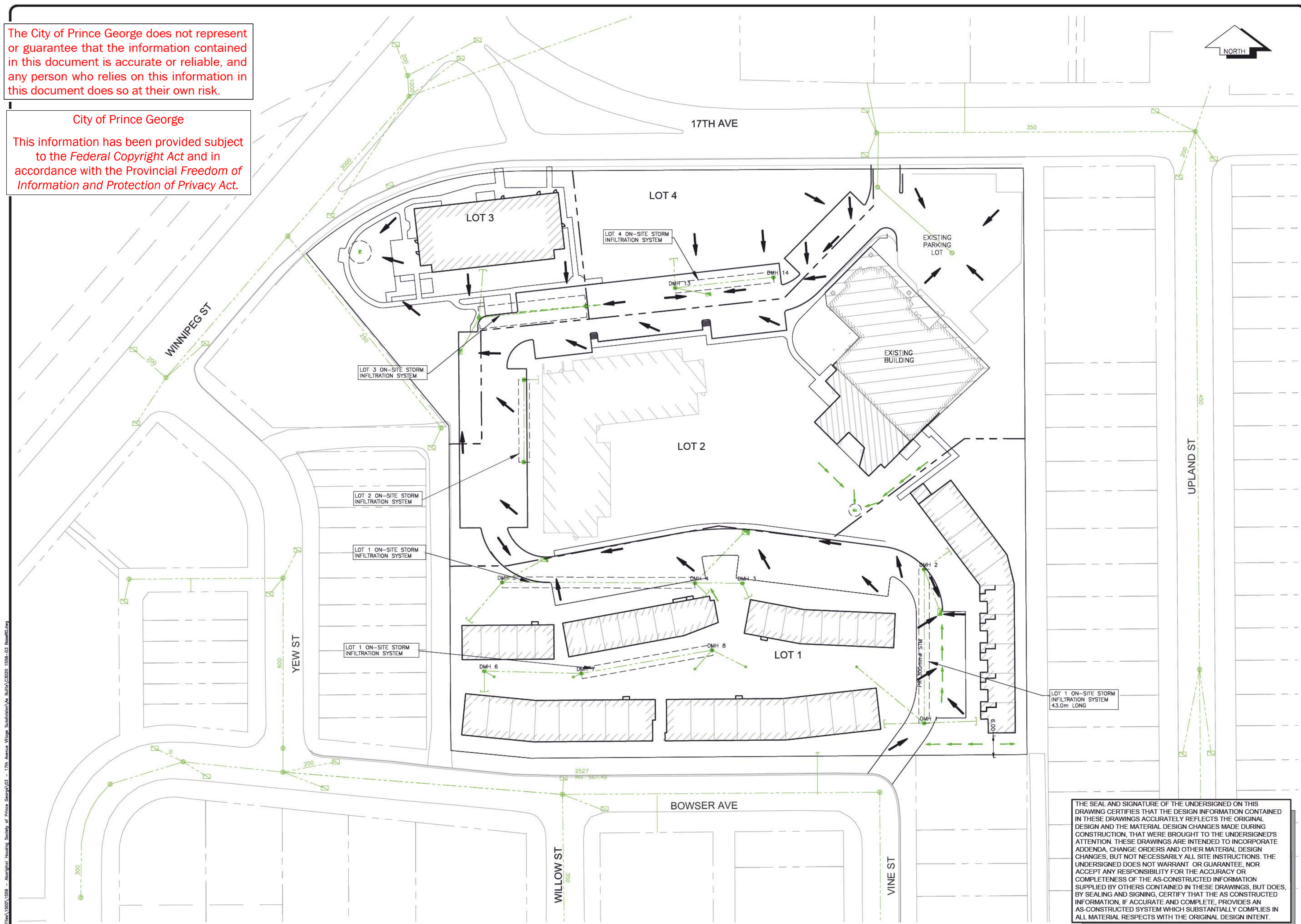

LEGEND

EXISTING

- EX. IP's & ISM's
- EX. LEGAL LINE
- EX. LEGAL R.O.W. & EASEMENT
- EX. SANITARY & MANHOLE
- EX. SANITARY FORCE MAIN
- EX. STORM & MANHOLE
- EX. SINGLE & DOUBLE CATCHBASIN w/ CB LEADS
- EX. CATCHBASIN MANHOLE
- EX. FIRE HYDRANT & VALVE ASSEMBLY
- EX. WATERMAIN & VALVE
- EX. BLOW-OFF ASSEMBLY
- EX. CURB STOP
- EX. ROAD & SIDEWALK
- EX. ROAD SIGN(s)
- EX. SHOULDER
- EX. TOP OF SLOPE
- EX. TOE OF SLOPE
- EX. DITCH or SWALE
- EX. FENCE
- EX. OVERHEAD LINES
- EX. UNDERGROUND LINES
- EX. POWER POLE & ANCHOR
- EX. GAS MAIN

PROPOSED

- PR. SANITARY & MANHOLE
- PR. STORM & MANHOLE
- PR. SINGLE & DOUBLE CATCHBASIN w/ CB LEADS
- PR. CATCHBASIN MANHOLE
- PR. FIRE HYDRANT & VALVE ASSEMBLY
- PR. WATERMAIN & VALVE
- PR. GRAVEL SHOULDER
- PR. ASPHALT
- PR. CURB & SIDEWALK
- PR. ROAD SIGN(s)

1	25/1/23	RECORD DRAWING	KP
0	15/9/21	ISSUED FOR SUBDIVISION	KP
NO.	DATE (D/M/Y)	REVISION	BY

RECORD DRAWING

L&M
ENGINEERING LIMITED

CONSULTANTS PROJECT No.: 1559-03

DRAWN: KP
CHECKED: TAF
ENGINEER: TAF
DATE: AUG 2021
SCALES: 1:500
SCALES: HALF 1:1000

PROFESSIONAL
T.A. FJELLSTROM
20194
ENGINEER
PERMIT TO PRACTICE NO 100275

ABORIGINAL HOUSING SOCIETY
OF PRINCE GEORGE
1919 17th AVENUE
4 LOT SUBDIVISION

CATCHMENT PLAN

DRAWING No.
C006-RD

0 15 30 Meters

THE SEAL AND SIGNATURE OF THE UNDERSIGNED ON THIS DRAWING CERTIFIES THAT THE DESIGN INFORMATION CONTAINED IN THESE DRAWINGS ACCURATELY REFLECTS THE ORIGINAL DESIGN AND THE MATERIAL DESIGN CHANGES MADE DURING CONSTRUCTION. THAT WERE BROUGHT TO THE UNDERSIGNED'S ATTENTION. THESE DRAWINGS ARE INTENDED TO INCORPORATE ADDENDA, CHANGE ORDERS AND OTHER MATERIAL DESIGN CHANGES, BUT NOT NECESSARILY ALL SITE INSTRUCTIONS. THE UNDERSIGNED DOES NOT WARRANT OR GUARANTEE, NOR ACCEPT ANY RESPONSIBILITY FOR THE ACCURACY OR COMPLETENESS OF THE AS-CONSTRUCTED INFORMATION SUPPLIED BY OTHERS CONTAINED IN THESE DRAWINGS, BUT DOES, BY SEALING AND SIGNING, CERTIFY THAT THE AS CONSTRUCTED INFORMATION, IF ACCURATE AND COMPLETE, PROVIDES AN AS-CONSTRUCTED SYSTEM WHICH SUBSTANTIALLY COMPLIES IN ALL MATERIAL RESPECTS WITH THE ORIGINAL DESIGN INTENT.

City of Prince George

This information has been provided subject to the *Federal Copyright Act* and in accordance with the *Provincial Freedom of Information and Protection of Privacy Act*.

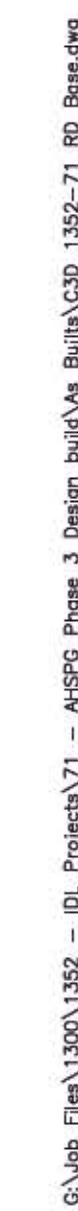

THIS DRAWING, AS AN INSTRUMENT OF SERVICE, IS THE PROPERTY OF L&M ENGINEERING LIMITED AND MAY NOT BE REPRODUCED WITHOUT WRITTEN PERMISSION OF SAME AND UNLESS THE REPRODUCTION CARRIES THEIR NAME ALL DESIGNS AND OTHER INFORMATION SHOWN ON THIS DRAWING ARE FOR USE ON THE SPECIFIED PROJECT ONLY AND SHALL NOT BE USED OTHERWISE WITHOUT WRITTEN PERMISSION OF L&M ENGINEERING LIMITED.

A number line representing distance in meters. The line starts at 0 and ends at 12. There are major tick marks at 0, 6, and 12. There are also minor tick marks at 3 and 9, which divide the segments between 0-3, 3-6, 6-9, and 9-12 into two equal parts each. The word "Meters" is written at the right end of the line.