



LEGEND

- 745 EXISTING GROUND CONTOURS
- PROPOSED RESIDENTIAL BUILDING SITE
- PROPOSED ELEVATION
- PROPOSED SWALES TO DIRECT DRAINAGE TOWARDS INGLEWOOD ROAD
- 40m x10m AREA RESERVED FOR ONSITE SEWAGE DISPOSAL - DO NOT DISTURB

City of Prince George

This information has been provided subject to the *Federal Copyright Act* and in accordance with the *Provincial Freedom of Information and Protection of Privacy Act*.

The City of Prince George does not represent or guarantee that the information contained in this document is accurate or reliable, and any person who relies on this information in this document does so at their own risk.

INGLEWOOD ROAD

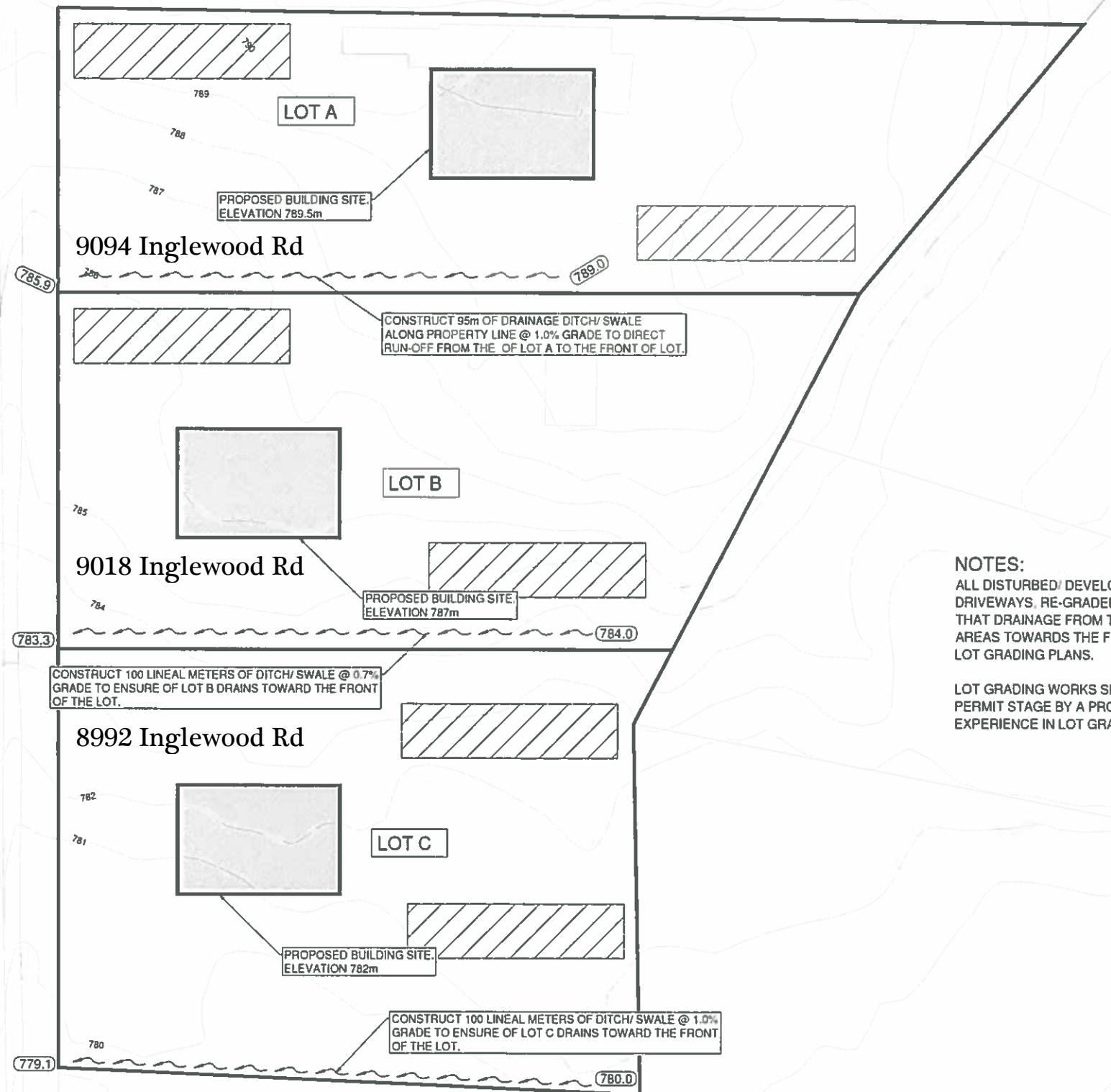

NOTES:

ALL DISTURBED/ DEVELOPED AREAS OF THE LOT (BUILDING SITE, DRIVEWAYS, RE-GRADED YARD) AREAS SHALL BE GRADED SUCH THAT DRAINAGE FROM THESE AREAS IS DIRECTED FROM THESE AREAS TOWARDS THE FRONT OF THE LOT AS SHOWN ON THE LOT GRADING PLANS.

LOT GRADING WORKS SHALL BE REVIEWED AT THE BUILDING PERMIT STAGE BY A PROFESSIONAL ENGINEER WITH EXPERIENCE IN LOT GRADING AND DRAINAGE.

PLAN
1:500

Permit-Seal



Consultant



205 - 1302 7TH AVENUE
PRINCE GEORGE, BC V2L 3P1
www.stantec.com

Copyright Reserved

The Contractor shall verify and be responsible for all dimensions. DO NOT scale the drawing. Any errors or omissions shall be reported to Stantec without delay. The Copyright to all designs and drawings are the property of Stantec. Reproduction or use for any purpose other than that authorized by Stantec is forbidden.

Client/Project

PROPOSED SUBDIVISION

PRINCE GEORGE, BC

Title

LOT GRADING
PLAN

Project No.

1158

Scale

1:500

Drawing No.

Sheet

Revision

1 of 1