

The City of Prince George does not represent or guarantee that the information contained in this document is accurate or reliable, and any person who relies on this information in this document does so at their own risk.

City of Prince George
This information has been provided subject to the Federal Copyright Act and in accordance with the Provincial Freedom of Information and Protection of Privacy Act

LEGEND

- PROP. TEMP. STORM WATER POND
- PROP. SILT FENCE
- PROP. SLOPE
- PROP. DRAINAGE DIRECTION
- PROP. ELEVATION
- EX. SANITARY SEWER
- PROP. SANITARY SERVICE
- EX. SANITARY MANHOLE
- PROP. SANITARY MANHOLE
- EX. WATER MAIN
- EX. WATER VALVE, HYDRANT
- PROP. WATER VALVE, HYDRANT
- PROP. TEE / BLOW OFF ASSEMBLY
- PROP. WATERMAIN
- PROP. WATER SERVICE
- EX. STORM SEWER PIPE
- EX. STORM SEWER MANHOLE
- PROP. STORM SEWER PIPE
- PROP. STORM SEWER MANHOLE
- PROP. STORM SERVICE
- EX. HYDRO
- EX. UTILITY POLE W/ GUY WIRE
- EX. POLE W/ TRANSFORMER
- CULVERT
- DITCH CENTERLINE
- EX. ROAD CENTERLINE
- EDGE OF ROAD
- PROP. EDGE OF PARKING LOT
- EX. TREE LINE

- ASPHALT
- CONCRETE

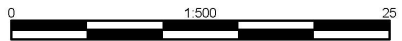
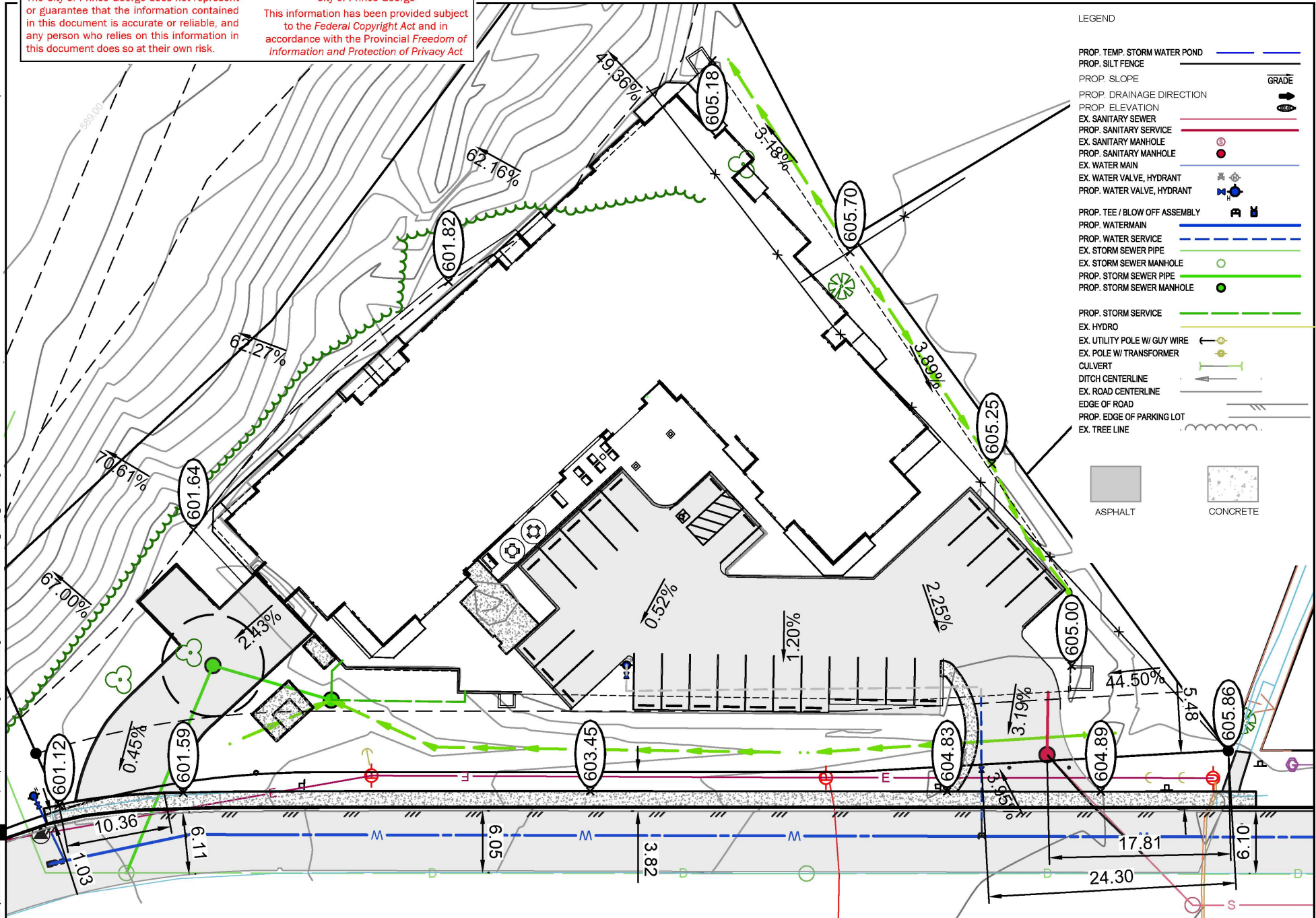

Suite 12
556 North Nechako Road
Prince George BC
Canada V2K 1A1
T 250 561 2229

The information contained herein is for internal use only. Not to be relied upon unless confirmed by site inspection and/or investigation.

474 OSPIKA BLVD. LUXURY APARTMENT

HISTORY RECORD

Drawing No.	
Project Number	2341-21414-00
Rev.	0