

DATE: 2023-09-18 15:54 FILE: \\2021\02\27\2023-09-18\PGNFC - Daggs Road Daycare\10.0 Drawings\10.5 Sheets\Lot Grading\2001 LOT GRADING\SUBMIT 23-09-22.dwg

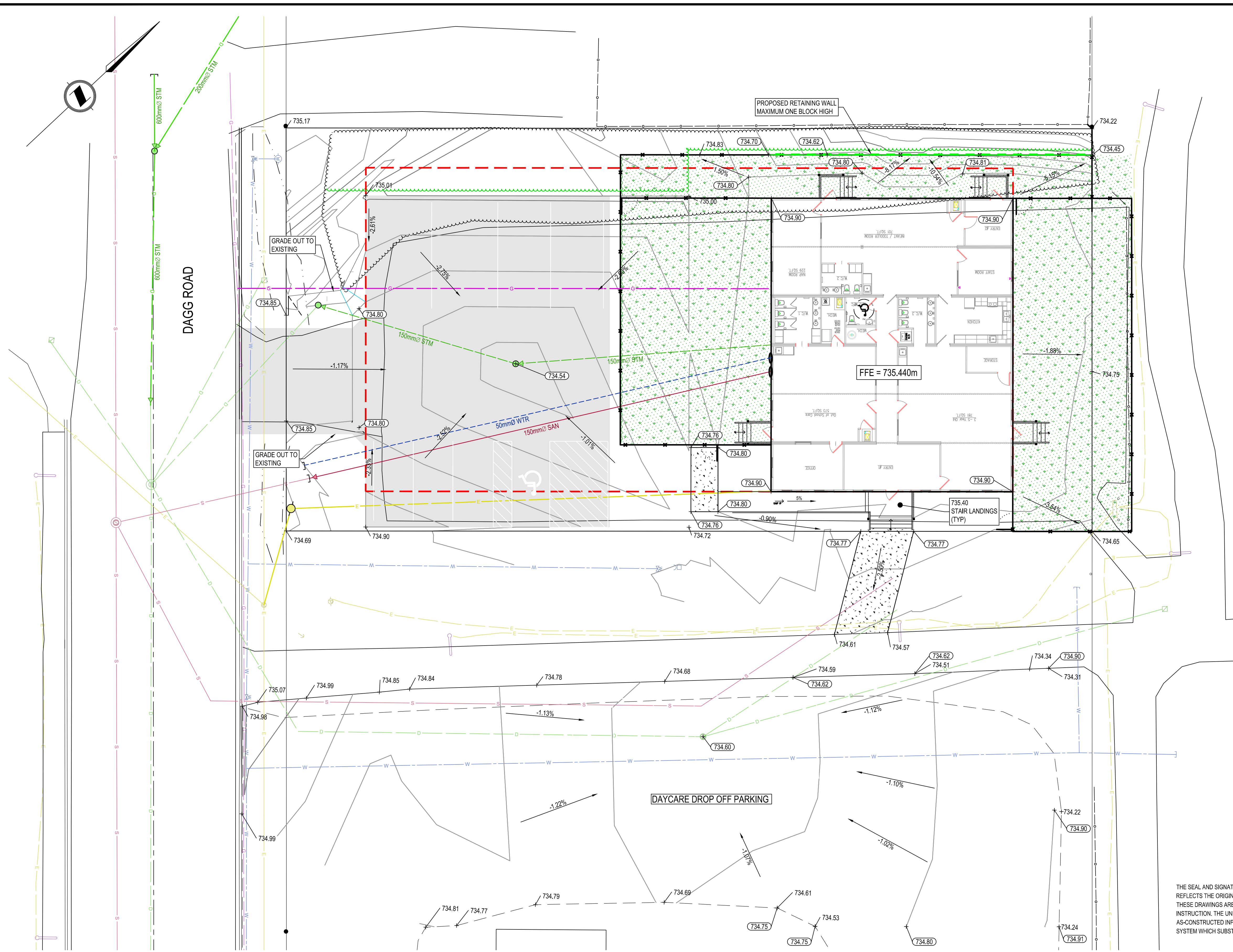

- NOTES**
- THIS PLAN REPRESENTS FIELD SURVEY CONDUCTED AUGUST 25, 2021. SURVEY PLAN STATES THAT THE GRID COORDINATES ARE UTM ZONE 10, NAD83 (CSRS).
  - INVERT ELEVATIONS OF SANITARY AND STORM ARE SURVEYED IN AUG 2023 AND IS UPDATE IN SHEET 101.
  - CONTOUR INTERVAL IS 0.1 m
  - REFER TO CITY OF PRINCE GEORGE SPECIFICATIONS FOR ADDITIONAL DETAILS.
  - ALL WORKS TO BE IN ACCORDANCE WITH THE:
    - PRINCE GEORGE SUBDIVISION AND SERVICING BYLAW No. 8618.2014
    - BC BUILDING CODE
    - THE MOST CURRENT MMCD STANDARDS AND SPECIFICATIONS
    - ALL TRENCHING AND EXCAVATION TO BE CARRIED OUT IN ACCORDANCE WITH WORKSAFE BC REQUIREMENTS.
    - ELECTRICAL, TELEPHONE, CABLE, FIBRE, AND NATURAL GAS SERVICES TO BE PROVIDED BY UTILITY PROVIDERS. COORDINATION FOR THESE SERVICES TO BE COMPLETED BY OTHERS.
    - NOTIFY BC ONE CALL PRIOR TO COMMENCEMENT OF ANY EXCAVATION. CONTRACTOR IS RESPONSIBLE FOR ANY AND ALL DAMAGES CAUSED BY THE FAILURE TO LOCATE AND PRESERVE ANY UNDERGROUND UTILITIES.
    - PAVEMENT STRUCTURE AND SITE PREPARATION AS PER GEOTECHNICAL ENGINEERING.
    - MINIMUM DEPTH OF COVER OVER WATERMAIN SHALL BE 3.0 METERS.
    - SOIL INFILTRATION COEFFICIENT OF 2.0X10<sup>-5</sup> M/S BASED ON GEOTECHNICAL REPORT.

- LEGEND**
- × 590.79 EXISTING GROUND ELEVATION
  - × 592.20 FINISHED GROUND ELEVATION
  - 2.00% FINISHED GROUND SLOPE
  - EXISTING CATCH BASINS
  - PROPOSED CATCH BASIN/LAWN BASIN
  - EXISTING STORM MANHOLE
  - PROPOSED STORM MANHOLE
  - EXISTING SEWER MANHOLE
  - PROPOSED SEWER MANHOLE
  - PROPOSED INSPECTION CHAMBER

THE SEAL AND SIGNATURE OF THE UNDERSIGNED ON THIS DRAWING CERTIFIES THAT THE DESIGN INFORMATION CONTAINED IN THESE DRAWINGS ACCURATELY REFLECTS THE ORIGINAL DESIGN AND THE MATERIAL DESIGN CHANGES MADE DURING CONSTRUCTION. THAT WERE BROUGHT TO THE UNDERSIGNED'S ATTENTION. THESE DRAWINGS ARE INTENDED TO INCORPORATE ADDENDA, CHANGE ORDERS AND OTHER MATERIAL DESIGN CHANGES, BUT NOT NECESSARILY AT THE SITE INSTRUCTION. THE UNDERSIGNED DOES NOT WARRANT OR GUARANTEE, NOR ACCEPT ANY RESPONSIBILITY FOR THE ACCURACY OR COMPLETENESS OF THE AS-CONSTRUCTED INFORMATION SUPPLIED BY OTHERS CONTAINED IN THESE DRAWINGS, BUT DOES, BY SEALING AND SIGNING, CERTIFY THAT THE AS-CONSTRUCTED SYSTEM WHICH SUBSTANTIALLY COMPLIES IN ALL MATERIAL RESPECTS WITH THE ORIGINAL DESIGN INTENT.

Rev	Date	Description	Drawn	Design	App'd
2	2023-09-22	AS CONSTRUCTED CONDITION	JX	-	CH
1	2022-07-20	ISSUED FOR CONSTRUCTION	KAK	CH	CH
0	2022-04-26	ISSUED FOR BUILDING PERMIT	KAK	CH	CH

THIS DRAWING AND DESIGN IS THE PROPERTY OF McElhanney and shall not be used, reused or reproduced without the consent of McElhanney. McElhanney will not be held responsible for the improper or unauthorized use of this drawing and design.

THIS DRAWING AND DESIGN HAS BEEN PREPARED FOR THE CLIENT IDENTIFIED. TO MEET THE STANDARDS AND REQUIREMENTS OF THE APPLICABLE PUBLIC AGENCIES AT THE TIME OF PREPARATION. McELHANNEY, ITS EMPLOYEES, SUBCONSULTANTS AND AGENTS WILL NOT BE LIABLE FOR ANY LOSSES OR OTHER CONSEQUENCES RESULTING FROM THE USE OR RELIANCE UPON, OR ANY CHANGES MADE TO, THIS DRAWING, BY ANY THIRD PARTY, INCLUDING CONTRACTORS, SUPPLIERS, CONSULTANTS AND STAKEHOLDERS, OR THEIR EMPLOYEES OR AGENTS, WITHOUT McELHANNEY'S PRIOR WRITTEN CONSENT.

INFORMATION ON EXISTING UNDERGROUND FACILITIES MAY NOT BE COMPLETE OR ACCURATE. McELHANNEY, ITS EMPLOYEES AND DIRECTORS ARE NOT RESPONSIBLE NOR LIABLE FOR THE LOCATION OF ANY UNDERGROUND CONDUITS, PIPES, CABLES OR OTHER FACILITIES WHETHER SHOWN OR OMITTED FROM THIS PLAN. PRIOR TO CONSTRUCTION CONTRACTOR SHALL EXPOSE LOCATIONS OF ALL EXISTING FACILITIES BY HAND DIGGING OR HYDROVAC AND ADVISE THE ENGINEER OF POTENTIAL CONFLICTS.

ORIGINAL DWG SIZE: ANSI D (22" x 34")

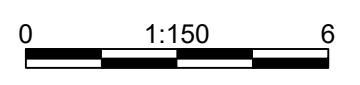

**McElhanney**

Suite 12  
556 North Nechako Road  
Prince George BC  
Canada V2K 1A1  
T 250 561 2229

PROFESSIONAL  
ENGINEER  
C. E. HUTCHINSON  
# 37510  
C. BRITISH  
COLUMBIA  
CIVIL ENGINEER

Permit Number:  
1003299

Approved & Sealed

PGNFC  
PRINCE GEORGE, BC

**TSULH'CHOH DAYCARE  
LOT GRADING  
SITE PLAN**

Drawing No.  
**C-201**

Project Number  
2341-21273-00

Rev.  
2

DESTROY ALL PRINTS BEARING PREVIOUS REVISION