

LEGEND

X 757.47 PROPOSED SPOT ELEVATION

★ 756.80 EXISTING SPOT ELEVATION

HCM

CONSULTANT LOGO

L&M

ENGINEERING LIMITED

1210 FOURTH AVENUE
PRINCE GEORGE, B.C.
V2L 3A4
TEL (250) 562-1977
FAX (250) 562-1967

DISCLAIMER

THE CIVIL RECORD DRAWINGS INCORPORATE CHANGES DOCUMENTED BY THE CONSULTANT THROUGH THE CONSTRUCTION PHASE, INCLUDING CHANGE ORDERS, SUPPLEMENTAL INSTRUCTIONS AND REQUESTS FOR INFORMATION. THEY DO NOT INCLUDE MARK-UPS ON SHOP DRAWINGS.

L&M ENGINEERING LIMITED DOES NOT GUARANTEE THE ACCURACY OF THE INFORMATION PROVIDED (OR NOT PROVIDED) BY THE CONTRACTOR. L&M ENGINEERING LIMITED HAS NOT VERIFIED THE ACCURACY OR COMPLETENESS OF AS-BUILT INFORMATION AND IS NOT RESPONSIBLE FOR ANY ERRORS OR OMISSIONS IN THE INFORMATION PROVIDED (OR NOT PROVIDED) BY OTHERS. AS SUCH, IF THE CLIENT OR ANY FUTURE CONSULTANT RELIES ON THIS INFORMATION, THEY DO SO AT THEIR OWN RISK.



7	RECORD DRAWING	02/09/20
6	REVISED GRADING	007/2020
5	ADD SIDEWALK	01/06/20
4	ISSUED FOR CONSTRUCTION	18/6/18
3	REVISED DESIGN ELEV	08/05/18
2	ISSUED FOR TENDER	04/04/18
1	BUILDING PERMIT	29/01/18
#	DESCRIPTION	DATE

KELLY ROAD SECONDARY SCHOOL

SD 57
4540 HANDLEN RD
PRINCE GEORGE, BC
V2K 2J8

PROJECT #: 1387-05

GRADING PLAN

C006

SCALE: 1:250

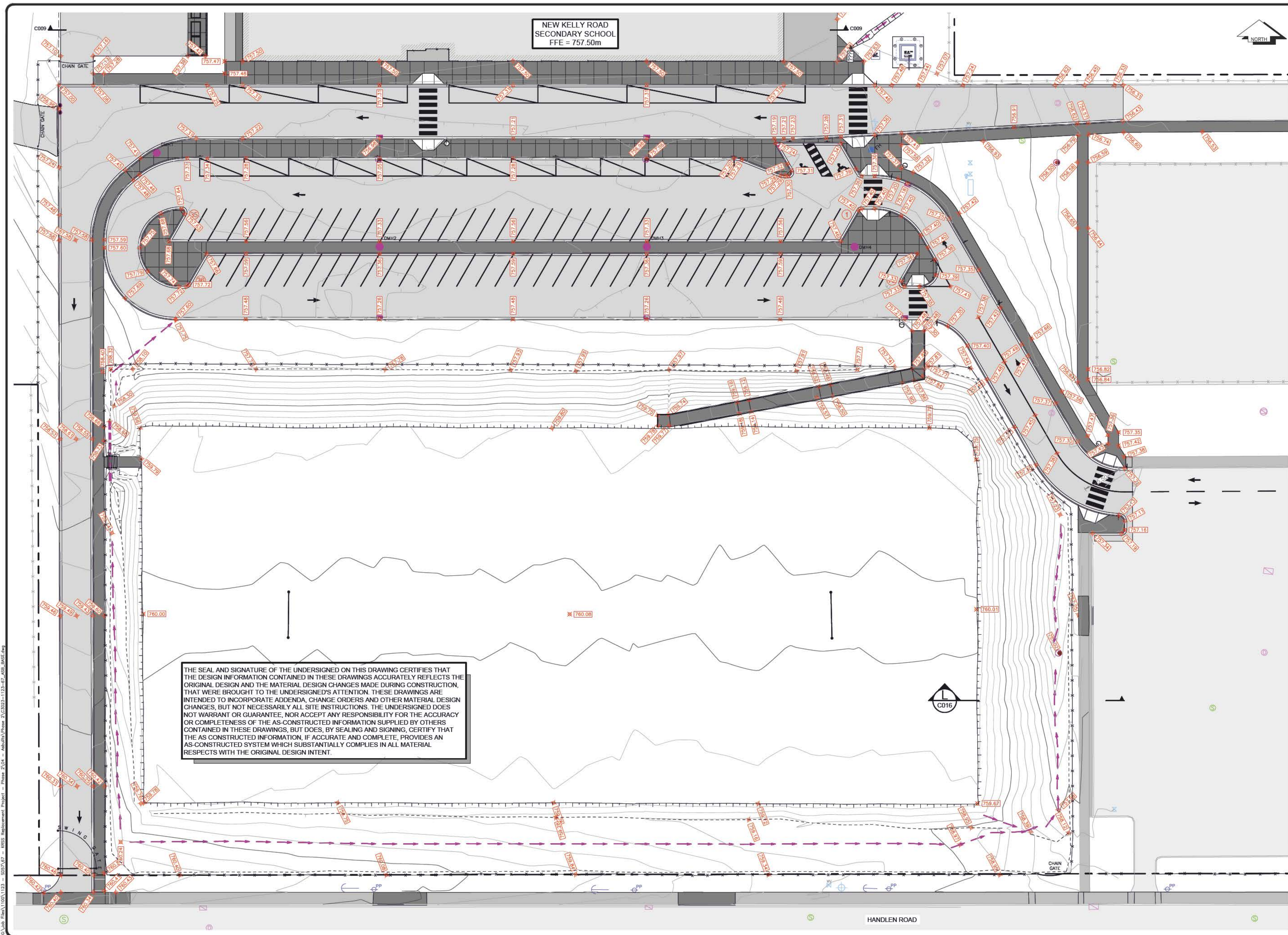

THIS DRAWING, AS AN INSTRUMENT OF SERVICE, IS THE PROPERTY OF L&M ENGINEERING LIMITED AND MAY NOT BE REPRODUCED WITHOUT WRITTEN PERMISSION OF SAME AND UNLESS THE REPRODUCTION CARRIES THEIR NAME. ALL DESIGNS AND OTHER INFORMATION SHOWN ON THIS DRAWING ARE FOR USE ON THE SPECIFIED PROJECT ONLY AND SHALL NOT BE USED OTHERWISE WITHOUT WRITTEN PERMISSION OF L&M ENGINEERING LIMITED.

A number line starting at 0 and ending at 18. There are tick marks at 0, 3, 6, 9, 12, 15, and 18. The line is divided into two equal parts by a tick mark at 9. The word "Meters" is written at the end of the line.

A horizontal number line with tick marks at 0, 9, and 18. The word "Meters" is written at the right end of the line.

THE SEAL AND SIGNATURE OF THE UNDERSIGNED ON THIS DRAWING CERTIFIES THAT THE DESIGN INFORMATION CONTAINED IN THESE DRAWINGS ACCURATELY REFLECTS THE ORIGINAL DESIGN AND THE MATERIAL DESIGN CHANGES MADE DURING CONSTRUCTION, THAT WERE BROUGHT TO THE UNDERSIGNED'S ATTENTION. THESE DRAWINGS ARE INTENDED TO INCORPORATE ADDENDA, CHANGE ORDERS AND OTHER MATERIAL DESIGN CHANGES, BUT NOT NECESSARILY ALL SITE INSTRUCTIONS. THE UNDERSIGNED DOES NOT WARRANT OR GUARANTEE, NOR ACCEPT ANY RESPONSIBILITY FOR THE ACCURACY OR COMPLETENESS OF THE AS-CONSTRUCTED INFORMATION SUPPLIED BY OTHERS CONTAINED IN THESE DRAWINGS, BUT DOES, BY SEALING AND SIGNING, CERTIFY THAT THE AS-CONSTRUCTED INFORMATION, IF ACCURATE AND COMPLETE, PROVIDES AN AS-CONSTRUCTED SYSTEM WHICH SUBSTANTIALLY COMPLIES IN ALL MATERIAL RESPECTS WITH THE ORIGINAL DESIGN INTENT.



GRADING PLAN - BUS LOOP EXIT
1:100

